

Lyneo® 0-10 Slider LSTV-F20B

To work with an occupancy sensor. Sensor not supplied by Lutron.



Control

Rated for 20 ballasts / 40 mA

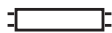

Important Notes

Please read before installing.

- CAUTION. LSTV requires external monostable relay to power the ballasts. DO NOT use LSTV to power the ballasts directly. Use only ballasts complying with IEC-60929.**
- Warning: shock hazard!** Turn power OFF at the MCB (circuit breaker) or fuse box before performing any routine maintenance, installation or servicing of lighting circuit. **Failure to turn OFF power could result in death or serious injury.**
- Protect dimmer from dust and dirt when painting or during construction.
- Do not exceed the maximum ratings (20 ballasts or 40 mA).**
- This dimmer complies with IEC and EN 60669-2-1.
- Minimum backbox depth is 35 mm.
- Install in accordance to all national and local electrical codes.
- Operate between 0 °C and 40 °C. For indoor use only.
- Clean with a soft damp cloth only. Do not use** chemical cleaners.
- To prevent damage to the dimmer, **test the fixture wiring using a switch**, prior to installing the dimmer.
- Recommended torque for terminal block screws is 0.8 N-m.

Technical Assistance

If you have questions concerning the installation or operation of this product, call Lutron's Headquarters. Please provide exact model number when calling.

Lutron EA LTD

Tel: +44.(0)20.7702.0657
Fax: +44.(0)20.7480.6899
www.lutron.com/europe

FREEPHONE:

U.K.: 0800.282.107
Spain: 900.974.452
France: 0800.90.12.18
Germany: 00800.5887.6635
Northern China: 10.800.712.1536
Southern China: 10.800.120.1536
Macau: 0800.401
Hong Kong: 800.901.849
Singapore: 800.120.4491
Taiwan: 00.801.137.737
Thailand: 001.800.120.665853
Indonesia: 001.803.011.3994

Lutron GL LTD

Tel: +65.6220.4666
Fax: +65.6220.4333
www.lutron.com/asia

Limited Warranty

Lutron EA Ltd. ("Lutron EA") warrants each unit to be free from defects in material and workmanship and to perform under normal use and service. To the extent permitted by law, Lutron EA and Lutron Electronics Co. Inc. ("Lutron") make no warranties or representations as to the units except as set forth herein. This warranty shall run for a period of two years from the date of purchase and Lutron's obligations under this warranty are limited to remedying any defect, replacing any defective part or replacement (at Lutron EA's sole option) and shall be effective only if the defective unit is shipped to Lutron EA postage prepaid within 24 months after purchase of the unit. Repair or replacement of the unit does not affect the expiry date of the warranty. This warranty does not cover damage or deficiencies due to abuse, misuse, inadequate wiring or insulation or use or installation other than in accordance with instructions accompanying the unit.

To the extent permitted by law, neither Lutron EA nor Lutron shall be liable for any other loss or damage including consequential or special loss or damages, loss of profits, loss of income, or loss of contracts arising out of or relating to the supply of the unit or the use of the unit and the purchaser assumes and will hold harmless Lutron EA and Lutron in respect of all such loss or damage. Nothing in this warranty shall have the effect of limiting or excluding Lutron EA's or Lutron's liability for fraud or for death or personal injury resulting from its own negligence, or any other liability, if and to the extent that the same may not be limited or excluded as a matter of law.

This warranty does not affect the statutory rights of consumer purchasers of this product.

Although every attempt is made to ensure that catalogue information is accurate and up-to-date, please check with Lutron EA before specifying or purchasing this equipment to confirm availability, exact specifications, and suitability for your application. These products may be covered under the following European design registration: 000315155-0001; and corresponding patents and design registrations of other countries. Patents pending.

The Sunburst logo, Lutron, and Lyneo are registered trademarks in the Community Trademark System. Lutron and the Sunburst logo are registered trademarks in the United Kingdom.

© 2009 Lutron Electronics Co., Inc.

Installation

- WARNING: Turn power OFF at MCB (circuit breaker) or fuse box. Failure to turn OFF power could result in death or serious injuries.**

2 Prepare dimmer for installation.



Snap off front plate
(Only on LSTV-F20B-F)

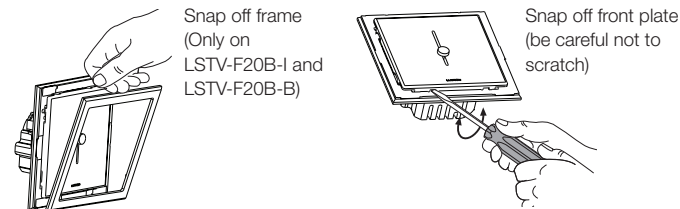

Snap off frame
(Only on LSTV-F20B-I and LSTV-F20B-B)

Snap off front plate
(be careful not to scratch)

3 Wiring the control.

IMPORTANT WIRING INFORMATION

CAUTION: Permanent damage can be caused by over tightening the terminal screws. Max Torque: 0.8 N-m

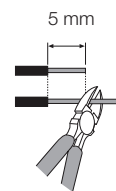

5 mm

Trim or strip backbox wires to 5 mm. Insert wires fully into the terminals and tighten screws.

Notes: Dimmer does not require an earth wire. Follow your national and local electrical codes to terminal the wire if this is present in the backbox.

CAUTION: DO NOT connect line voltage wires to the 0-10 terminals of the *Lyneo*. Permanent damage may occur. **Occupancy sensor shown as reference only. Refer to the sensor instruction sheet for wiring information.**

Reference wiring diagram

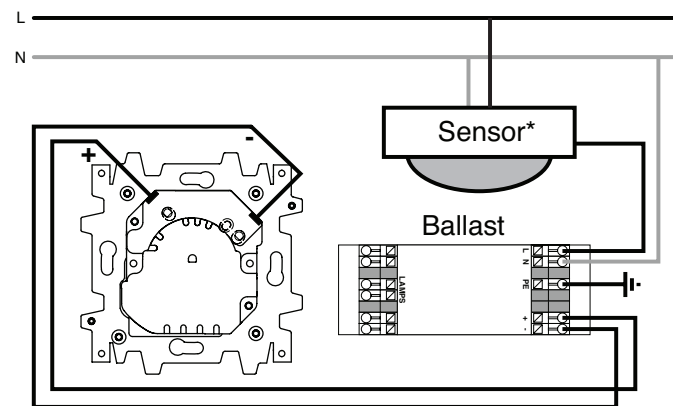

- Connect the wire connected to the + terminal on the ballast to the terminal labeled + on the *Lyneo* 0-10 slider.
 - Connect the wire connected to the - terminal on the ballast to the terminal labeled - on the *Lyneo* 0-10 slider.
 - Note: If your ballast does not have + and - signs, refer to the ballast specification sheet.
- *This could be also a switch or other device to switch mains voltage.

4 Mount and align the dimmer.

Note: Ensure the arrow on the dimmer is pointing up when installing

4a - Using the mounting claws. Do not overtighten mounting screws.

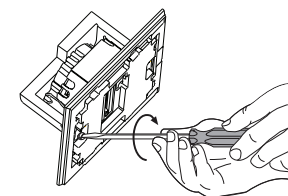

- Rotate each screw to secure dimmer to backbox.

CAUTION - Do not pinch wires.

4b - Using backbox screws. Do not over tighten mounting screws.

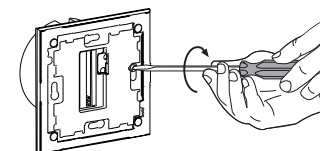

- Secure dimmer to the backbox

CAUTION - Do not pinch wires. Do not over tighten mounting screws.

5 Snap on the front plate.

5a - Only on LSTV-F20B-F

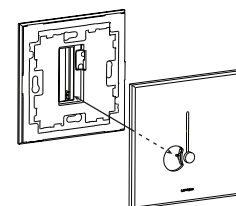

Important alignment step.

- On the dimmer, move the slider to its lowest travel position.
- On the front plate, move the knob to its lowest travel position.
- Note:** This ensures proper alignment of the knob and the slider.

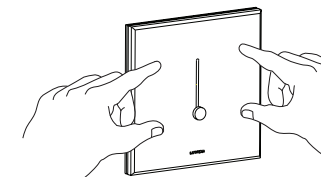

- Press corners to ensure six snaps are engaged.
- Move the knob up and down to ensure the knob and slider are properly aligned.

5b - Only on LSTV-F20B-I and LSTV-F20B-B

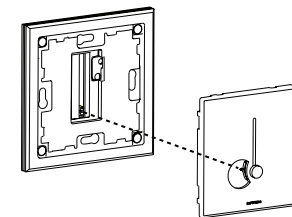

Important alignment step.

- On the dimmer, move the slider to its lowest travel position.
- On the front plate, move the knob to its lowest travel position.
- Note:** This ensures proper alignment of the knob and the slider.

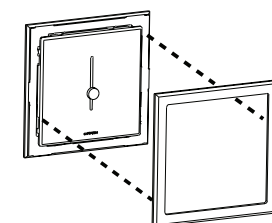

- Press corners to ensure six snaps are engaged.
- Move the knob up and down to ensure the knob and slider are properly aligned.

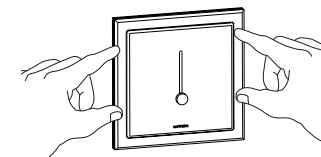

- Align pins on the frame with the holes on the dimmer. Press on all sides to ensure snaps are engaged. (Only on LSTV-F20B-I)

Operation

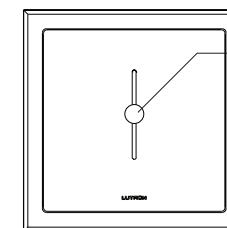

- Dimming Knob**
- Slide up to brighten
- Slide down to dim

- Restore power.
- Set slider to high end.
- If necessary, adjust dial to modify dimming characteristic (see note below).

Troubleshooting

- If the lights do not come on, please make sure your fluorescent lamps are not damaged.
- If the lights are stuck at low end, please make sure the 0-10 wires have not been miswired.
- If the lights are stuck at high end, please make sure that the 0-10 wires are connected to the dimmer and that the dimming characteristic has not been set to high end (see below).

Adjusting dimming characteristic.

The *Lyneo* 0-10 dimming output can be adjusted to match your own requirements. Adjusting the dimming characteristic allows for:

- Reducing the High End (for further energy savings). Turning the dial clockwise lowers the High End.
- Ballast compatibility (eliminate dead travel).
- CAUTION:** To avoid permanent damage, DO NOT press on or force the dial once it has reached its limits.

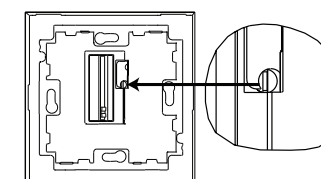

Use a small flat head screwdriver to turn the dial.