

Troubleshooting

Symptom	Possible Cause
Light does not turn on.	<ul style="list-style-type: none"> • Front Accessible Service Switch (FASS) on the dimmer is switched to the left (See Step 5). • Lamps burned out. • Breaker is off or tripped.
Infrared Wireless Remote Control does not operate the <i>Spacer System Dimmer</i> .	<ul style="list-style-type: none"> • Batteries are installed incorrectly. • Batteries are dead.
Lamps flicker when dimmed.	<ul style="list-style-type: none"> • Lamps not operated at 100 hours prior to dimming.

Worldwide Technical and Sales Assistance

If you have questions concerning the installation or operation of this product, call the **Lutron Technical Support Center**. Please provide exact model number when calling.

(800) 523-9466 (U.S.A., Canada, and the Caribbean)

Other countries call (610) 282-3800

Fax (610) 282-3090

Visit our web site at www.lutron.com

Warranty

Lutron will, at its option, repair or replace any unit that is defective in materials or manufacture within one year after purchase. For warranty service, return unit to place of purchase or mail to Lutron at 7200 Suter Rd., Coopersburg, PA 18036-1299, postage pre-paid.

This warranty is in lieu of all other warranties, express or implied, and the implied warranty of merchantability is limited to one year from purchase. This warranty does not cover the cost of installation, removal or reinstallation, or damage resulting from misuse, abuse, or damage from improper wiring or installation. This warranty does not cover incidental or consequential damages. This warranty gives you specific legal rights, and you may have other rights which vary from state to state. Some states do not allow the exclusion or limitation of incidental or consequential damages, or limitation on how long an implied warranty may last, so the above limitations may not apply to you.

This product is covered under one or more of the following U.S. patents: 5,248,919; 5,399,940; DES 353,798; DES 391,924 and corresponding foreign patents. U.S. and foreign patents pending. Lutron, Claro and Spacer are registered trademarks and FASS is a trademark of Lutron Electronics Co., Inc.

© 1999 Lutron Electronics Co., Inc.

Lutron Electronics Co., Inc.

7200 Suter Road
Coopersburg, PA 18036-1299, U.S.A.

Made and printed in the U.S.A. 10/99 P/N 030-617 Rev. A



Installation Instructions for Single-Location Control

Please Leave for Occupant

Read all instructions completely before installation.

Use Spacer System infrared hand-held remote controls (SPS-4IT, SPS-FSIT) for programming and recalling lighting scenes, remote dimming, and switching from the palm of your hand.

Important Notes

- 1. Caution:** To avoid overheating and possible damage to other equipment, do not use to control receptacles, motor-operated or transformer-supplied appliances.
- Install in accordance with all national and local electrical codes.
- Do not paint front or back of dimmer.
- Use only to control Lutron Tu-Wire™ fluorescent dimming ballasts.
- To ensure proper dimming performance and full lamp life, fluorescent lamps should be operated at full intensity for 100 hours prior to dimming.
- Operate between 0°C (32°F) and 40°C (104°F).
- Dimmer may feel warm to the touch during normal operation.
- For new installations, wire a test switch before installing the control.
- Recommended wallbox depth is 2 1/2" minimum.

For Lutron Tu-Wire™ Fluorescent Dimming Ballasts

SPSFTU-5A Tu-Wire™ Dimmer with IR Receiver

Rated at 120VAC, 60Hz, 5 Amp. maximum total current

Installation Note

Important: Dimmers used together to create scenes with a Spacer System wall mounted scene selector (SPS-5WC) must be installed in a single multigang wallbox with no dividers or barriers between dimmers. Individually mounted wallboxes are not acceptable. For scene programming and functions, refer to the instructions supplied with a Spacer System infrared hand-held remote control or wall mounted scene selector.

Multigang Installations

Lutron Claro wallplates are available in 1 to 6 gang versions. Purchase Claro multigang wallplates separately. When combining dimmers with other controls in the same wallbox, remove all inner side sections prior to wiring. Using pliers, bend side sections up and down until they break off.

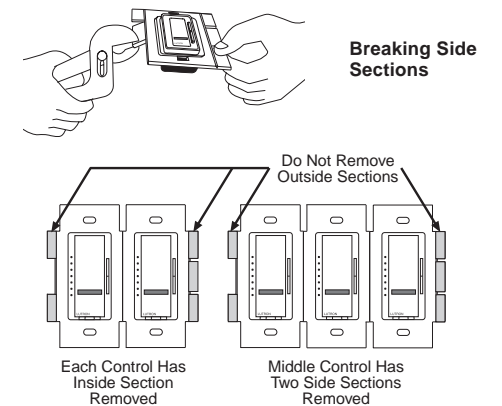

Reduction of the *Spacer System Dimmer* load capacity is required. See table below.

	No sides removed	1 side removed	2 sides removed
SPSFTU-5A	5 Amps	4 Amps	3.3 Amps

To determine total ballast load, add the line current found on the ballast label for all the ballasts in the circuit. This will indicate the total load for the dimmer.



"The Hand"™ Infrared Wireless Remote Control **will not** operate the *Spacer System Dimmers*. Use Spacer System infrared hand-held remote controls only (sold separately).

LUTRON®

LUTRON®

Single-Location Installation

For installations combining dimmers with other controls in a wallbox, refer to Multigang Installations on page 1 before beginning.

✓ **Check off Steps as completed.**

Step 1 Turn power off at circuit breaker panel or remove fuse from fusebox.

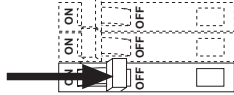

Step 2 Remove wallplate. Pull switch from wall.

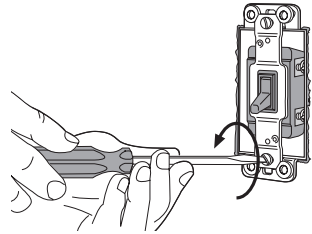
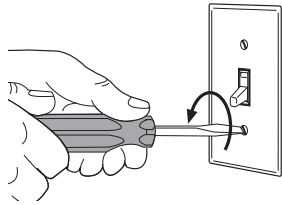

Step 3 Disconnect wires.

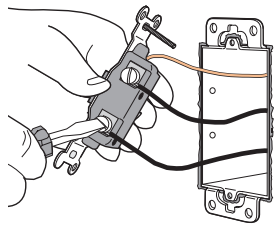

Terminal Screws:
Turn screw to loosen.

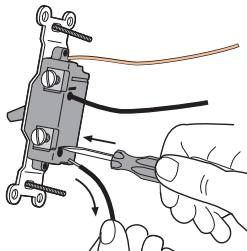

Backwired:
Insert screwdriver.
Pull out wire.

Important Wiring Information

Twist wires and trim.

3/8"

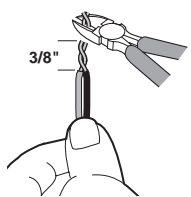

When making wire connections, twist and trim wires to the proper length as indicated below:

Strip length: 3/8" for 14, 16, or 18 gauge

Note: Wire connectors provided are suitable for copper wire only. For aluminum wire, consult an electrician. Use to join the following combinations:
One 14 gauge with one 16 or 18 gauge.

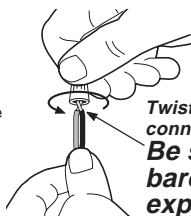

Twist wire connector tight. Be sure no bare wire is exposed.

Step 4 Wire the *Spacer System Dimmer*.

Using the wire connectors provided:

4a **Connect the ground wire:** Connect the *Spacer System Dimmer* green ground wire to the green or bare copper ground wire in the wallbox. If there is no ground wire in your wallbox, contact a licensed electrician.

4b **Connect the black wires:** Connect one *Spacer System Dimmer* black wire to either of the wires removed from the switch. Connect the other *Spacer System Dimmer* black wire to the remaining wire removed from the switch.

4c **Connect the white wire:** Connect the *Spacer System Dimmer* white wire to neutral.

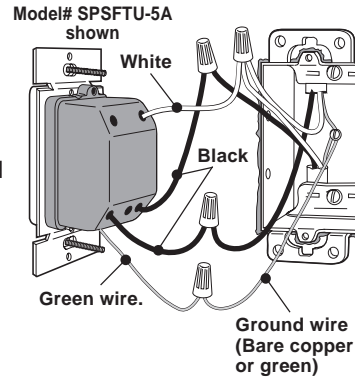

Wiring Diagram

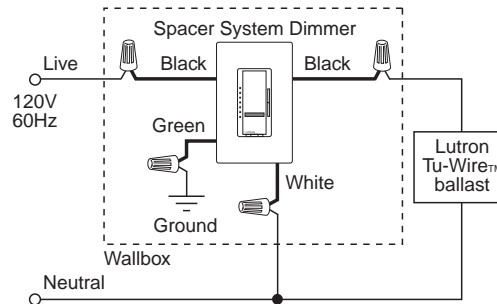

Step 5 Mount and align dimmer. Install Claro wallplate (sold separately).

Align dimmer.

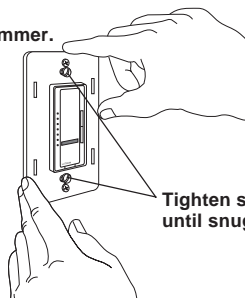

Tighten screws until snug.

Snap on wallplate.

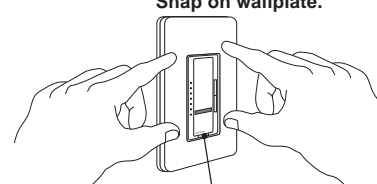

Slide FASS switch to the right.

Step 6 Turn power ON.

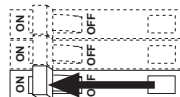

Operation of Spacer System Dimmer

Basic Operation

Tap once to turn On.

Tap again to turn Off.

Tap twice to turn On to full bright.

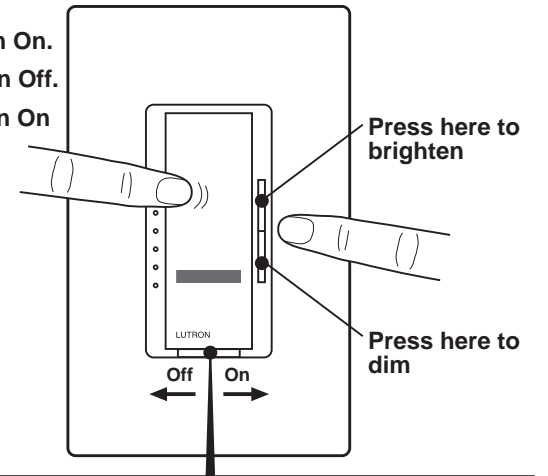

IMPORTANT NOTICE:

FASS™ - Front Accessible Service Switch - to replace bulb, power may be conveniently removed by sliding FASS switch to the left. For any procedure other than routine lamp replacement, power must be disconnected at the main electrical panel.

Power Failure Memory - Light(s) return to level prior to power failure.

Advanced Features

Fade to Off - Press and hold to activate delayed fade to Off. As tap switch is held, LEDs will begin to flash. Each flashing LED represents 10 seconds of delay before dimmer fades to Off (up to 60 seconds).

On Low - Press once to turn your lights On to lowest level when dimmer is Off.

LEDs - Indicate light level or glow softly as a night light when dimmer is Off.

