

1-Button Wallstation with Status LED

FOMX-1B-SL (with wallplate)
FOMX-1B-SLNW (without wallplate)

1-Button Wallstation

FOMX-1B (with wallplate)
FOMX-1B-NW (without wallplate)

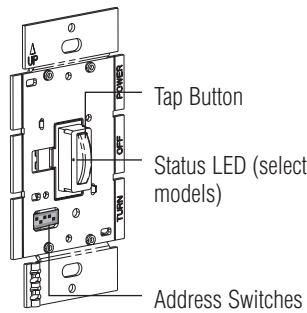

Important Notes

Please read before installing.

DANGER! Do not connect high-voltage power to low-voltage wire leads. Improper wiring can result in personal injury or damage to the control or to other equipment.

1. Read all instructions carefully before starting installation.
2. Lutron recommends that Wallstations be installed by a qualified electrician.
3. Wallstation fits in a standard wallplate with traditional-style opening.
4. Use only a cloth with warm water and mild soap to clean faceplates (no chemical cleaners).

Wiring

Control Link Wiring

- Power: Two #12 AWG (2.5 mm²) Class 2/PELV wires
- Data: Two shielded, #22 AWG (0.6 mm²) Class 2/PELV wires (twisted, shielded pair). Lutron offers a one-cable, non-plenum, low-voltage solution (Lutron P/N GRX-CBL-46L*), and a one-cable, plenum, low-voltage solution (Lutron P/N GRX-PCBL-46L*).

Wallstation Wiring

- Power: Two #18 AWG stranded Wires: 1 (black) & 2 (red).
- Data: Two #20 AWG Wires: 3 (white/black) & 4 (purple).

* Cable is available in 250 ft. (76 m) and 500 ft.(152 m) spools. Add (-250) or (-500) to the end of the P/N to specify the desired spool length.

Wiring Notes

- Connection of the Wallstation to the Control Link should be made inside the Wallstation's wallbox or in a junction box (provided by others) located no more than 8 ft. from control.
- Control Link wiring must **not** be run in the same raceway as line/mains voltage wiring.
- Total Control Link length is **not** to exceed 2000 ft. (610 m) unless the signal is boosted using a link booster (Lutron P/N MX-RPTR).
- The shield/drain wire must be maintained throughout the Control Link. Do **not** connect the shield to earth ground.
- Refer to the main processor Installation Guide and Lutron job drawings for power cable and data cable (Control Link) wiring restrictions and limitations.
- Control Link requires a link terminator (LT-1) at each end of the Control Link. Refer to the LT-1 instruction sheet for location and installation information.

Wallstation circuits are classified as Class 2 circuits (U.S.A.) and PELV circuits (IEC). Unless otherwise specified, the voltages do not exceed 12-35 VDC. As Class 2 circuits, they comply with the requirements of NFPA[®] 70, National Electrical Code[®] (NEC[®]). As PELV circuits, they comply with the requirements of IEC 60364-4-41, VDE 0100 Part 410, BS7671:1992 and other equivalent standards. When installing and wiring these Wallstations, follow all applicable national and/or local wiring regulations. External circuits connected to input, output, RS232, DMX512, and other communication terminals of Wallstations, must be supplied from a Listed Class 2 source or comply with the requirements for PELV circuits as applicable in your country.

Installation



Warning! Always turn Off the circuit breaker/MCB or remove the main fuse from the power line before doing any work. Failure to do so can result in serious personal injury.

- Prewiring: The Control Links require special wiring considerations. Refer to the Main Processor Installation Guide and Lutron job drawings for wiring restrictions and limitations that apply to your specific project.

1 Turn power Off. Turn power OFF at circuit breaker/MCB (or remove fuse).

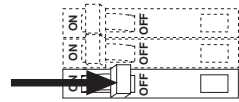

2 Mount Wallbox. Mount standard U.S. 1-gang wallbox, 2.75 in. (70 mm) deep (available from Lutron P/N 241-519).

3 Prepare Wallstations. For FOMX-1B-SL and FOMX-1B (units shipped with wallplates), remove the wallplate and adapter.

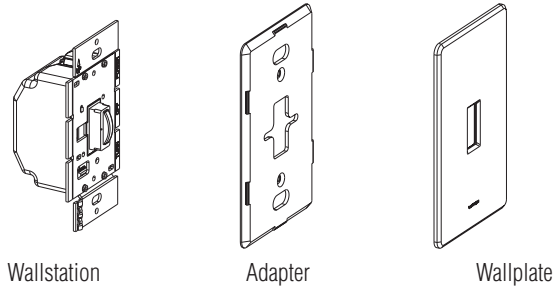

4 Multigang Installations. When combining controls in the same wallbox, remove all side sections prior to wiring. Using pliers, bend the side sections up and down until they break off. Repeat for each side section to be removed.

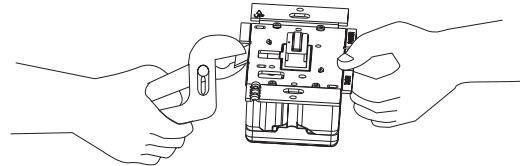

5 Address Wallstations. Address all Wallstations on the Control Link. Refer to Lutron job drawings for any preassigned job specific address for each control. For proper system operation, each Wallstation on a Control Link must have a unique address. For the maximum number of Wallstations per Control Link, please refer to the Main Processor Installation Guide.

For systems with up to 32 Wallstations per Control Link, set the Address Switches 1-5 to one of the positions (1-32) illustrated on the Address Reference Sheet included with this product. Record assignments in the "Location" column for future reference.

For systems with up to 64 Wallstations per Control Link, set the Address Switches 1-6 to one of the positions (1-64) illustrated on the Address Reference Sheet included with this product. Record assignments in the "Location" column for future reference.

6 Prepare Wires. Refer to the chart below for required wire strip lengths.

Wire	Strip Length
#12 AWG (2.5 mm ²)	1/2 in. (13 mm ²)
#18 AWG (1.0 mm ²)	1/2 in. (13 mm ²)
#20 AWG (0.8 mm ²)	3/8 in. (0.8 mm ²)
#22 AWG (0.6 mm ²)	3/8 in. (0.8 mm ²)

Wiring must be done in a daisy-chain configuration as shown, however, the order of the units is not important.

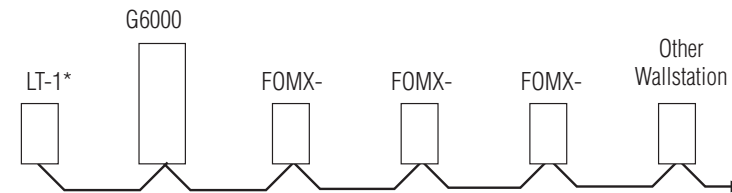

* Control Link requires a link terminator (LT-1) at each end of the Control Link. Refer to the LT-1 instruction sheet for location and installation information.

7 Wiring. Connections to the Control Link are as follows:

Power:

- 1 Black (Common)
- 2 Red (Power)

Data:

- 3 White/Black (MUX)
- 4 Purple (MUX)

Do not connect the Wallstation to Earth/Ground. Shielding (drain) must be connected as shown, but do not connect to Earth/Ground or Wallstation. The drain should be taped to avoid contact with Earth/Ground (wallbox).

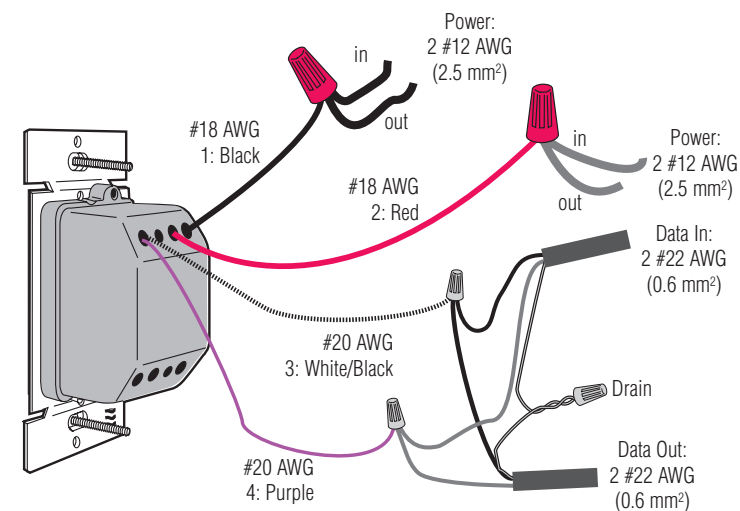

Note: Five wire connectors are shipped with the product. Use the two large red connectors for the power wiring, and the three small grey connectors for the data wiring.

8 Mount Wallstation. Form wires carefully into the wallbox, mount and align Wallstation, and install wallplate(s).

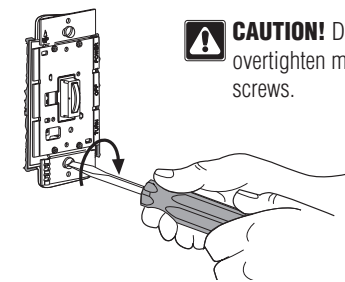

CAUTION! Do not overtighten mounting screws.

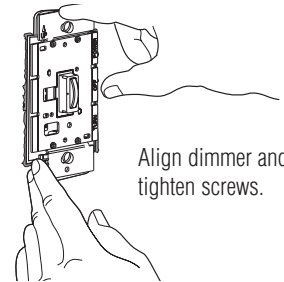

Align dimmer and tighten screws.

9 Turn power ON. Turn power ON at circuit breaker/MCB (or replace fuse).

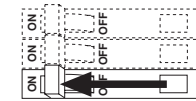

Troubleshooting

Problem

LED is blinking once every few seconds OR there is no system response when the tap button is pressed

Cause

Miswire or loose connection at Wallstation or Main Processor.
Wallstation is addressed incorrectly or another Wallstation shares the same address.
Wallstation is not in the G6000 database.
LT-1 not installed on ends of control link.

Internet: www.lutron.com
E-mail: product@lutron.com

WORLD HEADQUARTERS

Lutron Electronics Co. Inc.,
TOLL FREE: (800) 523-9466
(U.S.A., Canada, Caribbean)
Tel: (610) 282-3800;
International ++1- 610-282-3800
Fax: (610) 282-1243;
International ++1-610-282-1243

EUROPEAN HEADQUARTERS

Lutron EA Ltd.,
Tel: (171) 702-0657;
International ++44-(0)207-702-0657
Fax: (171) 480-6899;
International ++44-(0)207-480-6899

ASIAN HEADQUARTERS

ASIAN HEADQUARTERS
Lutron Asuka Co., Ltd. (Japan)
Tel: (03) 5575-8411;
International ++81-3-5575-8411
Fax: (03) 5575-8420;
International ++81-3-5575-8420

Lutron Electronics Co., Inc.
Made and printed in U.S.A.
P/N 030-817 Rev. A 7/03

LIMITED WARRANTY

Lutron will, at its option, repair or replace any unit that is defective in materials or manufacture within one year after purchase. For warranty service, return unit to place of purchase or mail to Lutron at 7200 Suter Rd., Coopersburg, PA 18036-1299, postage pre-paid.

This warranty is in lieu of all other express warranties, and the implied warranty of merchantability is limited to one year from purchase. This warranty does not cover the cost of installation, removal or reinstallation, or damage resulting from misuse, abuse, or improper or incorrect repair, or damage from improper wiring or installation. This warranty does not cover incidental or consequential damages. Lutron's liability on any claim for damages arising out of or in connection with the manufacture, sale, installation, delivery, or use of the unit shall never exceed the purchase price of the unit.

This warranty gives you specific legal rights, and you may also have other rights which vary from state to state. Some states do not allow limitations on how long an implied warranty lasts, so the above limitation may not apply to you. Some states do not allow the exclusion or limitation of incidental or consequential damages, so the above limitation or exclusion may not apply to you.

U.S. and foreign patents pending.
Lutron is a registered trademark of Lutron Electronics Co., Inc. NFPA, National Electrical Code, and NEC are registered trademarks of the National Fire Protection Association, Quincy, Massachusetts.
© 2003 Lutron Electronics Co., Inc.

LUTRON[®]

Address
Location

