

Preset Dimmer
Incandescent/Mains Voltage Halogen
LLSI-502, LNSI-502
Rated at: 220-240 V~ 50 Hz 40-500 W



Incandescent/Mains Voltage Halogen / Magnetic Low Voltage
LLSM-502
Rated at: 220-240 V~ 50 Hz 40-500 VA



Slide To Off Dimmer
Incandescent/Mains Voltage Halogen
LSSI-501
Rated at: 220-240 V~ 50 Hz 40-500 W



Important Notes

Please read before installing.

- WARNING:** Do not use LLSI-502, LNSI-502 or LSSI-501 with magnetic (core and coil) low-voltage transformers or electronic (solid-state) low-voltage transformers.
- Use LLSM-502 only with incandescent loads or magnetic low-voltage transformers with thermally fused primary. Magnetic low-voltage transformers must be fully loaded.
- CAUTION:** To avoid overheating and possible damage to other equipment, do not use to control receptacles, fluorescent lighting fixtures, motor-operated or transformer-supplied appliances.
- Turn power OFF at MCB (circuit breaker) or fuse box before performing any routine maintenance or servicing of lighting circuit.
- For new installations, install a test switch before installing the Dimmer to verify no short in the wiring.
- Protect Dimmer from dust and dirt when painting or during construction.
- Only one Dimmer can be used in a 2-way circuit.
- Dimmer requires a minimum total lamp wattage of 40 W. Do not exceed the maximum rating of 500 W.
- This Dimmer complies with IEC and EN 60669-2-1.
- Minimum backbox depth is 35 mm.**
- Install in accordance with all national and local electrical codes.
- Operate between 0 °C and 40 °C. For indoor use only.
- Dimmer may not work with dioded lamps.
- It is normal for the Dimmer to feel warm to the touch during operation.
- Clean with a soft damp cloth only. DO NOT** use any chemical cleaners.
- Recommended torque for terminal block screws is 0.5 N-m.

Technical Assistance

If you have questions concerning the installation or operation of this product, call **Lutron's Headquarters**. Please provide exact model number when calling.

Lutron EA LTD Tel: +44 (0) 207 702 0657 Fax: +44 (0) 207 480 6899 www.lutron.com/europe	FREEPHONE: U.K.: +0800-282107 Spain: +900-974452 Northern China: +10-800-712-1536 Southern China: +10-800-120-1536 Hong Kong: +800-901-849 Singapore: +800-120-4491 Taiwan: +00-801-137-737 Thailand: +001-800-120-665853
Lutron GL LTD Tel: +852-2104-7733 Fax: +852-2104-7633 www.lutron.com/asia	

Limited Warranty

Lutron EA Ltd. ("Lutron EA") warrants each unit to be free from defects in material and workmanship and to perform under normal use and service. To the extent permitted by law, Lutron EA and Lutron Electronics Co. Inc. ("Lutron") make no warranties or representations as to the units except as set forth herein. This warranty shall run for a period of two years from the date of purchase and Lutron's obligations under this warranty are limited to remedying any defect, replacing any defective part or replacement (at Lutron EA's sole option) and shall be effective only if the defective unit is shipped to Lutron EA postage prepaid within 24 months after purchase of the unit. Repair or replacement of the unit does not affect the expiry date of the warranty. This warranty does not cover damage or deficiencies due to abuse, misuse, inadequate wiring or insulation or use or installation other than in accordance with instructions accompanying the unit.

To the extent permitted by law, neither Lutron EA nor Lutron shall be liable for any other loss or damage including consequential or special loss or damages, loss of profits, loss of income, or loss of contracts arising out of or relating to the supply of the unit or the use of the unit and the purchaser assumes and will hold harmless Lutron EA and Lutron in respect of all such loss or damage. Nothing in this warranty shall have the effect of limiting or excluding Lutron EA's or Lutron's liability for fraud or for death or personal injury resulting from its own negligence, or any other liability, if and to the extent that the same may not be limited or excluded as a matter of law.

This warranty does not affect the statutory rights of consumer purchasers of this product. Although every attempt is made to ensure that catalogue information is accurate and up-to-date, please check with Lutron EA before specifying or purchasing this equipment to confirm availability, exact specifications, and suitability for your application. These products may be covered under the following European design registration: 000315155-0001; and corresponding patents and design registrations of other countries. Patents pending.

Lutron is a registered trademark in the United Kingdom and the Community Trademark System and Lyneo is a trademark of Lutron Electronics Co., Inc.
© 2006 Lutron Electronics Co., Inc.

Installation

1 **WARNING:** Turn power OFF at MCB (circuit breaker) or fuse box.

2 Remove switch mounting screws. Remove switch from wall.

Note: DO NOT disconnect wires from the switch.

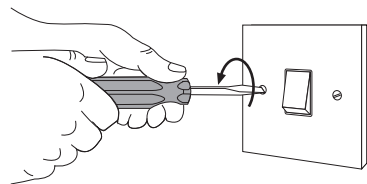
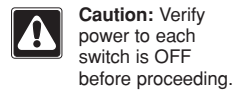

3 Tag the wire(s).

Single-Location control

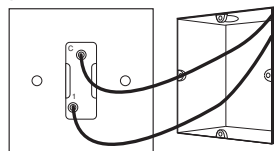

One switch controlling a light fixture.
No tagging is needed.
This switch will be a 1-way. The switch will have insulated wires connected to two terminals.

See Step 6a when wiring.

Two-Location control

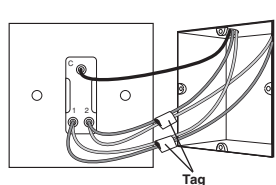

Two switches controlling a light fixture.
TAPE the two wires connected to the terminal labelled 1 together for identification during wiring.
TAPE the two wires connected to the terminal labelled 2 together.
Both switches will be 2-way. One switch will have five insulated wires connected to three terminals and the other switch will have three insulated wires connected to three terminals.
To replace a switch connected to three wires, see instructions on reverse.

See Step 6b when wiring.

Important Note:

Your wall switch may have two wires attached to the same terminal. Tape these two wires together before disconnecting. Connect these two wires to the same terminal in Step 6.

4 Disconnect switch wires.

5 Prepare Dimmer for installation.

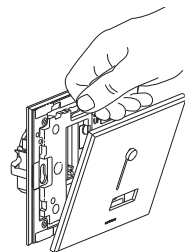

Snap on Front Plate

6 Wiring the control.

Important Wiring Information



WARNING: Permanent damage can be caused by overtightening the terminal screws.

Trim or strip backbox wires to 5 mm. Insert wires fully into the terminals and tighten screws.

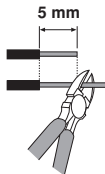

Notes: Dimmer does not require an earth wire. Follow your local and national wiring codes to terminate the earth wire in your backbox.

6a - Single-Location Wiring

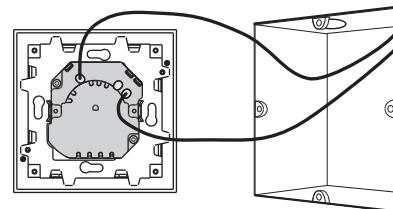

Reference Wiring Diagram

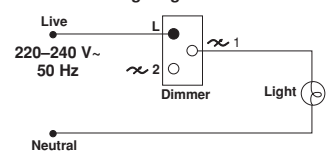

Models: LLSI-502, LNSI-502, LLSM-502, LSSI-501

- Connect one of the insulated wires removed from the switch to terminal L.
- Connect the other insulated wire removed from the switch to either of the \sim terminals.

Note: LSSI-501 only has 2 terminals.

OR

6b - Two-Location Wiring, Three Wire Control

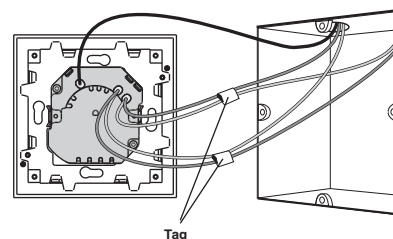

Reference Wiring Diagram

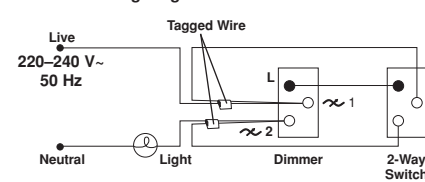

Models: LLSI-502, LNSI-502, LLSM-502

Note: Only one dimmer can be used in a 2-way circuit.

- Connect one pair of Tagged wires removed from the switch to either \sim terminal.
- Connect the remaining pair of Tagged wires removed from the switch to the remaining \sim terminal
- Connect the remaining wire removed from the switch to terminal L.

Note: Dimmer can be wired on the line or load side.

7 Mount and align Dimmer.

Note: Ensure the arrow on the Dimmer is facing UP when installing.

7a - Using the Mounting Claws

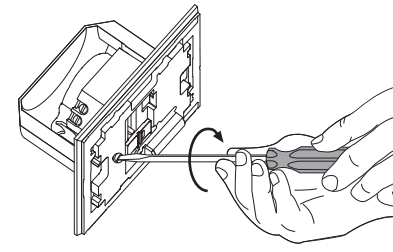

- Rotate each screw 1-2 turns to secure Dimmer to backbox.

Caution - Do not pinch wires.

OR

7b - Using Backbox Screws

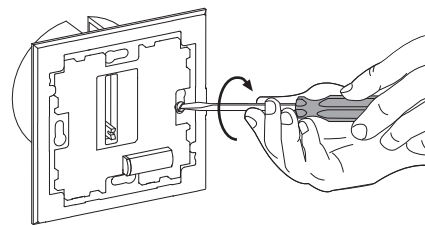

- Claws may be removed.
- Secure Dimmer to the backbox.

Caution - Do not pinch wires. Do not overtighten mounting screws.

8 Snap on Front Plate.



Important Alignment Step

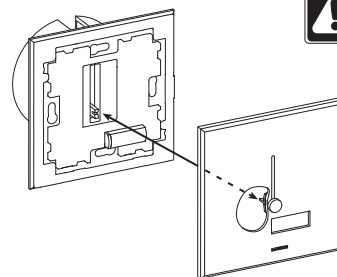

- On the Dimmer, move the slider to the lowest travel position.
- On the Front Plate, move the knob to the lowest travel position.

Note: This ensures proper alignment of the knob and slider.

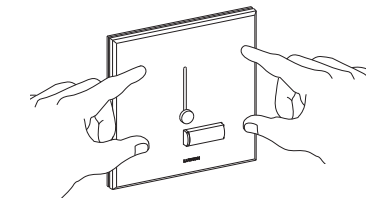

- Press corners to ensure four snaps engaged.
- Move the knob up and down to confirm the knob and slider are properly aligned.

9 Turn power ON at MCB (circuit breaker) or fuse box.

Operation

Models: LLSI-502
LNSI-502
LLSM-502

Dimming Knob
• Slide up to brighten.
• Slide down to dim.

Status Light
• Bright when lights are ON.
• Dim when lights are OFF.
• LLSI and LLSM models only.

Model: LSSI-501

Dimming Knob
• Slide up to brighten.
• Slide down to dim.
• Click at bottom to turn OFF.

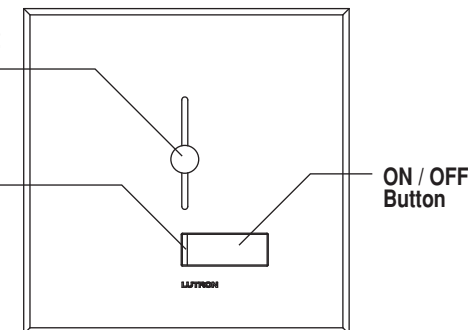

ON / OFF Button

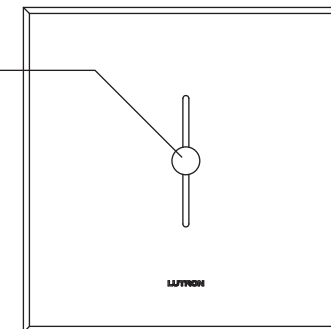

Problems

If your Dimmer does not work, check that the light bulb has not burned out before contacting Lutron Technical Assistance.

Preset Dimmer

Incandescent/Mains Voltage Halogen
LLSI-502, LNSI-502

Rated at: 220-240 V~ 50 Hz 40-500 W



Incandescent/Mains Voltage Halogen / Magnetic Low Voltage
LLSM-502

Rated at: 220-240 V~ 50 Hz 40-500 VA



Slide To Off Dimmer

Incandescent/Mains Voltage Halogen
LSSI-501

Rated at: 220-240 V~ 50 Hz 40-500 W



Important Notes

Please read before installing.

- WARNING:** Do not use LLSI-502, LNSI-502 or LSSI-501 with magnetic (core and coil) low-voltage transformers or electronic (solid-state) low-voltage transformers.
- Use LLSM-502 only with incandescent loads or magnetic low-voltage transformers with thermally fused primary. Magnetic low-voltage transformers must be fully loaded.
- CAUTION:** To avoid overheating and possible damage to other equipment, do not use to control receptacles, fluorescent lighting fixtures, motor-operated or transformer-supplied appliances.
- Turn power OFF at MCB (circuit breaker) or fuse box before performing any routine maintenance or servicing of lighting circuit.
- For new installations, install a test switch before installing the Dimmer to verify no short in the wiring.
- Protect Dimmer from dust and dirt when painting or during construction.
- Only one Dimmer can be used in a 2-way circuit.
- Dimmer requires a minimum total lamp wattage of 40 W. Do not exceed the maximum rating of 500 W.
- This Dimmer complies with IEC and EN 60669-2-1.
- Minimum backbox depth is 35 mm.**
- Install in accordance with all national and local electrical codes.
- Operate between 0 °C and 40 °C. For indoor use only.
- Dimmer may not work with dioded lamps.
- It is normal for the Dimmer to feel warm to the touch during operation.
- Clean with a soft damp cloth only. DO NOT** use any chemical cleaners.
- Recommended torque for terminal block screws is 0.5 N-m.

Technical Assistance

If you have questions concerning the installation or operation of this product, call **Lutron's Headquarters**. Please provide exact model number when calling.

Lutron EA LTD

Tel: +44 (0) 207 702 0657
Fax: +44 (0) 207 480 6899
www.lutron.com/europe

FREEPHONE:

U.K.: +0800-282107
Spain: +900-974452
Northern China: +10-800-712-1536
Southern China: +10-800-120-1536

Lutron GL LTD

Tel: +852-2104-7733
Fax: +852-2104-7633
www.lutron.com/asia

Hong Kong: +800-901-849
Singapore: +800-120-4491
Taiwan: +00-801-137-737
Thailand: +001-800-120-665853

Limited Warranty

Lutron EA Ltd. ("Lutron EA") warrants each unit to be free from defects in material and workmanship and to perform under normal use and service. To the extent permitted by law, Lutron EA and Lutron Electronics Co. Inc. ("Lutron") make no warranties or representations as to the units except as set forth herein. This warranty shall run for a period of two years from the date of purchase and Lutron's obligations under this warranty are limited to remedying any defect, replacing any defective part or replacement (at Lutron EA's sole option) and shall be effective only if the defective unit is shipped to Lutron EA postage prepaid within 24 months after purchase of the unit. Repair or replacement of the unit does not affect the expiry date of the warranty. This warranty does not cover damage or deficiencies due to abuse, misuse, inadequate wiring or insulation or use or installation other than in accordance with instructions accompanying the unit.

To the extent permitted by law, neither Lutron EA nor Lutron shall be liable for any other loss or damage including consequential or special loss or damages, loss of profits, loss of income, or loss of contracts arising out of or relating to the supply of the unit or the use of the unit and the purchaser assumes and will hold harmless Lutron EA and Lutron in respect of all such loss or damage. Nothing in this warranty shall have the effect of limiting or excluding Lutron EA's or Lutron's liability for fraud or for death or personal injury resulting from its own negligence, or any other liability, if and to the extent that the same may not be limited or excluded as a matter of law.

This warranty does not affect the statutory rights of consumer purchasers of this product. Although every attempt is made to ensure that catalogue information is accurate and up-to-date, please check with Lutron EA before specifying or purchasing this equipment to confirm availability, exact specifications, and suitability for your application. These products may be covered under the following European design registration: 000315155-0001; and corresponding patents and design registrations of other countries. Patents pending.

Lutron is a registered trademark in the United Kingdom and the Community Trademark System and Lyneo is a trademark of Lutron Electronics Co., Inc.
© 2006 Lutron Electronics Co., Inc.

Installation

- 1** **WARNING:** Turn power OFF at MCB (circuit breaker) or fuse box.

- 2** Remove switch mounting screws. Remove switch from wall.

Note: DO NOT disconnect wires from the switch.

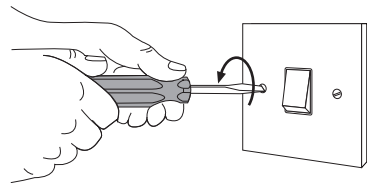
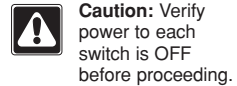

- 3** Tag the wire(s).

Single-Location control

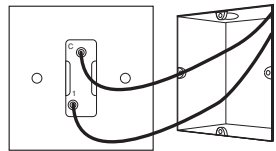

One switch controlling a light fixture.
No tagging is needed.
This switch will be a 1-way. The switch will have insulated wires connected to two terminals.

See Step 6a when wiring.

Two-Location control

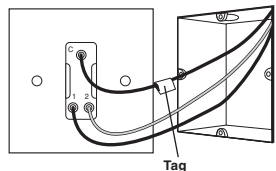

Two switches controlling a light fixture.
TAG the wire connected to the terminal labelled C or COMMON for identification during wiring. Both switches will be 2-way. Each switch will have insulated wires connected to three terminals. To replace a switch connected to five wires, see instructions on reverse.

See Step 6b when wiring.

Important Note:

Your wall switch may have two wires attached to the same terminal. Tape these two wires together before disconnecting. Connect these two wires to the same terminal in Step 6.

- 4** Disconnect switch wires.

- 5** Prepare Dimmer for installation.

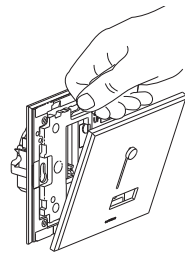

Snap off Front Plate

- 6** Wiring the control.

Important Wiring Information



WARNING: Permanent damage can be caused by overtightening the terminal screws.

Trim or strip backbox wires to 5 mm. Insert wires fully into the terminals and tighten screws.

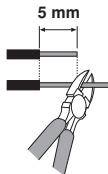

Notes: Dimmer does not require an earth wire. Follow your local and national wiring codes to terminate the earth wire in your backbox.

6a - Single-Location Wiring

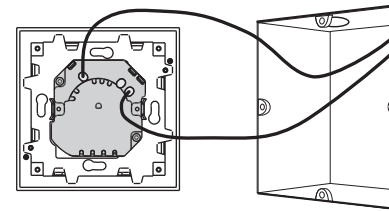

Reference Wiring Diagram

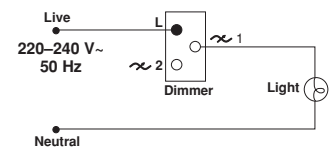

Models: LLSI-502, LNSI-502, LLSM-502, LSSI-501

- Connect one of the insulated wires removed from the switch to terminal L.
- Connect the other insulated wire removed from the switch to either of the \sim terminals.

Note: LSSI-501 only has 2 terminals.

OR

6b - Two-Location Wiring, Two Wire Control

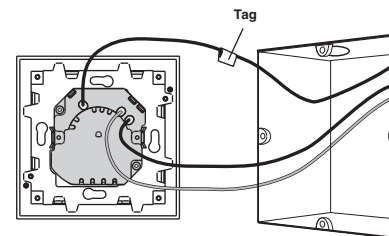

Reference Wiring Diagram

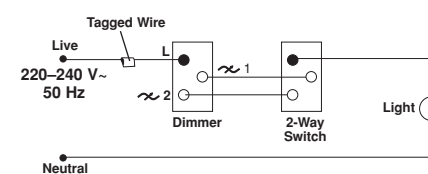

Models: LLSI-502, LNSI-502, LLSM-502

Note: Only one dimmer can be used in a 2-way circuit.

- Connect the Tagged wire removed from the switch to terminal L.
- Connect one of the remaining wires removed from the switch to either \sim terminal.
- Connect the remaining wire removed from the switch to the remaining \sim terminal.

Note: Dimmer can be wired on the line or load side.

- 7** Mount and align Dimmer.

Note: Ensure the arrow on the Dimmer is facing UP when installing.

7a - Using the Mounting Claws

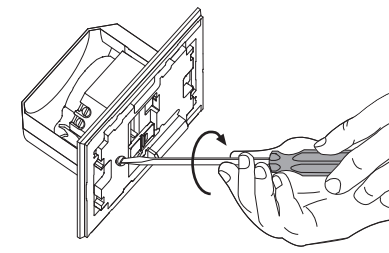

- Rotate each screw 1-2 turns to secure Dimmer to backbox.

Caution - Do not pinch wires.

OR

7b - Using Backbox Screws

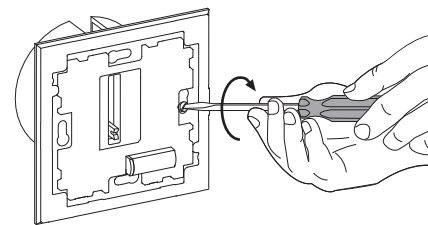

- Claws may be removed.
- Secure Dimmer to the backbox.

Caution - Do not pinch wires. Do not overtighten mounting screws.

- 8** Snap on Front Plate.



Important Alignment Step

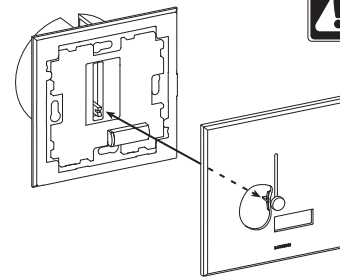

- On the Dimmer, move the slider to the lowest travel position.
- On the Front Plate, move the knob to the lowest travel position.

Note: This ensures proper alignment of the knob and slider.

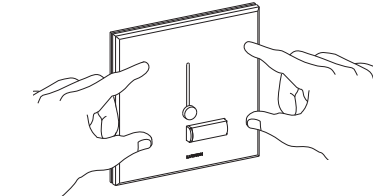

- Press corners to ensure four snaps engaged.
- Move the knob up and down to confirm the knob and slider are properly aligned.

- 9** Turn power ON at MCB (circuit breaker) or fuse box.

Operation

Models: LLSI-502
LNSI-502
LLSM-502

Dimming Knob

- Slide up to brighten.
- Slide down to dim.

Status Light

- Bright when lights are ON.
- Dim when lights are OFF.
- LLSI and LLSM models only.

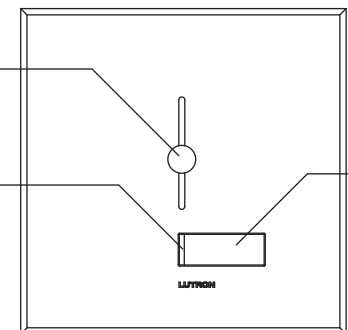

ON / OFF Button

Model: LSSI-501

Dimming Knob

- Slide up to brighten.
- Slide down to dim.
- Click at bottom to turn OFF.

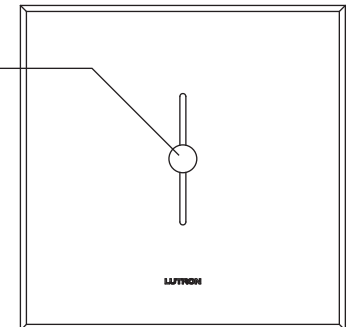

Problems

If your Dimmer does not work, check that the light bulb has not burned out before contacting Lutron Technical Assistance.