

## Single 2-way Switch

RN-SS10

Rated at: 250 V~ 10 AX



## Dual 2-way Switch

RN-DS10

Rated at: 250 V~ 10 AX



### Compatible load types:

Incandescent, Mains Voltage Halogen, Magnetic, Electronic Low-Voltage, and Fluorescent



### Important Notes

#### Please read before installing.

1. Turn power OFF at MCB (circuit breaker) or fuse box before performing any routine maintenance or servicing of lighting circuit.
2. Protect Switch from dust and dirt when painting or during construction.
3. Do not exceed the maximum rating of 10 AX.
4. This Switch complies with IEC and EN 60669-1.
5. **Recommended backbox depth is 35 mm.**
6. Install in accordance with all national and local electrical codes.
7. Operate between 0 °C and 40 °C. For indoor use only.
8. **Clean with a soft damp cloth only. DO NOT** use any chemical cleaners.
9. Recommended torque for terminal block screws is 0,8 N·m.

### Technical Assistance

If you have questions concerning the installation or operation of this product, call **Lutron's Headquarters**. Please provide exact model number when calling.

#### Lutron EA LTD

Tel: +44 (0) 207 702 0657  
Fax: +44 (0) 207 480 6899  
www.lutron.com/europe

#### FREEPHONE:

U.K.: 0800-282107  
Spain: 900-974452  
Northern China: 10-800-712-1536  
Southern China: 10-800-120-1536  
Macau: 0800-401  
Hong Kong: 800-901-849  
Singapore: 800-120-4491  
Taiwan: 00-801-137-737  
Thailand: 001-800-120-665853  
Indonesia: 001-803-011-3994

### Limited Warranty

Lutron EA Ltd. ("Lutron EA") warrants each unit to be free from defects in material and workmanship and to perform under normal use and service. To the extent permitted by law, Lutron EA and Lutron Electronics Co., Inc. ("Lutron") make no warranties or representations as to the units except as set forth herein. This warranty shall run for a period of two years from the date of purchase and Lutron's obligations under this warranty are limited to remedying any defect, replacing any defective part or replacement (at Lutron EA's sole option) and shall be effective only if the defective unit is shipped to Lutron EA postage prepaid within 24 months after purchase of the unit. Repair or replacement of the unit does not affect the expiry date of the warranty. This warranty does not cover damage or deficiencies due to abuse, misuse, inadequate wiring or insulation or use or installation other than in accordance with instructions accompanying the unit.

To the extent permitted by law, neither Lutron EA nor Lutron shall be liable for any other loss or damage including consequential or special loss or damages, loss of profits, loss of income, or loss of contracts arising out of or relating to the supply of the unit or the use of the unit and the purchaser assumes and will hold harmless Lutron EA and Lutron in respect of all such loss or damage. Nothing in this warranty shall have the effect of limiting or excluding Lutron EA's or Lutron's liability for fraud or for death or personal injury resulting from its own negligence, or any other liability, if and to the extent that the same may not be limited or excluded as a matter of law.

**This warranty does not affect the statutory rights of consumer purchasers of this product.**

Although every attempt is made to ensure that catalogue information is accurate and up-to-date, please check with Lutron EA before specifying or purchasing this equipment to confirm availability, exact specifications, and suitability for your application. Patents pending.

Lutron is a registered trademark in the United Kingdom and the Community Trademark System and Rania is a registered trademark of Lutron Electronics Co., Inc.

© 2006 Lutron Electronics Co., Inc.

## Installation

- 1** **WARNING:** Turn power OFF at MCB (circuit breaker) or fuse box.

- 2** Remove switch mounting screws. Remove existing switch from wall.  
**Note:** DO NOT disconnect wires from the switch.

**Caution:** Verify power to each switch is OFF before proceeding.

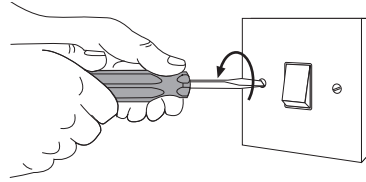

- 3** Tag the wire(s).  
**Note:** If replacing an existing **dual switch**, perform one of the following procedures on each switch.

#### Single-Location control

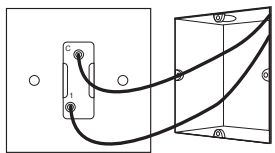

**One switch controlling a light fixture.**  
No tagging is needed.  
This switch will be a 1-way. The switch will have insulated wires connected to two terminals.  
**See Step 6a when wiring.**

#### Two-Location control

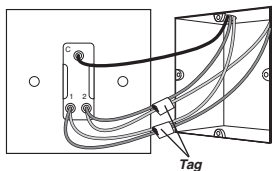

**Two switches controlling a light fixture.**  
**TAPE** the two wires connected to the terminal labelled 1 together for identification during wiring.  
**TAPE** the two wires connected to the terminal labelled 2 together.  
Both switches will be 2-way. One switch will have five insulated wires connected to three terminals and the other switch will have three insulated wires connected to three terminals.  
To replace a switch connected to three wires, see instructions on reverse.  
**See Step 6b when wiring.**

#### Important Note:

Your wall switch may have two wires attached to the same terminal. Tape these two wires together before disconnecting. Connect these two wires to the same terminal in Step 6.

- 4** Disconnect switch wires.

- 5** Prepare Switch for installation.

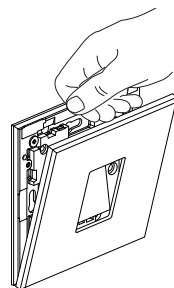

Snap off Front Plate

## Important Wiring Information



**WARNING:** Permanent damage can be caused by overtightening the terminal screws. Recommended torque for terminal block screws is 0,8 N·m.

Trim or strip backbox wires to 10 mm. Insert wires fully into the terminals and tighten screws.

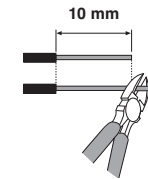

- 6** Wiring the Switch.

- Notes:**
- Switch does not require an earth wire. Follow your local and national wiring codes to terminate the earth wire in your backbox.
  - For the **RN-DS10**, perform one of the following wiring procedures on each switch.

### 6a - Single-Location Wiring

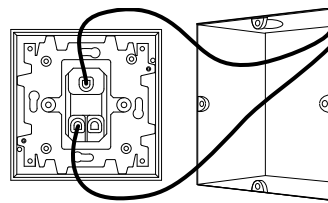

- Connect one of the insulated wires removed from the switch to terminal 0.
- Connect the other insulated wire removed from the switch to terminal 1.

#### Reference Wiring Diagram

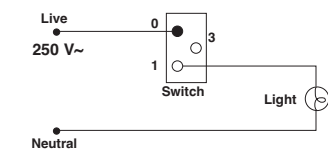

OR

### 6b - Two-Location Wiring, Three Wire Control

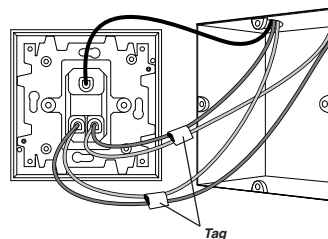

- Connect one pair of Tagged wires removed from the switch to terminal 1.
- Connect the remaining pair of Tagged wires removed from the switch to terminal 3.
- Connect the remaining wire removed from the switch to terminal 0.

#### Reference Wiring Diagram

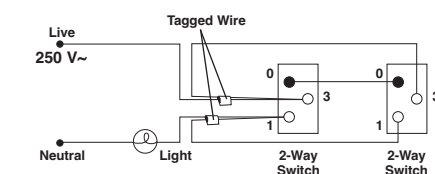

- 7** Mount and align Switch.

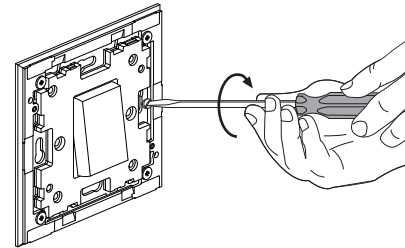

- Secure Switch to the backbox.

**Caution - Do not pinch wires. Do not overtighten mounting screws.**

- 8** Snap on Front Plate.

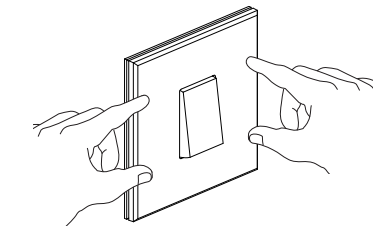

- Press corners to ensure four snaps engaged.

- 9** Turn power ON at MCB (circuit breaker) or fuse box.

### Problems

If your Switch does not work, check that the light bulb has not burned out before contacting Lutron Technical Assistance.

## Single 2-way Switch

RN-SS10  
Rated at: 250 V~ 10 AX



## Dual 2-way Switch

RN-DS10  
Rated at: 250 V~ 10 AX



### Compatible load types:

Incandescent, Mains Voltage Halogen, Magnetic, Electronic Low-Voltage, and Fluorescent



### Important Notes

#### Please read before installing.

1. Turn power OFF at MCB (circuit breaker) or fuse box before performing any routine maintenance or servicing of lighting circuit.
2. Protect Switch from dust and dirt when painting or during construction.
3. Do not exceed the maximum rating of 10 AX.
4. This Switch complies with IEC and EN 60669-1.
5. **Recommended backbox depth is 35 mm.**
6. Install in accordance with all national and local electrical codes.
7. Operate between 0 °C and 40 °C. For indoor use only.
8. **Clean with a soft damp cloth only. DO NOT** use any chemical cleaners.
9. Recommended torque for terminal block screws is 0,8 N·m.

### Technical Assistance

If you have questions concerning the installation or operation of this product, call **Lutron's Headquarters**. Please provide exact model number when calling.

**Lutron EA LTD**  
Tel: +44 (0) 207 702 0657  
Fax: +44 (0) 207 480 6899  
www.lutron.com/europe

**FREEPHONE:**  
U.K.: 0800-282107  
Spain: 900-974452  
Northern China: 10-800-712-1536  
Southern China: 10-800-120-1536  
Macau: 0800-401  
Hong Kong: 800-901-849  
Singapore: 800-120-4491  
Taiwan: 00-801-137-737  
Thailand: 001-800-120-665853  
Indonesia: 001-803-011-3994

### Limited Warranty

Lutron EA Ltd. ("Lutron EA") warrants each unit to be free from defects in material and workmanship and to perform under normal use and service. To the extent permitted by law, Lutron EA and Lutron Electronics Co., Inc. ("Lutron") make no warranties or representations as to the units except as set forth herein. This warranty shall run for a period of two years from the date of purchase and Lutron's obligations under this warranty are limited to remedying any defect, replacing any defective part or replacement (at Lutron EA's sole option) and shall be effective only if the defective unit is shipped to Lutron EA postage prepaid within 24 months after purchase of the unit. Repair or replacement of the unit does not affect the expiry date of the warranty. This warranty does not cover damage or deficiencies due to abuse, misuse, inadequate wiring or insulation or use or installation other than in accordance with instructions accompanying the unit.

To the extent permitted by law, neither Lutron EA nor Lutron shall be liable for any other loss or damage including consequential or special loss or damages, loss of profits, loss of income, or loss of contracts arising out of or relating to the supply of the unit or the use of the unit and the purchaser assumes and will hold harmless Lutron EA and Lutron in respect of all such loss or damage. Nothing in this warranty shall have the effect of limiting or excluding Lutron EA's or Lutron's liability for fraud or for death or personal injury resulting from its own negligence, or any other liability, if and to the extent that the same may not be limited or excluded as a matter of law.

**This warranty does not affect the statutory rights of consumer purchasers of this product.**

Although every attempt is made to ensure that catalogue information is accurate and up-to-date, please check with Lutron EA before specifying or purchasing this equipment to confirm availability, exact specifications, and suitability for your application. Patents pending.

Lutron is a registered trademark in the United Kingdom and the Community Trademark System and Rania is a registered trademark of Lutron Electronics Co., Inc.  
© 2006 Lutron Electronics Co., Inc.

## Installation

**1** **WARNING:** Turn power OFF at MCB (circuit breaker) or fuse box.

**2** Remove switch mounting screws. Remove existing switch from wall.  
**Note:** DO NOT disconnect wires from the switch.

**Caution:** Verify power to each switch is OFF before proceeding.

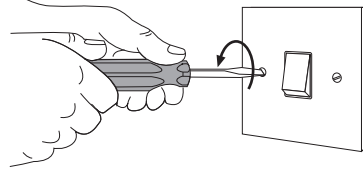

**3** Tag the wire(s).  
**Note:** If replacing an existing **dual switch**, perform one of the following procedures on each switch.

### Single-Location control

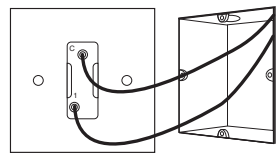

**One switch controlling a light fixture.**  
No tagging is needed.  
This switch will be a 1-way. The switch will have insulated wires connected to two terminals.  
**See Step 6a when wiring.**

### Two-Location control

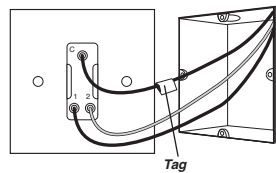

**Two switches controlling a light fixture.**  
**TAG** the wire connected to the terminal labelled C or COMMON for identification during wiring. Both switches will be 2-way. Each switch will have insulated wires connected to three terminals.  
To replace a switch connected to five wires, see instructions on reverse.  
**See Step 6b when wiring.**

### Important Note:

Your wall switch may have two wires attached to the same terminal. Tape these two wires together before disconnecting. Connect these two wires to the same terminal in Step 6.

**4** Disconnect switch wires.

**5** Prepare Switch for installation.

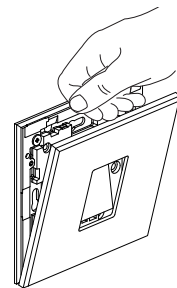

Snap off Front Plate

## Important Wiring Information



**WARNING:** Permanent damage can be caused by overtightening the terminal screws. Recommended torque for terminal block screws is 0,8 N·m.

Trim or strip backbox wires to 10 mm. Insert wires fully into the terminals and tighten screws.

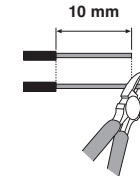

**6** Wiring the Switch.

- Notes:**
- Switch does not require an earth wire. Follow your local and national wiring codes to terminate the earth wire in your backbox.
  - For the **RN-DS10**, perform one of the following wiring procedures on each switch.

### 6a - Single-Location Wiring

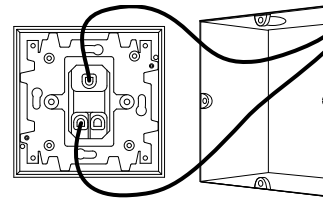

- Connect one of the insulated wires removed from the switch to terminal 0.
- Connect the other insulated wire removed from the switch to terminal 1.

### Reference Wiring Diagram

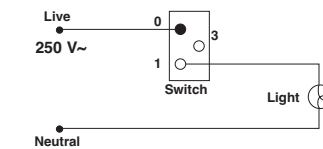

OR

### 6b - Two-Location Wiring, Two Wire Control

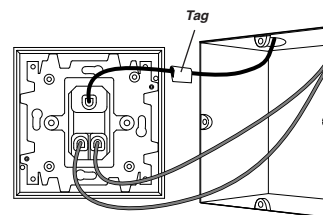

- Connect the Tagged wire removed from the switch to terminal 0.
- Connect one of the remaining wires removed from the switch to terminal 1.
- Connect the remaining wire removed from the switch to terminal 3.

### Reference Wiring Diagram

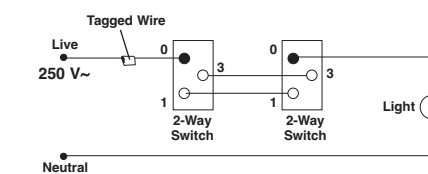

**7** Mount and align Switch.

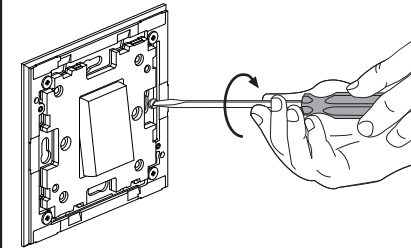

- Secure Switch to the backbox.

**Caution - Do not pinch wires. Do not overtighten mounting screws.**

**8** Snap on Front Plate.

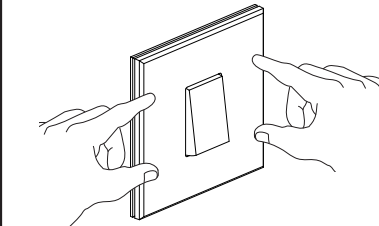

- Press corners to ensure four snaps engaged.

**9** Turn power ON at MCB (circuit breaker) or fuse box.

### Problems

If your Switch does not work, check that the light bulb has not burned out before contacting Lutron Technical Assistance.