

10 mm Trim Ring

RN-TRRG

Please read before installing.

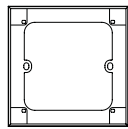

Installation

1. Turn power OFF at MCB (circuit breaker) or remove fuse.
2. Prepare dimmer for installation using trim ring.

Remove the front plate.

OR

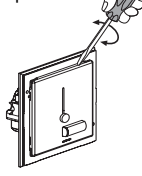
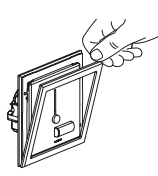
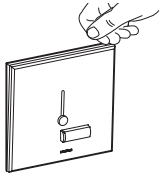
Remove frame
and then front plate.

3. Remove adapter.

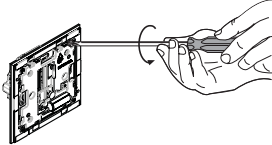

4. Assemble dimmer to trim ring.

* Trim ring must be oriented as shown when assembling to dimmer.

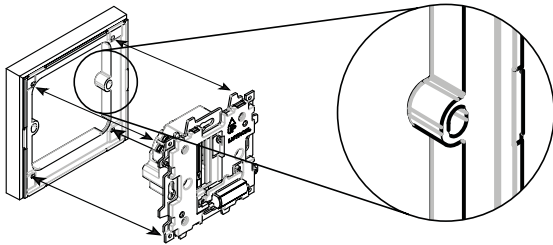

5. Tighten 4 screws supplied to mount dimmer to trim ring.

* Screws must be installed from the back as shown. Tighten to secure.

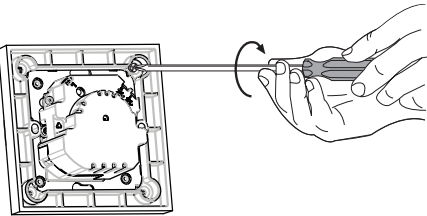

6. Wire dimmer. Refer to instructions provided with dimmer.

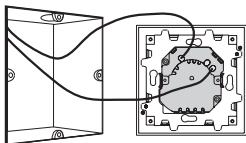

7. Install dimmer to backbox using mounting hardware supplied with dimmer.

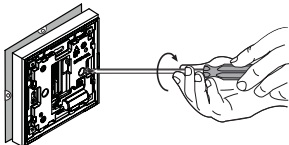

8. Snap on front plate.

OR

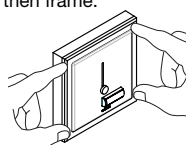
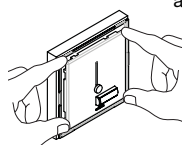
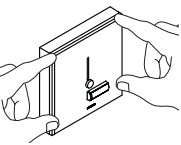
Snap on front plate
and then frame.

9. Follow remaining setup instructions for dimmer.

10. Turn power ON at MCB (circuit breaker) or replace fuse.

Trim Ring Compatibility Chart

Lutron Item #	Description	UK Backbox Depth	
		16 mm	25 mm
LSSI-501	Lyneo™ STO	X	✓
LSDI-251	Lyneo™ Dual STO	X	X
LNSI-502	Lyneo™ Preset	X	✓
LLSI-502	Lyneo™ Preset w/Status Light	X	✓
LLSM-502	Lyneo™ Preset w/Status Light	X	✓
LLDI-252	Lyneo™ Dual Preset w/Status Light	X	X
RNSI-452	Rania® Digital Dimmer	✓	✓
RNSU-452	Rania® Digital Dimmer	✓	✓
RNDI-252	Rania® Dual Digital Dimmer	X	X
RNDU-252	Rania® Dual Digital Dimmer	X	X
RDSU-452	Rania® Accessory Dimmer	✓	✓
RDDU-252	Rania® Dual Accessory Dimmer	X	X
RISI-452	Rania® IR Remote Control Digital Dimmer	✓	✓
RISU-452	Rania® IR Remote Control Digital Dimmer	✓	✓
RIDI-252	Rania® IR Dual Remote Control Digital Dimmer	X	X
RIDU-252	Rania® IR Dual Remote Control Digital Dimmer	X	X
RN-SS10	Single Switch	✓	✓
RN-DS10	Dual Switch	✓	✓
RN-IS10	Intermediate Switch	✓	✓

STO

Slide To Off

✓

Compatible

X

Not Compatible

Technical Assistance

If you have questions concerning the installation or operation of this product, call **Lutron's Headquarters**. Please provide exact model number when calling.

Lutron EA LTD

Tel: +44 (0) 207 702 0657

Fax: +44 (0) 207 480 6899

www.lutron.com/europe

FREEPHONE:

U.K.: 0800-282107

Spain: 900-974452

France: 0800-90-12-18

Germany: 00800-5887-6635

Northern China: 10-800-712-1536

Southern China: 10-800-120-1536

Macau: 0800-401

Hong Kong: 800-901-849

Singapore: 800-120-4491

Taiwan: 00-801-137-737

Thailand: 001-800-120-665853

Indonesia: 001-803-011-3994

Lutron GL LTD

Tel: +852-2104-7733

Fax: +852-2104-7633

www.lutron.com/asia

Limited Warranty

Lutron EA Ltd. ("Lutron EA") warrants each unit to be free from defects in material and workmanship and to perform under normal use and service. To the extent permitted by law, Lutron EA and Lutron Electronics Co. Inc. ("Lutron") make no warranties or representations as to the units except as set forth herein. This warranty shall run for a period of two years from the date of purchase and Lutron's obligations under this warranty are limited to remedying any defect, replacing any defective part or replacement (at Lutron EA's sole option) and shall be effective only if the defective unit is shipped to Lutron EA postage prepaid within 24 months after purchase of the unit. Repair or replacement of the unit does not affect the expiry date of the warranty. This warranty does not cover damage or deficiencies due to abuse, misuse, inadequate wiring or insulation or use or installation other than in accordance with instructions accompanying the unit.

To the extent permitted by law, neither Lutron EA nor Lutron shall be liable for any other loss or damage including consequential or special loss or damages, loss of profits, loss of income, or loss of contracts arising out of or relating to the supply of the unit or the use of the unit and the purchaser assumes and will hold harmless Lutron EA and Lutron in respect of all such loss or damage. Nothing in this warranty shall have the effect of limiting or excluding Lutron EA's or Lutron's liability for fraud or for death or personal injury resulting from its own negligence, or any other liability, if and to the extent that the same may not be limited or excluded as a matter of law.

This warranty does not affect the statutory rights of consumer purchasers of this product.

Although every attempt is made to ensure that catalogue information is accurate and up-to-date, please check with Lutron EA before specifying or purchasing this equipment to confirm availability, exact specifications, and suitability for your application. Patents pending.

Lutron and Rania are registered trademarks of Lutron Electronics Co., Inc. in the Community Trademark System, and Lyneo is a trademark of Lutron Electronics Co., Inc. © 2006 Lutron Electronics Co., Inc.

LUTRON®

Lutron EA Ltd.
Lutron House
6 Sovereign Close
Wapping, London E1W 3JF, England

Lutron GL Ltd
Room 2808, 28/F
248 Queen's Road East
Wanchai, Hong Kong

Made and printed in the U.S.A. 10/06 P/N 030-931 Rev. C