

Please read before installing.

Description

The SV-100SF-230-ST is a 24 V~ safety-isolating transformer that is used with a *Sivoia QED* motorized window shade. The transformer provides enough power for one *Sivoia QED* Electronic Drive Unit (EDU) to operate a 9.3 m² shade (20.9 m² for a High Torque Electronic Drive Unit). The transformer input is supplied by 230 V~ and provides a 24 V~ output. The transformer contains a 1,0 AT and temperature fuse (121°C) on the primary and a 3,0 A ATO fuse on the secondary.

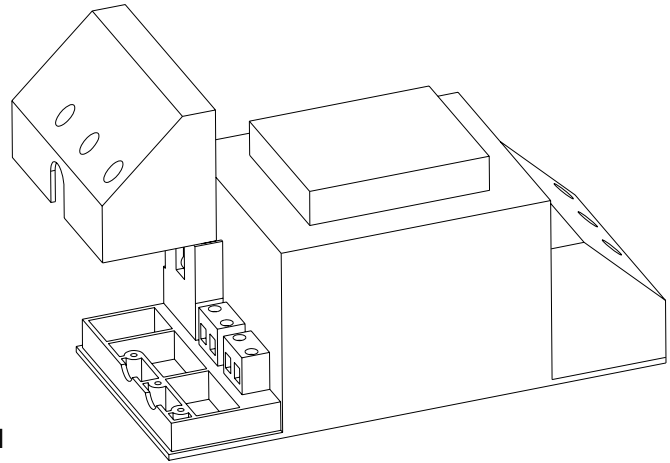

Important Notes

1. All wiring must be in accordance with national and local electrical codes
2. This transformer must be installed by a qualified electrician.
3. Ambient operating temperature: 0 - 40°C, 0 - 90% humidity, non-condensing.
4. This product is intended for Indoor Use Only.
5. This product is only to be used with Lutron Shading Products.

Figure 1

Transformer Dimensions

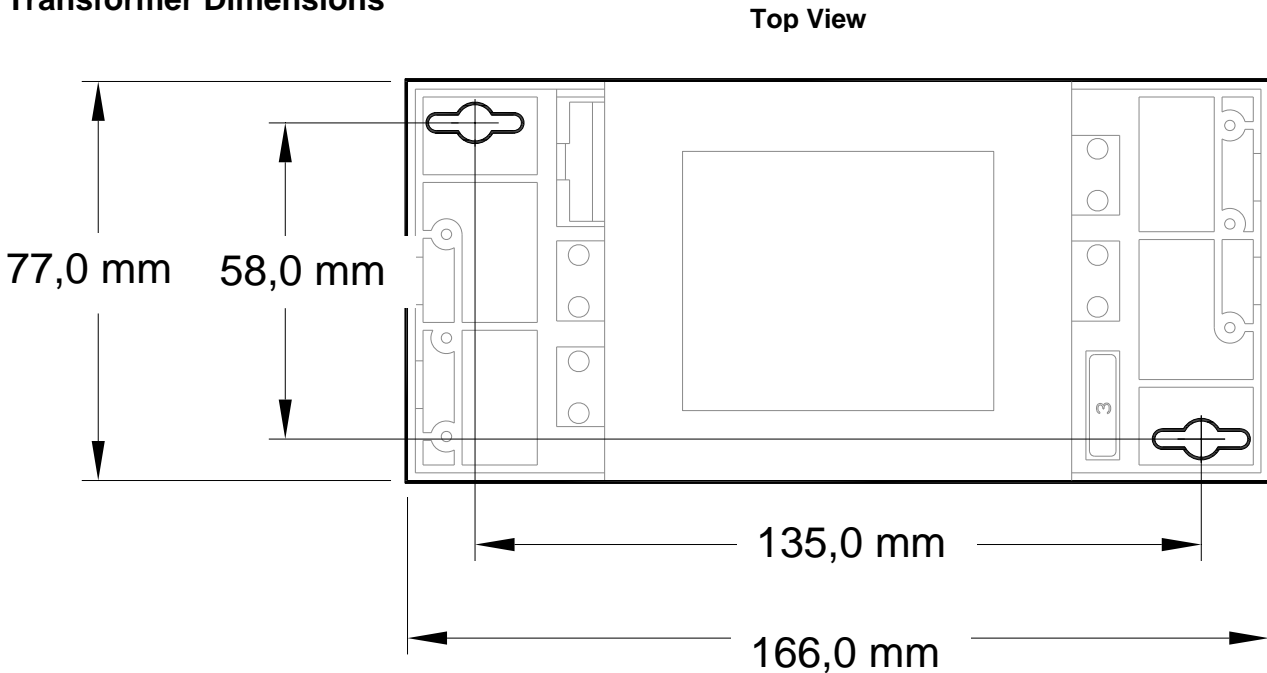

Side View

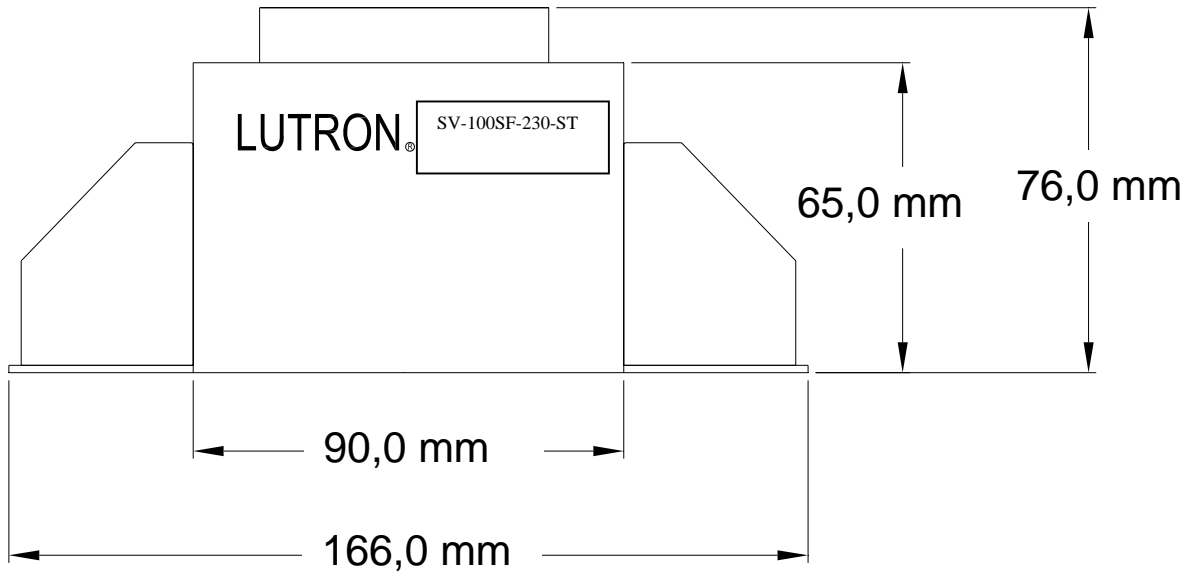
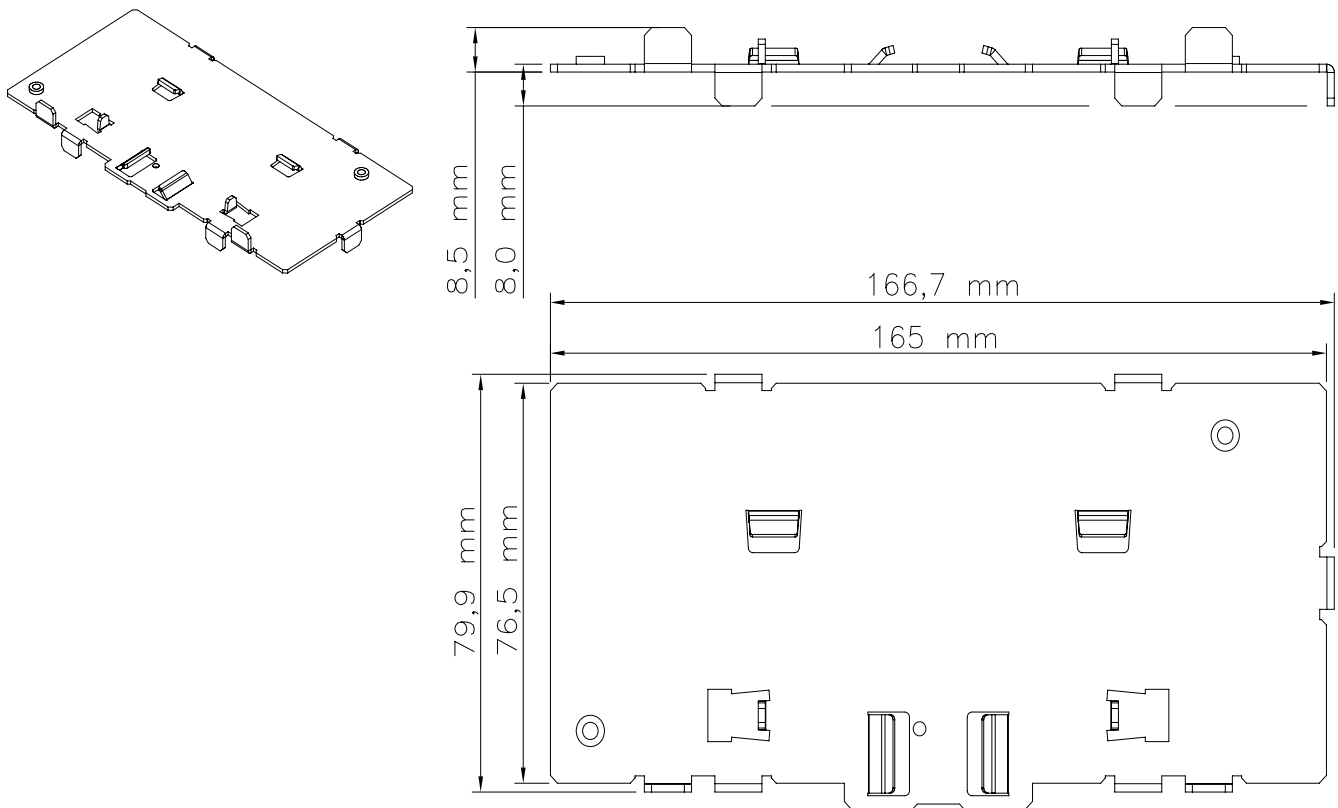

Figure 2

Dimensions DIN-Rail Mounting Plate (Optional) Lutron Model #: SV-100SF-230-ADP



Installation

1. **Mount Power Supply** using one of the following methods:

a. **Wall Mount** - Remove the two end caps from the transformer. Using the pattern of the keyholes on the rear of the transformer, install two screws into the wall (use screws rated for a 10kg load; M4 screws recommended). See Figure 3. (Below)

Figure 3

Hang the transformer on the screws and tighten securely.

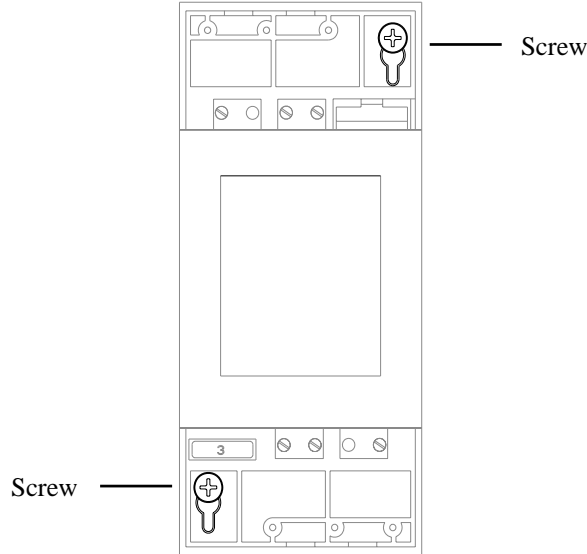

b. **DIN Rail Mount** - (Lutron model number SV-100SF-230-ADP) Mount DIN rail (not provided) on wall. Attach DIN-Rail adapter onto the back of the transformer with hardware provided. Insert one side of DIN-Rail into the two tabs located on the bottom of the DIN-Rail adapter. Position where desired and lock into place by pushing the spring loaded RED tab into the opposite side of the DIN-Rail. See Figure 4 (Below)

Figure 4

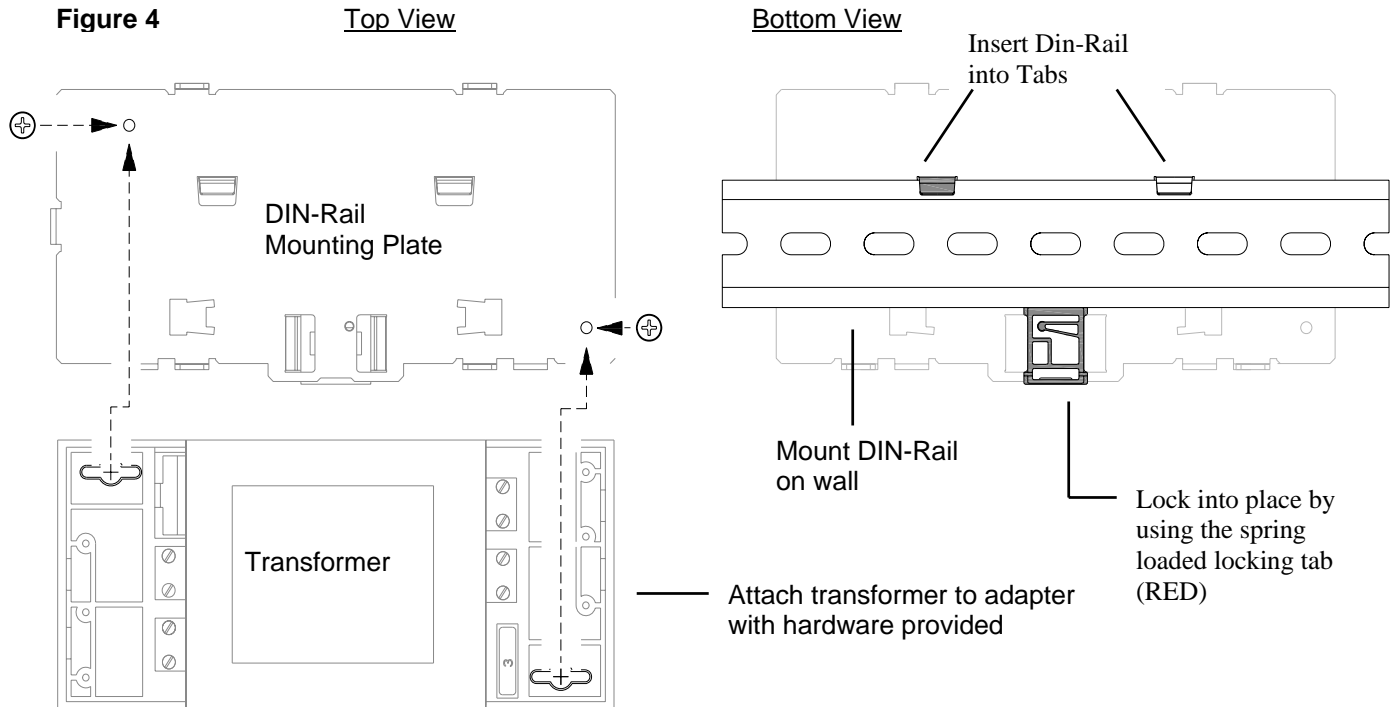

Wiring:



Danger - Locate and lock the supply breaker in the OFF position before wiring to the terminal blocks.



Caution – Do not short the output terminals.

The LUTRON SV-100SF-230-ST transformer can be either hard wired from the distribution panel or wired to a 230VAC receptacle using one of the following LUTRON power cords:

SV-230-MC-UK 230, Mains Cord, UK Type Plug

SV-230-MC-EA 230, Mains Cord, EA Type Plug

Note: Minimum feed breaker size of 10 Amps.

2. Run Primary wiring (230 V~) into the Power Supply.

With the end-caps removed, connect the terminals marked L and N on the primary (PRI) to the 230 V mains. Connect the ground terminal to EGND (⊕).

Note: Each terminal block will accept one 10-18 AWG wire. Tighten terminal blocks to 0.4–0.6 Nm. **Do not over tighten.**

3. Run Secondary wiring (24 V~) into the Power Supply.

Run the low-voltage wiring from the *Sivoia QED* Electronic Drive Unit (EDU) to the transformer. Connect the AC supply wires to the terminal blocks on the secondary (SEC) of the transformer marked AC. Connect the EGND (⊕) terminal on the transformer to the ground terminal of the EDU.

IMPORTANT - Ensure that EGND (⊕) (from the distribution Panel or receptacle) is connected to EGND (⊕) on the primary side (PRI) of the transformer and that the EGND (⊕) from the *Sivoia QED* Electronic Drive Unit (EDU) is connected to EGND (⊕) on the secondary (SEC) of the transformer.

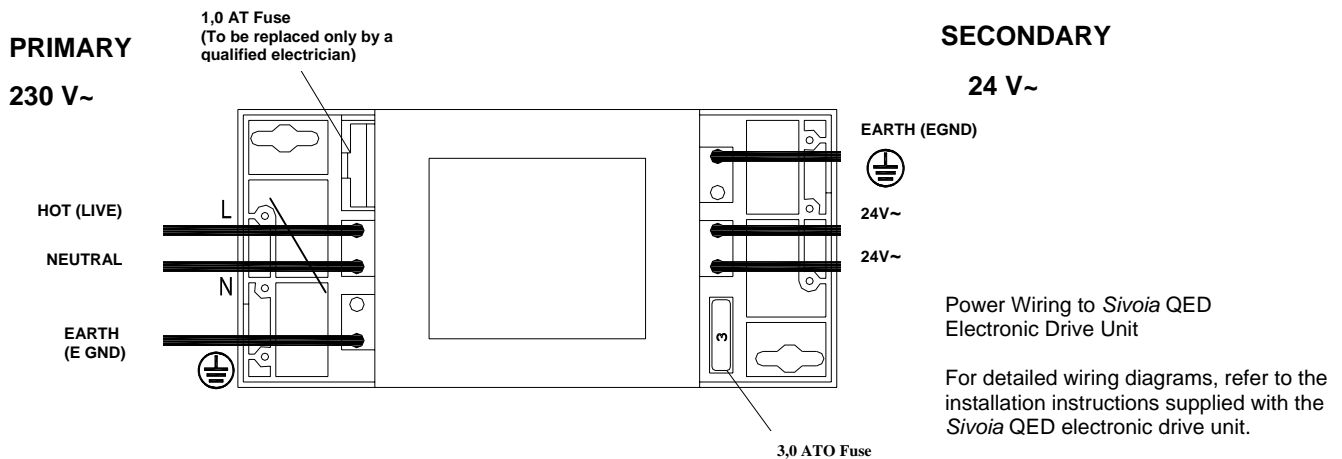

4. Replace End-Caps Replace the End-Caps on both the primary and the secondary side of the transformer, making sure that the wires are properly strain relieved. Fasten to unit with screws provided.

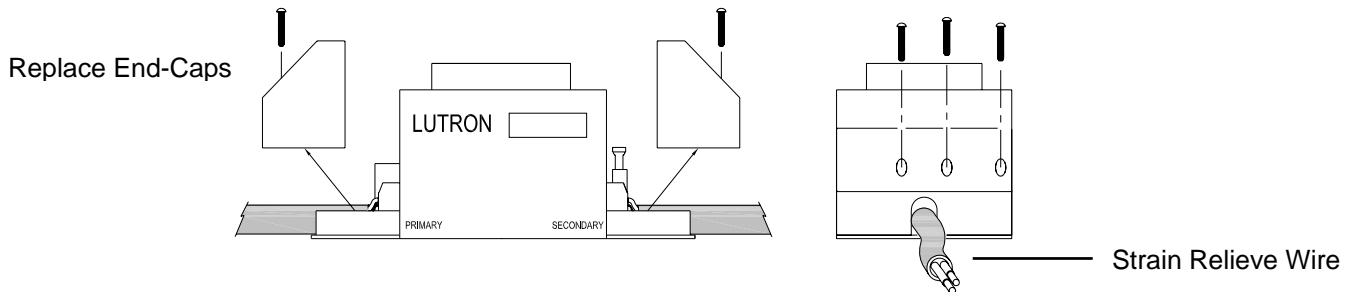

Limited Warranty

Lutron will, at its' option, repair or replace any unit that is defective in materials or manufacture within one year after purchase. For warranty service, return unit to place of purchase or mail to Lutron at 7200 Suter Rd., Coopersburg, PA 18036-1299, postage pre-paid.

THIS WARRANTY IS IN LIEU OF ALL OTHER EXPRESS WARRANTIES, AND THE IMPLIED WARRANTY OF MERCHANTABILITY IS LIMITED TO ONE YEAR FROM THE PURCHASE. THIS WARRANTY DOES NOT COVER THE COST OF INSTALLATION, REMOVAL OR REINSTALLATION, OR DAMAGE RESULTING FROM MISUSE, ABUSE, OR DAMAGE FROM IMPROPER WIRING OR INSTALLATION. THIS WARRANTY DOES NOT COVER INCIDENTAL OR CONSEQUENTIAL DAMAGES. LUTRON'S LIABILITY ON ANY CLAIMS FOR DAMAGES ARISING OUT OF OR IN CONNECTION WITH THE MANUFACTURE, SALE, INSTALLATION, DELIVERY, OR USE OF THE UNIT SHALL NEVER EXCEED THE PURCHASE PRICE OF THE UNIT.

This warranty gives you specific legal right, and you may have other rights, which vary from state to state. Some states do not allow the exclusion or limitation of incidental or consequential damages, or limitation on how long an implied warranty may last, so the above limitations may not apply to you.

Lutron, the Sunburst logo, and Sivoia QED are registered trademarks of Lutron Electronics Co., Inc.

Technical Assistance

WORLD

HEADQUARTERS

Lutron Electronics Co., Inc.
7200 Suter Road
Coopersburg, PA 18036
United States
Tel: +1-610-282-3800
Fax: +1-610-282-1243

EUROPEAN

HEADQUARTERS

Lutron EA Ltd
6 Sovereign Close
London, E1W 3JF
United Kingdom
Tel: +44-(0) 20-7702-0657
Fax: +44-(0) 20-7480-6899

CUSTOMER

SERVICE/ORDERING

UK +44-(0) 20-7702-0657 –
09.00 - 18.00 GMT
USA +1-800-446-1503 –
08.00 - 20.00 EST

CUSTOMER SERVICE/ E-MAIL

shadinginfo@lutron.com

TECHNICAL SUPPORT AND SERVICES

24 hours/7 days
UK +44-(0) 20-7702-0657
09.00 - 18.00 GMT

INTERNET:

www.lutron.com

ADDITIONAL LUTRON SALES OFFICES:

Germany

Tel: +49-309-710-4590
Fax: +49-309-710-4591 FREEPHONE
0800-5887-6635

France

Tel: +33-(0) 1-44-70-71-86 Fax: +33-(0) 1-
44-70-70-97 FREEPHONE 0800-90-12-18

Spain-Madrid

Tel: +34-91-567-84-79 Fax: +34-91-567-84-
78 FREEPHONE 0900-948-944

Spain-Barcelona

Tel: +34-93-496-57-42 Fax: +34-93-496-57-
50 FREEPHONE 0900-948-944

Hong Kong

Tel: +852-2104-7733 Fax: +852-
2104-7633

Beijing

Tel: +86-10-5877-1817 Fax: +86-10-
5877-1816

Shanghai

Tel: +86-21-6288-1473 Fax: +86-21-
6288-1751

Singapore

Tel: +65-6220-4666 Fax: +65-6220-4333

Japan

Tel: +81-3-5575-8411 Fax: +81-3-
5575-8420



Lutron Electronics Co., Inc.
7200 Suter Road
Coopersburg, PA 18036 U.S.A.
Made and printed in the U.S.A. 08/07 P/N 040-231-12 Rev.B