

RadioRA System Planning Worksheet Instructions

Overview

This document will assist in the design and installation of a *RadioRA* system—to ensure that all of the necessary parts are in place prior to installation. The worksheet aids installation by verifying: proper dimmer types, 3-way devices, faceplates, proper ganging with non-system devices, etc.

Following the instructions below, fill in the worksheet on page 3 when laying out a *RadioRA* system.

- A** Sketch the rough layout of the area/room in the box at the top center of the page. Mark the locations of each of the existing wallboxes (light switch locations).
- B**
1. Fill in a description of each wallbox location in the room, starting with the wallbox that has the largest number of controls. Mark the sketch with the matching number for each wallbox. Shade out unused switch or dimmer locations in the wallbox diagrams so they match the existing wallboxes.
 2. Fill in a description of the lights controlled by each switch or dimmer in the wallbox. Fill in the load type (Inc., MLV, etc.) and wattage for each switch or dimmer.
 3. For each existing switch or dimmer to be included in the *RadioRA* system, fill in the appropriate model in the *RadioRA* Wall Dimmers/Switches column. If the light is controlled from more than one location, fill in the appropriate model in the *RadioRA* Wall Dimmers/Switches column, and place an AD (Accessory Dimmer) or AS (Accessory Switch) in the *RadioRA* Wall Dimmers/Switches column for each additional location.
 4. Place a 1P (single-pole) or 3W (3-way) in the Non-System Dimmers/Switches column for any dimmers or switches that will not be controlled by the *RadioRA* system.
 5. If it is desired to add a Master Control to a wallbox, fill in the appropriate model in the Master Control column. There are several ways to retrofit Master Controls into an existing home. Please refer to *RadioRA* Application Note #41, 'How to retrofit a *RadioRA* Wall-Mounted Master Control into an existing home', for more information.
 6. Fill in the total number of Dimmers and Switches, Accessory Dimmers and Switches, Non-System dimmers and switches, and Master Controls in the 'Totals for this room' at the bottom of each column.
- C** Write in any table or floor lamps that should be included in the *RadioRA* system in the spaces provided for 'Lamp Dimmer Locations'.
- Write in the locations for any Tabletop Master Controls for this area/room.
- Write in any Entry Master Controls and Visor Controls to be added to the system.
- D** Complete a worksheet for each area or room in the home. Multiple sheets may be used for areas or rooms that have more than 3 wallbox locations. The completed worksheets will give a good estimate of the total number of components needed to control the home with the *RadioRA* system.

RadioRA System Planning Worksheet

Page 1 of 1 Date: 4/26/05
 Area Name: Living Room

Complete a worksheet for each room where you would like RadioRA controls. See instructions for assistance.

A Sketch room layout here with wallbox locations. Match to wallbox diagrams below.

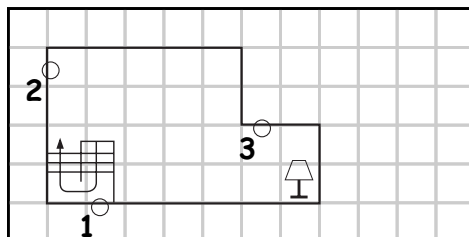

B Fill in a description of the lights controlled by each wallbox in your room. Use boxes at right to designate new controls desired.

Wallbox 1: Foyer Entry



Wallplate:
 Claro® CW-__-__
 Satin Colors™ SC-5-SW

Light to be controlled

- A Stair light
- B Family Room
- C Front porch light
- D Closet
- E Master Control
- F _____

Wallbox 2: Dining Room Entry



Wallplate:
 Claro CW-__-__
 Satin Colors SC-3-SW

Light to be controlled

- A Stair light
- B Dining room table
- C Switched outlet
- D _____

Wallbox 3: TV Room North



Wallplate:
 Claro CW-__-__
 Satin Colors SC-2-SW

Light to be controlled

- A TV overhead
- B Wall sconces
- C _____
- D _____

	Load Type / Wattage	RadioRA Wall Dimmers / Switches 6D / 10D / 8ANS	RadioRA Wall Accessory Dimmers / Switches AD / AS	Non-System Dimmers / Switches 1P / 3W	Master Control 2W / 5W-RL / 5W-AO
A <u>Stair light</u>	Inc. 150	6D			
B <u>Family Room</u>	Inc. 300	6D			
C <u>Front porch light</u>	Inc. 100	6D			
D <u>Closet</u>	Inc. 100	8ANS			
E <u>Master Control</u>					5W-AO
F _____					
A <u>Stair light</u>			AD		
B <u>Dining room table</u>	MLV 300	6D			
C <u>Switched outlet</u>				1P	
D _____					
A <u>TV overhead</u>	Inc. 150	6D			
B <u>Wall sconces</u>	Inc. 150	6D			
C _____					
D _____					
Totals for this room					
	6D 6	AD 1	1P 1	2W	
	10D	AS	3W	5W-RL	
	8ANS 1			5W-AO 1	

C Include Lamp Dimmers, Entry/Tabletop Master Controls, and Visor Controls if needed for this room.

Lamp Dimmers	Entry Master/Visor Controls	Tabletop Master Controls
LD1 <u>Table Lamp</u>	EM _____	TT1 <u>Coffee Table</u>
LD2 _____	Visor 1 _____	TT2 _____
	Visor 2 _____	

RadioRA System Planning Worksheet

Page ___ of ___ Date: _____
 Area Name: _____

Complete a worksheet for each room where you would like *RadioRA* controls. See instructions for assistance.

A Sketch room layout here with wallbox locations. Match to wallbox diagrams below.

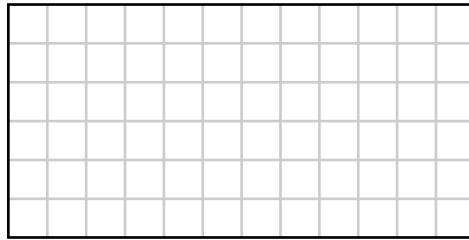

B Fill in a description of the lights controlled by each wallbox in your room. Use boxes at right to designate new controls desired.

Wallbox 1: _____

A	B	C	D	E	F
---	---	---	---	---	---

Wallplate:

Claro® CW-__-__
 Satin Colors™ SC-__-__

Wallbox 2: _____

A	B	C	D
---	---	---	---

Wallplate:

Claro CW-__-__
 Satin Colors SC-__-__

Wallbox 3: _____

A	B	C	D
---	---	---	---

Wallplate:

Claro CW-__-__
 Satin Colors SC-__-__

Light to be controlled

A _____
 B _____
 C _____
 D _____
 E _____
 F _____

Light to be controlled

A _____
 B _____
 C _____
 D _____

Light to be controlled

A _____
 B _____
 C _____
 D _____

	Load Type / Wattage	RadioRA Wall Dimmers / Switches 6D / 10D / 8ANS	RadioRA Wall Accessory Dimmers / Switches Accessory Switches AD / AS	Non-System Dimmers / Switches 1P / 3W	Master Control 2W / 5W-RL / 5W-AO
Totals for this room	6D 10D 8ANS	AD AS	1P 3W	2W 5W-RL 5W-AO	

C Include Lamp Dimmers, Entry/Tabletop Master Controls, and Visor Controls if needed for this room.

Lamp Dimmers	Entry Master/Visor Controls	Tabletop Master Controls
LD1 _____	EM _____	TT1 _____
LD2 _____	Visor 1 _____	TT2 _____
	Visor 2 _____	