

Operating the Wireless Controller

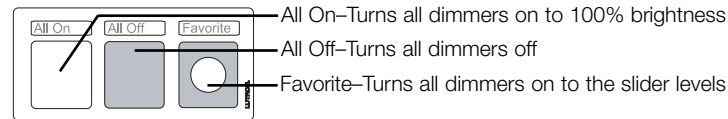

Troubleshooting

Symptom	Possible Cause
The Wireless Controller does not turn on lights, or is not communicating with the System.	<p>Wireless Controller has not been activated in the System.</p> <ul style="list-style-type: none"> • Activate Wireless Controller in the System, following the instructions on page 3. <p>Wireless Controller is not within range of the Central Antenna or Security Interface.</p> <ul style="list-style-type: none"> • Move the Wireless controller to be within 100 feet (30 m) of the Central Antenna or Security Interface.
Cannot activate Wireless Controller: Add LED on Central Antenna/Security Interface turns orange after approximately 3 seconds (Central Antenna/Security Interface does not beep).	<ul style="list-style-type: none"> • Call the Lutron Technical Support Center at +1.800.523.9466 for assistance.
Cannot activate Wireless Controller: Central Antenna/Security Interface beeps three (3) times.	Wireless Controller has already been added to System.

LIMITED WARRANTY

Subject to the exclusions described below, for a period of one year after the date of shipment by Lutron, Lutron warrants each new AuroRa product ("Product") to be free from manufacturing defects. Lutron will, at its option, repair the defective part or provide comparable replacement parts so long as Lutron is promptly notified of the defect within the one year warranty period. Replacement parts provided by Lutron may be new, used, repaired, reconditioned, and/or made by a different manufacturer.

EXCLUSIONS TO LIMITED WARRANTY

This Warranty does not cover, and Lutron and its suppliers are not responsible for:

1. Damage, malfunction or inoperability diagnosed by Lutron or a Lutron approved third party as caused by normal wear and tear, abuse, misuse, incorrect installation, neglect, accident, or interference from radio frequency or infrared sources or obstacles, such as, but not limited to (a) use of incorrect line voltages, fuses or circuit breakers; (b) failure to install, maintain and operate the Product pursuant to the operating instructions provided by Lutron and the applicable provisions of the National Electrical Code and of the Safety Standards of Underwriter's Laboratories; (c) use of incompatible devices or accessories; (d) failure to maintain equipment under specified ambient temperature; (e) unauthorized repairs or adjustments; (f) vandalism; and (g) an act of God, such as fire, lightning, flooding, tornado, earthquake, hurricane or other problems beyond Lutron's control.
2. On-site labor costs to diagnose issues with, and remove, repair, replace, adjust, reinstall and/or reprogram the Product, at Lutron's option, all of which will be paid by Customer at the then current service price.
3. Where applicable, components and equipment external to the Product, such as, lamps; non-Lutron ballasts, sockets, and fixtures; fixture wiring between ballasts and lamps; building wiring between dimmers or dimmer panels and lamps and between controls and controls, dimmers or dimmer panels; and other manufacturers' equipment not provided by Lutron, such as time clocks; audio-visual equipment; motion detectors; photo sensors; driveway sensors; pressure pads; shades; and spas.
4. The cost of repairing or replacing other property that is damaged when the Product does not work properly, even if the damage was caused by the Product.

THIS WARRANTY IS IN LIEU OF ALL OTHER EXPRESS WARRANTIES. ALL IMPLIED WARRANTIES, INCLUDING THE IMPLIED WARRANTIES OF MERCHANTABILITY AND OF FITNESS FOR A PARTICULAR PURPOSE, ARE LIMITED TO ONE YEAR FROM THE DATE OF SHIPMENT.

NO LUTRON AGENT, EMPLOYEE OR REPRESENTATIVE HAS ANY AUTHORITY TO BIND LUTRON TO ANY AFFIRMATION, REPRESENTATION OR WARRANTY CONCERNING THE PRODUCT, UNLESS AN AFFIRMATION, REPRESENTATION OR WARRANTY MADE BY AN AGENT, EMPLOYEE OR REPRESENTATIVE IS SPECIFICALLY INCLUDED HEREIN, OR IN STANDARD PRINTED MATERIALS PROVIDED BY LUTRON, IT DOES NOT FORM A PART OF THE BASIS OF ANY BARGAIN BETWEEN LUTRON AND CUSTOMER AND WILL NOT IN ANY WAY BE ENFORCEABLE BY CUSTOMER.

IN NO EVENT WILL LUTRON OR ANY OTHER PARTY BE LIABLE FOR EXEMPLARY, CONSEQUENTIAL, INCIDENTAL OR SPECIAL DAMAGES (INCLUDING, BUT NOT LIMITED TO DAMAGES FOR

PERSONAL INJURY, FAILURE TO MEET ANY DUTY, INCLUDING OF GOOD FAITH OR REASONABLE CARE, NEGLIGENCE, OR ANY OTHER LOSS WHATSOEVER), NOR FOR ANY REPAIR WORK UNDERTAKEN WITHOUT LUTRON'S PRIOR WRITTEN CONSENT ARISING OUT OF OR IN ANY WAY RELATED TO THE INSTALLATION, DEINSTALLATION, USE OF OR INABILITY TO USE THE PRODUCT OR OTHERWISE UNDER OR IN CONNECTION WITH ANY PROVISION OF THIS WARRANTY, EVEN IN THE EVENT OF THE FAULT, TORT (INCLUDING NEGLIGENCE), STRICT LIABILITY, BREACH OF CONTRACT OR BREACH OF WARRANTY OF LUTRON OR ANY SUPPLIER, AND EVEN IF LUTRON OR ANY OTHER PARTY WAS ADVISED OF THE POSSIBILITY OF SUCH DAMAGES. NOTWITHSTANDING ANY DAMAGES THAT CUSTOMER MIGHT INCUR FOR ANY REASON WHATSOEVER (INCLUDING, WITHOUT LIMITATION, ALL DIRECT DAMAGES AND ALL DAMAGES LISTED ABOVE), THE ENTIRE LIABILITY OF LUTRON AND OF ALL OTHER PARTIES UNDER THIS WARRANTY ON ANY CLAIM FOR DAMAGES ARISING OUT OF OR IN CONNECTION WITH THE MANUFACTURE, SALE, INSTALLATION, DELIVERY, USE, REPAIR, OR REPLACEMENT OF THE PRODUCT, AND CUSTOMER'S SOLE REMEDY FOR THE FOREGOING, WILL BE LIMITED TO THE AMOUNT PAID BY CUSTOMER FOR THE PRODUCT. THE FOREGOING LIMITATIONS, EXCLUSIONS AND DISCLAIMERS WILL APPLY TO THE MAXIMUM EXTENT ALLOWED BY APPLICABLE LAW, EVEN IF ANY REMEDY FAILS ITS ESSENTIAL PURPOSE. THIS WARRANTY GIVES YOU SPECIFIC LEGAL RIGHTS. YOU MAY ALSO HAVE OTHER RIGHTS WHICH VARY FROM STATE TO STATE. SOME STATES DO NOT ALLOW LIMITATIONS ON HOW LONG AN IMPLIED WARRANTY LASTS OR THE EXCLUSION OR LIMITATION OF INCIDENTAL OR CONSEQUENTIAL DAMAGES, SO THE ABOVE LIMITATIONS OR EXCLUSIONS MAY NOT APPLY TO YOU.

WARRANTY CLAIMS, TECHNICAL ASSISTANCE AND WARRANTY INFORMATION

Contact the **Lutron Technical Support Center** at the numbers provided below or your local Lutron sales representative with questions concerning the installation or operation of the Product or this Warranty, or to make a warranty claim. Please provide the exact model number when calling.

USA and Canada (24 hrs/7days)
+1.800.523.9466
Other countries (8 a.m. - 8 p.m. ET)
+1.610.282.3800
Fax +1.610.282.3090
<http://www.lutron.com>

Lutron, AuroRa and the sunburst logo are registered trademarks of Lutron Electronics Co., Inc.
© 2007 Lutron Electronics Co., Inc.

Lutron Electronics Co., Inc.
7200 Suter Road
Coopersburg, PA 18036-1299, U.S.A.
Made and printed in the U.S.A. 1/07 P/N 044-107 Rev. A

AuroRa®

Installation Instructions for Wireless Controller

Read all instructions completely before installation.

Overview

The AR-WC-WH Wireless Controller is for use with *AuroRa* systems in conjunction with the Central Antenna (AR-CA-WH) or Security Interface (AR-SI-WH), and allows the wireless activation of *AuroRa* Dimmers.

Up to ten (10) Wireless Controllers may be used with each *AuroRa* System.

Important Notes

Batteries: (2) 3 Volt Lithium coin cell (#CR2032). Batteries are included and pre-installed.

Note: Factory installed battery lifetime is approximately 10 years.

Environment: Meets the temperature standards set by the Society of Automotive Engineers (SAE): -40 °C (-40 °F) to 113 °C (235 °F).

Finish: Do not paint the Wireless Controller.

Cleaning: To clean, wipe with a clean damp cloth. **DO NOT** use any chemical cleaning solutions.

Transmitter to Receiver Range: Typically 100 feet (30 m). The performance of the Wireless Controller is highly dependent upon a variety of complex factors such as:

- Distance
- Construction of walls
- Electrical equipment nearby

System Control: Before the Wireless Controller may be used to control lights in the *AuroRa* system, it must be activated.

Wireless Controller AR-WC-WH

6 V== 35 mA

AR-WC-WH

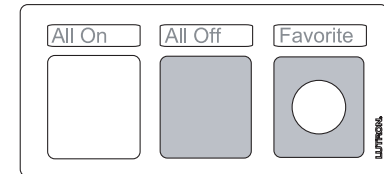

FCC Information

Note: This equipment has been tested and found to comply with the limits for a Class B digital device, pursuant to Part 15 of the FCC rules. These limits are designed to provide reasonable protection against harmful interference in a residential installation. This equipment generates, uses and can radiate radio frequency energy and, if not installed and used in accordance with the instructions, may cause harmful interference to radio or television reception. However, there is no guarantee that interference will not occur in a particular installation. If this equipment does cause harmful interference to radio or television reception, which can be determined by turning the equipment off and on, the user is encouraged to try to correct the interference by one or more of the following measures:

- Reorient or relocate the receiving antenna.
- Increase the separation between the equipment and receiver.
- Connect the equipment into an outlet on a circuit different from that to which the receiver is connected.
- Consult the dealer or an experienced radio/TV technician for help.

Caution: Changes or modifications not expressly approved by Lutron Electronics Co. could void the user's authority to operate this equipment. Operation is subject to the following: (1) This device may not cause harmful interference, and (2) this device must accept any interference received, including interference that may cause undesired operation.



Installing the Wireless Controller

The Wireless Controller may be mounted in the following ways:

- On a vehicle's visor using the supplied visor clip
- Placed on a table
- Mounted on a wall

Visor Mount

- 1 Attach visor clip to Wireless Controller.** Slide visor clip into channel on the back of the Wireless Controller.

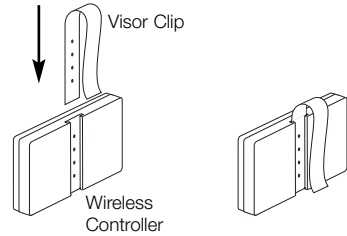

- 2 Mount Wireless Controller onto vehicle's visor.** Visor clip may need to be manually opened depending on visor thickness.

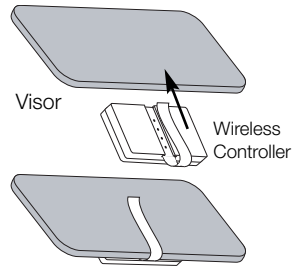

Tabletop

- 1 Attach footpads to Wireless Controller.** Peel the footpads from the paper backing and place in the four circular indentations on the back of the Wireless Controller.

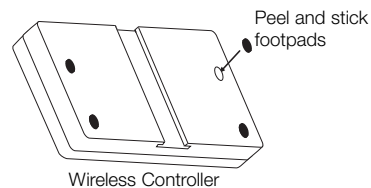

Wall Mount

- 1 Attach wall bracket to wall.** Use the supplied screws and wall anchors*. Wall bracket may be placed vertically or horizontally. When mounting horizontally, make sure that the end stop is at the bottom.

*Note: Drill pilot holes for the wall anchors using a 3/16" drill bit.

Horizontal Mounting

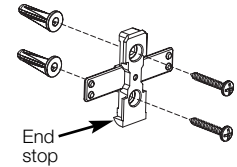

Vertical Mounting

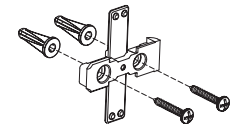

- 2 Slide Wireless Controller onto wall bracket.** The clip on the wall bracket slides into the channel on the back of the Wireless Controller.

Horizontal Mounting Vertical Mounting

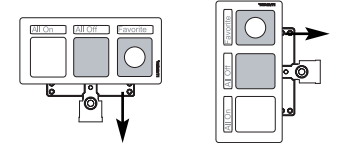

Activating the Wireless Controller

Before the Wireless Controller may be used to control lights in the AuroRa® System, it must be activated. The Wireless Controller can be activated in the system using either the Central Antenna (AR-CA-WH) or the Security Interface (AR-SI-WH). The procedure below refers to the Central Antenna; however, the procedure is the same for the Security Interface.

- 1 Enter Add Mode.** Press and hold the Add button on the Central Antenna until the Add LED begins to flash (approximately 3 seconds). The Central Antenna will beep.

Dimmers that are in the System will flash their lights. The Master Control will flash the LEDs corresponding to Dimmers present in the System.

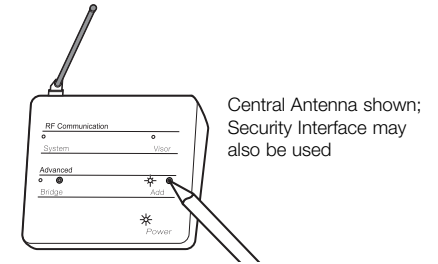

- 2 Activate Wireless Controller.** Press and hold any button on the Wireless Controller until the Add and Visor LEDs on the Central Antenna start flashing together and the Central Antenna beeps once (approximately two seconds), indicating the Wireless Controller has been activated in the system. The Add LED and the Visor LED will remain flashing until the Wireless Controller button is released.

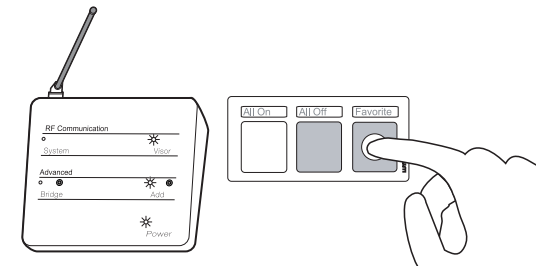

- 3 Exit Add Mode.** Press and hold the Add button until the Add LED stops flashing and remains off (approximately 3 seconds). The Dimmers will stop flashing their lights and the Central Antenna will beep.

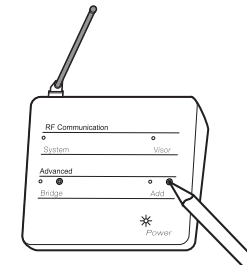

- 4 The Wireless Controller has now been activated.**