

Three-Location Installation

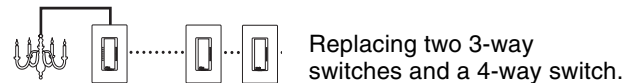

Replacing two 3-way switches and a 4-way switch.

For installations involving more than one switch in a wallbox, refer to Multigang Installations on page 2 before beginning.

✓ **Check off Steps as completed.**

Step 1 Turn power OFF at circuit breaker or remove fuse.

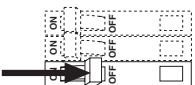

Step 2 Remove wallplates. Pull switches from wall.

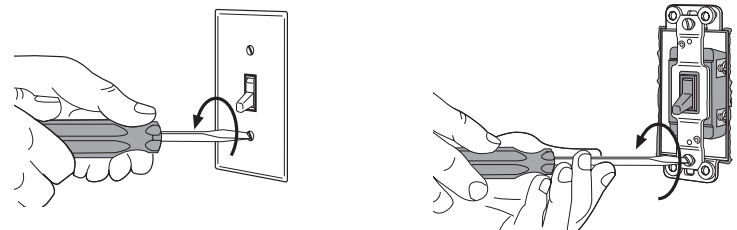

Step 3 Disconnect wires.

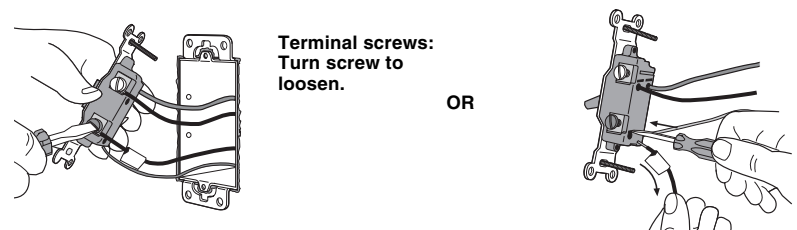

Terminal screws:
Turn screw to
loosen.

OR

Backwired:
Insert screwdriver.
Pull out wire.

Important Wiring Information

When making wire connections, follow the recommended strip lengths and combinations for the supplied wire connectors. **Note:** Wire connectors provided are suitable for **copper wire only**. For aluminum wire, consult an electrician.

Small:
Strip insulation 3/8" for 14 AWG wire
Strip insulation 1/2" for 16 or 18 AWG wire
Use to join one 14 AWG supply wire with one 16 or 18 AWG control wire.

Large:
Strip insulation 1/2" for 10, 12 or 14 AWG wire
Strip insulation 5/8" for 16 or 18 AWG wire
Use to join one or two 12 or 14 AWG supply wires with one 10, 12, 14, 16, or 18 AWG control wire.

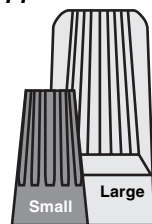

Twist wire
connector tight.
Be sure no bare
wire is exposed.



Step 4 Wiring the *Switch* with two *Accessory Switches* (4-way).

A) Wiring Switch on feed side

- Connect each control's **green** ground wire to the ground wire in its wallbox. If there is no ground wire in your wallbox, consult an electrician.
- Connect the *Switch* **white** wire to the neutral wire in the wallbox.
- Connect the *Switch* **blue** wire to the **blue** wire on both *Accessory Switches*.
- Connect the *Switch* **black** wire to Hot (the wire leading to the circuit breaker or fusebox).
- Connect the *Switch* **red** wire to the **black** wire on the first *Accessory Switch*.
- Connect the first *Accessory Switch* **red** wire to the **black** wire on the second *Accessory Switch*.
- Connect the second *Accessory Switch* **red** wire to the Load (wire leading to the light fixture(s)).

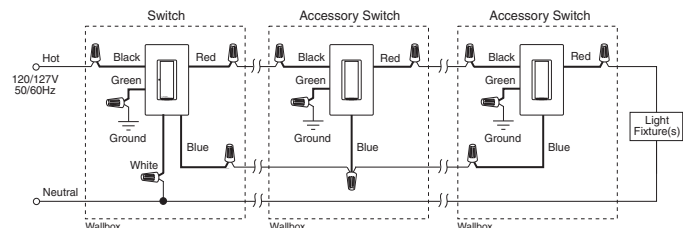

B) Wiring Switch on load side

- Connect each control's **green** ground wire to the ground wire in its wallbox. If there is no ground wire in your wallbox, consult an electrician.
- Connect the *Switch* **blue** wire to the **blue** wire on both *Accessory Switches*.
- Connect the first *Accessory Switch* **black** wire to Hot (the wire leading to the circuit breaker or fusebox).
- Connect the first *Accessory Switch* **red** wire to the **black** wire on the second *Accessory Switch*.
- Connect the second *Accessory Switch* **red** wire to the **black** wire on the *Switch*.
- Connect the *Switch* **white** wire to the neutral wire in the wallbox.
- Connect the *Switch* **red** wire to the Load (wire leading to the light fixture(s)).

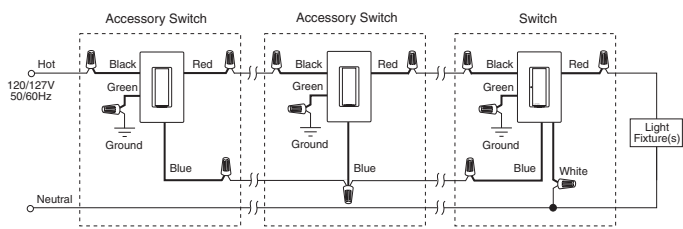

C) Switch Replacing 4-way Switch

- Connect each control's **green** ground wire to the ground wire in its wallbox. If there is no ground wire in your wallbox, consult an electrician.
- Connect the *Switch* **blue** wire to the **blue** wire on both *Accessory Switches*.
- Connect the first *Accessory Switch* **black** wire to Hot (wire leading to the circuit breaker or fusebox).
- Connect the first *Accessory Switch* **red** wire to the **black** wire on the *Switch*.
- Connect the *Switch* **white** wire to the neutral wire in the wallbox.
- Connect the *Switch* **red** wire to the **black** wire on the second *Accessory Switch*.
- Connect the second *Accessory Switch* **red** wire to the Load (wire leading to the light fixture(s)).

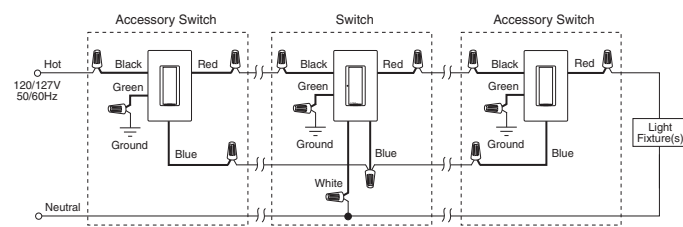

Three-Location Installation Continued

Step 5 Mount and align switches. Attach **Claro®** wallplates (purchased separately).

Tighten screws until snug.

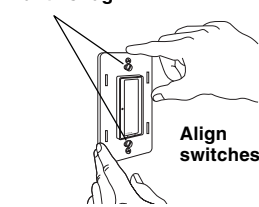

Align switches.

Attach wallplates.

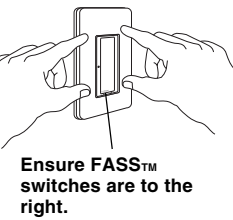

Ensure FASS™ switches are to the right.

Step 6 Turn power ON.

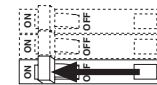

Troubleshooting

Symptom	Possible Cause
Light does not turn on.	<ul style="list-style-type: none"> • Front Accessible Service Switch (FASS™) on the switches are switched to the left side. • Light bulb(s) burned out. • Breaker is OFF or tripped. • Blue wire on <i>Accessory Switch</i> not connected to the same color wire as the blue wire on <i>Switch</i>. • Black wire on <i>Switch</i> is not directly connected to Hot or connected to Hot via an <i>Accessory Switch</i>.

FCC Information

NOTE: This equipment has been tested and found to comply with the limits for a Class B digital device, pursuant to part 15 of the FCC rules. These limits are designed to provide reasonable protection against harmful interference in a residential installation. This equipment generates, uses and can radiate radio frequency energy and, if not installed and used in accordance with the instructions, may cause harmful interference to radio or television reception, which can be determined by turning the equipment off and on, the user is encouraged to try to correct the interference by one or more of the following measures:

- Reorient or relocate the receiving antenna.
- Increase the separation between the equipment and receiver.
- Connect the equipment into an outlet on a circuit different from that to which the receiver is connected.
- Consult the dealer or an experienced radio/TV technician for help.

Caution: Changes or modifications not expressly approved by Lutron Electronics Co. could void the user's authority to operate this equipment.

Operation

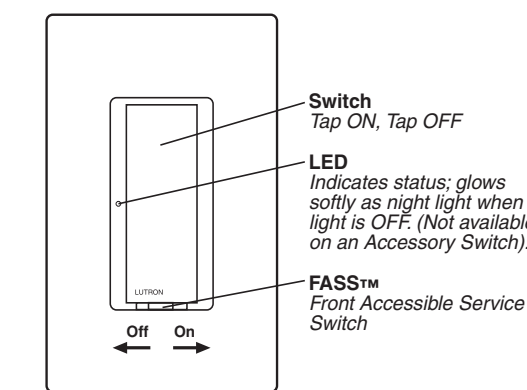

IMPORTANT NOTICE:
FASS™ - Front Accessible Service Switch - to replace bulb, power may be conveniently removed by sliding FASS™ switch to the left, on both the *Switch* and any *Accessory Switches*. For any procedure other than routine lamp replacement, power must be disconnected at the main electrical panel.

For detailed instructions on programming your switch, refer to the **RadioRA® Setup Guide** that is included with an **RF Signal Repeater**.

Technical Assistance

If you have questions concerning the installation or operation of this product, call the **Lutron Technical Support Center**. Please provide exact model number when calling.
(800) 523-9466 (U.S.A., Canada, and the Caribbean)
Other countries call (610) 282-3800
Fax (610) 282-3090
Visit our web site at www.lutron.com

Limited Warranty

Lutron will, at its option, repair or replace any unit that is defective in materials or manufacture within one year after purchase. For warranty service, return unit to place of purchase or mail to Lutron at 7200 Suter Rd., Coopersburg, PA 18036-1299, postage pre-paid.
THIS WARRANTY IS IN LIEU OF ALL OTHER EXPRESS WARRANTIES, AND THE IMPLIED WARRANTY OF MERCHANTABILITY IS LIMITED TO ONE YEAR FROM PURCHASE. THIS WARRANTY DOES NOT COVER THE COST OF INSTALLATION, REMOVAL OR REINSTALLATION, OR DAMAGE RESULTING FROM MISUSE, ABUSE, OR IMPROPER OR INCORRECT REPAIR, OR DAMAGE FROM IMPROPER WIRING OR INSTALLATION. THIS WARRANTY DOES NOT COVER INCIDENTAL OR CONSEQUENTIAL DAMAGES. LUTRON'S LIABILITY ON ANY CLAIM FOR DAMAGES ARISING OUT OF OR IN CONNECTION WITH THE MANUFACTURE, SALE, INSTALLATION, DELIVERY, OR USE OF THE UNIT SHALL NEVER EXCEED THE PURCHASE PRICE OF THE UNIT.
This warranty gives you specific legal rights, and you may also have other rights which vary from state to state. Some states do not allow limitations on how long an implied warranty lasts, so the above limitation may not apply to you. Some states do not allow the exclusion or limitation of incidental or consequential damages, so the above limitation or exclusion may not apply to you. This product may be covered under one or more of the following U.S. patents: 4,835,343; 4,954,768; 5,248,919; 5,399,940; 5,637,930; 5,736,965; 5,798,581; 5,838,226; 5,848,054; 5,905,442; 5,982,103; DES 353,798; DES 378,814; DES 389,461; DES 389,805; DES 395,037; DES 404,013; DES 422,969; DES 428,855; DES 436,579; DES 439,220 and corresponding foreign patents. U.S. and foreign patents pending. Lutron, Claro, and RadioRA are registered trademarks, and FASS is a trademark of Lutron Electronics Co., Inc.
© 2001 Lutron Electronics Co., Inc.

Lutron Electronics Co., Inc.
7200 Suter Road
Coopersburg, PA 18036-1299, U.S.A.
Made and printed in the U.S.A. 8/01 P/N 044-010 Rev. A

RadioRA®
Wireless Home Lighting Control

Installation Instructions for Multi-Location Control

Please Leave for Occupant

Before installation read instructions completely.

Important Notes

- 1. Caution:** To avoid overheating and possible damage to other equipment, do not use to control receptacles, motor-operated or transformer-supplied appliances.
2. Install in accordance with all national and local electrical codes.
3. Do not paint switches or wallplates.
4. **Clean with a soft damp cloth only.** Do not use any chemical cleaners.
5. This product requires a neutral wire in the wallbox. If a neutral wire is not present, contact a licensed electrician for installation.
6. Do not use where total wattage is under 5 watts.
7. Do not exceed maximum load rating of switches.
8. In any 3-way/4-way circuit use only one *Switch* with up to 9 *Accessory Switches*.
9. Switch may not work with dimmed lamps (Sylvania Designer 16™ or Philips PAR-16™).
10. Operate in ambient temperatures between 0°C (32°F) and 40°C (104°F).
11. Switch may feel warm to the touch during normal operation.
12. Recommended wallbox depth is 2 1/2" minimum.
13. The range and performance of the RadioRA® System is highly dependent on a variety of complex factors such as:
 - Distance between system components
 - Geometry of the home
 - Construction of walls separating system components
 - Electrical equipment located near system components
14. Do not mix RadioRA® "A" and "B" frequency products within the same system. Products with different frequencies **are not** compatible.

Electronic Switch
RAS-8LM, RBS-8LM

Accessory Switch
RA-AS, RB-AS

120/127VAC, 50/60Hz

Installation Contents

Single-Location Installation

Installing one RadioRA® *Switch* to control light(s) from a single location.

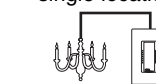

Page 2

Two-Location Installation

Installing one RadioRA® *Switch* and one *Accessory Switch* to control light(s) from two locations.

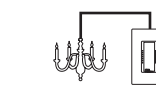

Page 4

Three-Location Installation

Installing one RadioRA® *Switch* and two *Accessory Switches* to control light(s) from three locations.

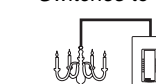

Page 6

Multi-Location Installation

For installations beyond Three-Location, call the **Lutron Technical Support Center** at 1-800-523-9466.

Operation

Using the RadioRA® *Switch*.

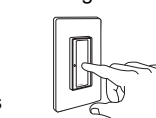

Page 8

Danger: This device must not be used to control equipment which is not visible from every control location. It also must not be used to control equipment which could create hazardous situations such as entrapment if operated accidentally. Examples of equipment which must not be controlled by this device include (but are not limited to) motorized gates, garage doors, industrial doors, and microwave ovens, heating pads, etc. It is the installer's responsibility to ensure that the equipment being controlled is visible from every control location and that only suitable equipment is connected to this device.

LUTRON®

Multigang Installations

Lutron Claro® wallplates are available in 1 to 6 gang versions. Purchase Claro® multigang wallplates separately. When combining switches in the same wallbox, remove all inner side sections prior to wiring. Using pliers, bend side sections up and down until they break off.

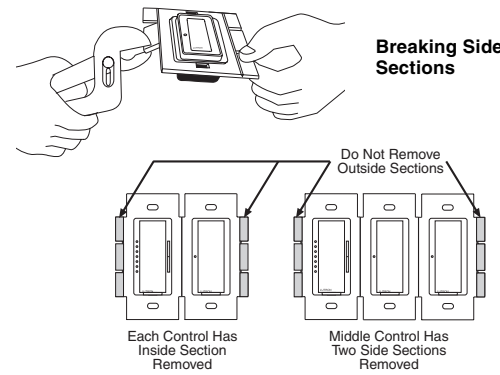

When removing side sections for multigang installations, reduction of the switches load capacity is required. See table below.

Model Number	No sides removed	1 side removed	2 sides removed
RAS-8LM, RBS-8LM	8A	6A	4.5A

Single-Location Installation

For installations involving more than one switch in a wallbox, refer to Multigang Installations above before beginning.

✓ **Check off Steps as completed.**

Step 1 Turn power OFF at circuit breaker or remove fuse.

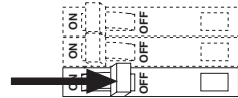

Step 2 Remove wallplate. Pull switch from wall.

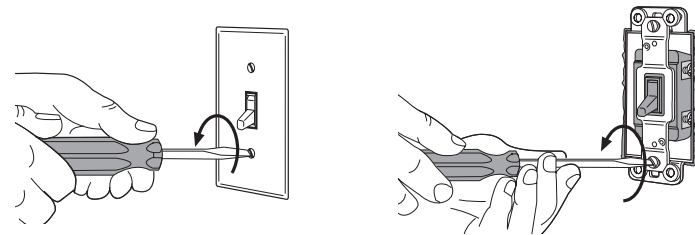

Step 3 Disconnect wires.

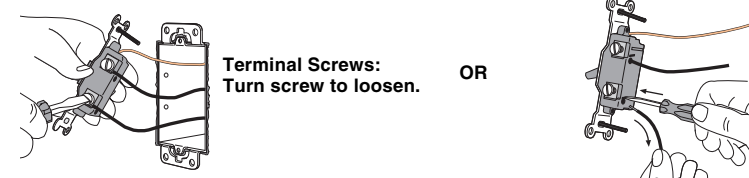

Important Wiring Information

When making wire connections, follow the recommended strip lengths and combinations for the supplied wire connectors. **Note:** Wire connectors provided are suitable for **copper wire only**. For aluminum wire, consult an electrician.

Small:
Strip insulation 3/8" for 14 AWG wire
Strip insulation 1/2" for 16 or 18 AWG wire
Use to join one 14 AWG supply wire with one 16 or 18 AWG control wire.

Large:
Strip insulation 1/2" for 10, 12 or 14 AWG wire
Strip insulation 5/8" for 16 or 18 AWG wire
Use to join one or two 12 or 14 AWG supply wires with one 10, 12, 14, 16, or 18 AWG control wire.

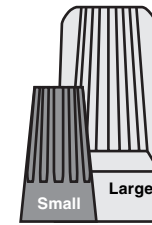

Twist wire connector tight. Be sure no bare wire is exposed.



Step 4 Wire the Switch.

Using the wire connectors provided:

- Connect the **Switch green** ground wire to the ground wire in the wallbox. If there is no ground wire in your wallbox, consult an electrician.
- Connect the **Switch white** wire to the neutral wire in the wallbox.
- Connect the **Switch black** wire to Hot (the wire leading to the circuit breaker or fusebox).
- Connect the **Switch red** wire to the Load (wire leading to the light fixture(s)).
- Cap off the **Switch blue** wire. It is not needed for a Single-Location Installation.

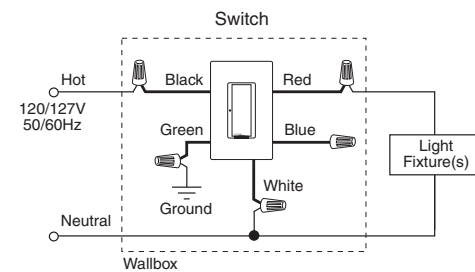

Step 5 Mount and align switch. Attach Claro® wallplate (purchased separately).

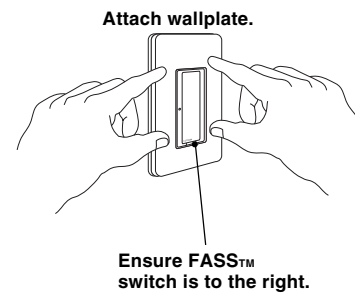
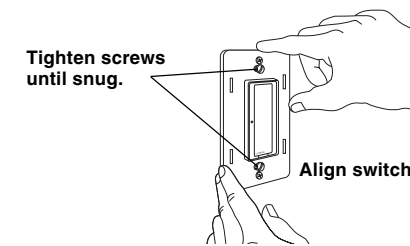

Step 6 Turn power ON.

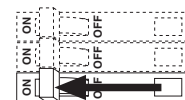

Two-Location Installation

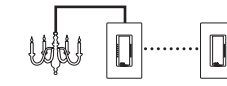

Replacing two 3-way switches.

For installations involving more than one switch in a wallbox, refer to Multigang Installations on page 2 before beginning.

✓ **Check off Steps as completed.**

Step 1 Turn power OFF at circuit breaker or remove fuse.

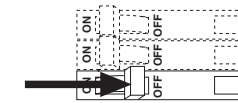

Step 2 Remove wallplates. Pull switches from wall.

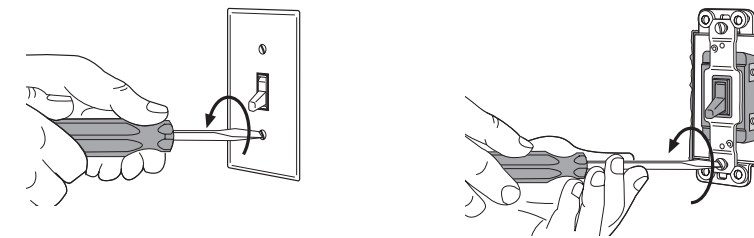

Step 3 Disconnect wires.

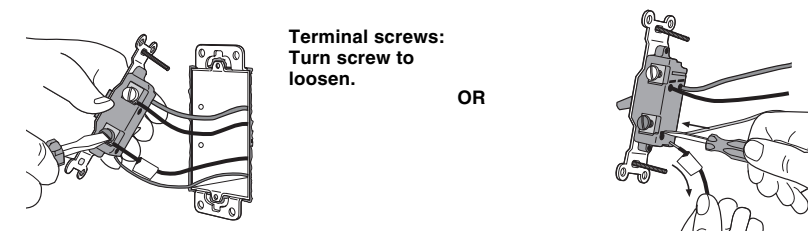

Important Wiring Information

When making wire connections, follow the recommended strip lengths and combinations for the supplied wire connectors. **Note:** Wire connectors provided are suitable for **copper wire only**. For aluminum wire, consult an electrician.

Small:
Strip insulation 3/8" for 14 AWG wire
Strip insulation 1/2" for 16 or 18 AWG wire
Use to join one 14 AWG supply wire with one 16 or 18 AWG control wire.

Large:
Strip insulation 1/2" for 10, 12 or 14 AWG wire
Strip insulation 5/8" for 16 or 18 AWG wire
Use to join one or two 12 or 14 AWG supply wires with one 10, 12, 14, 16, or 18 AWG control wire.

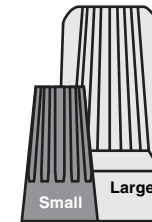

Step 4 Wiring the Switch with one Accessory Switch (3-way).

A) Wiring Switch on Feed side

- Connect each controls **green** ground wire to the ground wire in its wallbox. If there is no ground wire in your wallbox, consult an electrician.
- Connect the **Switch white** wire to the neutral wire in the wallbox.
- Connect the **Switch blue** wire to the **blue** wire on the **Accessory Switch**.
- Connect the **Switch black** wire to Hot (the wire leading to the circuit breaker or fusebox).
- Connect the **Switch red** wire to the **black** wire on the **Accessory Switch**.
- Connect the **Accessory Switch red** wire to the Load (wire leading to the light fixture(s)).

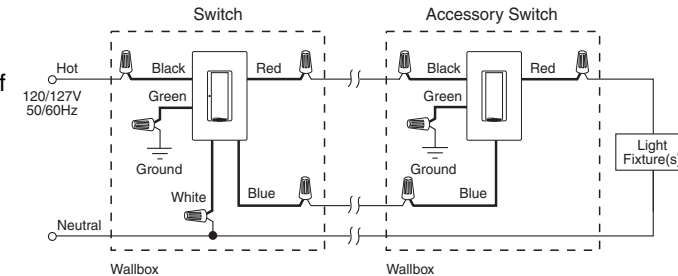

B) Wiring Switch on Load side

- Connect each controls **green** ground wire to the ground wire in its wallbox. If there is no ground wire in your wallbox, consult an electrician.
- Connect the **Accessory Switch blue** wire to the **blue** wire on the **Switch**.
- Connect the **Accessory Switch black** wire to Hot (the wire leading to the circuit breaker or fusebox).
- Connect the **Accessory Switch red** wire to the **black** wire on the **Switch**.
- Connect the **Switch red** wire to the Load (wire leading to the light fixture(s)).
- Connect the **Switch white** wire to the neutral wire in the wallbox.

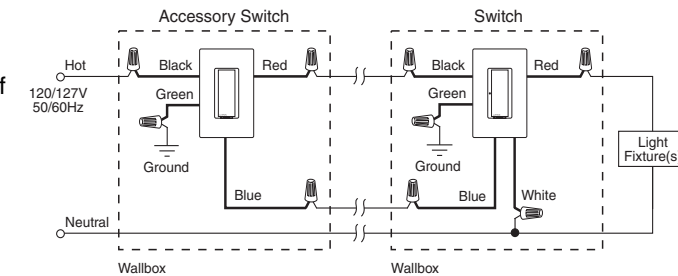

Step 5 Mount and align switches. Attach Claro® wallplates (purchased separately).

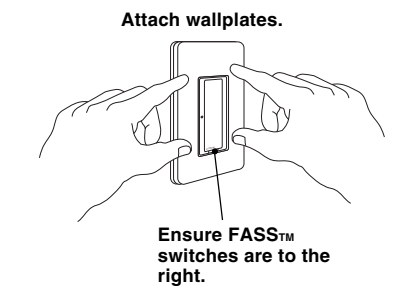
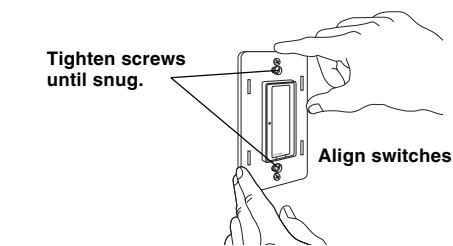

Step 6 Turn power ON.

