

Operation

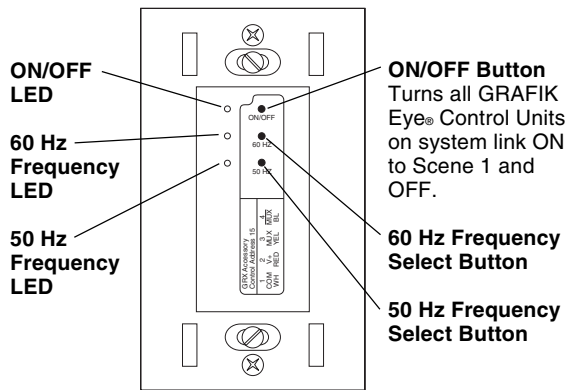

For detailed instructions on programming your RadioRA® GRAFIK Eye® Interface, refer to the RadioRA® Setup Guide that is included with an RF Signal Repeater.

Technical Assistance

If you have questions concerning the installation or operation of this product, call the **Lutron Technical Support Center**. Please provide exact model number when calling.
 (800) 523-9466 (U.S.A., Canada, and the Caribbean)
 Other countries call (610) 282-3800
 Fax (610) 282-3090
 Visit our web site at www.lutron.com

Troubleshooting

| Symptom | Possible Cause |
|--|---|
| GRAFIK Eye® Interface appears not to be working. | <ul style="list-style-type: none"> No power available to unit. GRAFIK Eye® unit on system link not 3000 or 4000 Series. Improper wiring. Interface not programmed. Improper line frequency selected. |

FCC Information

NOTE: This equipment has been tested and found to comply with the limits for a Class B digital device, pursuant to part 15 of the FCC rules. These limits are designed to provide reasonable protection against harmful interference in a residential installation. This equipment generates, uses and can radiate radio frequency energy and, if not installed and used in accordance with the instructions, may cause harmful interference to radio or television reception, which can be determined by turning the equipment off and on, the user is encouraged to try to correct the interference by one or more of the following measures:

- Reorient or relocate the receiving antenna.
- Increase the separation between the equipment and receiver.
- Connect the equipment into an outlet on a circuit different from that to which the receiver is connected.
- Consult the dealer or an experienced radio/TV technician for help.

Caution: Changes or modifications not expressly approved by Lutron Electronics Co. could void the user's authority to operate this equipment.

Limited Warranty

Lutron will, at its option, repair or replace any unit that is defective in materials or manufacture within one year after purchase. For warranty service, return unit to place of purchase or mail to Lutron at 7200 Suter Rd., Coopersburg, PA 18036-1299, postage pre-paid.

THIS WARRANTY IS IN LIEU OF ALL OTHER EXPRESS WARRANTIES, AND THE IMPLIED WARRANTY OF MERCHANTABILITY IS LIMITED TO ONE YEAR FROM PURCHASE. THIS WARRANTY DOES NOT COVER THE COST OF INSTALLATION, REMOVAL OR REINSTALLATION, OR DAMAGE RESULTING FROM MISUSE, ABUSE, OR IMPROPER OR INCORRECT REPAIR, OR DAMAGE FROM IMPROPER WIRING OR INSTALLATION. THIS WARRANTY DOES NOT COVER INCIDENTAL OR CONSEQUENTIAL DAMAGES. LUTRON'S LIABILITY ON ANY CLAIM FOR DAMAGES ARISING OUT OF OR IN CONNECTION WITH THE MANUFACTURE, SALE, INSTALLATION, DELIVERY, OR USE OF THE UNIT SHALL NEVER EXCEED THE PURCHASE PRICE OF THE UNIT.

This warranty gives you specific legal rights, and you may also have other rights which vary from state to state. Some states do not allow limitations on how long an implied warranty lasts, so the above limitation may not apply to you. Some states do not allow the exclusion or limitation of incidental or consequential damages, so the above limitation or exclusion may not apply to you.

This product may be covered under one or more of the following U.S. patents: 4,835,343; 4,954,768; 5,248,919; 5,399,940; 5,637,930; 5,736,965; 5,798,581; 5,838,226; 5,848,054; 5,905,442; 5,982,103; DES 353,798; DES 378,814; DES 389,461; DES 389,805; DES 395,037; DES 404,013; DES 422,969; DES 428,855; DES 436,579; DES 439,220 and corresponding foreign patents. Lutron, GRAFIK Eye, and RadioRA are registered trademarks of Lutron Electronics Co., Inc.
 © 2001 Lutron Electronics Co., Inc.

Lutron Electronics Co., Inc.
 7200 Suter Road
 Coopersburg, PA 18036-1299, U.S.A.
 Made and printed in the U.S.A. 8/01 P/N 044-012 Rev. A

LUTRON®

English

P/N 044-012

RadioRA®

Wireless Home Lighting Control

Installation Instructions for GRAFIK Eye® Interface

Please Leave for Occupant

Read all instructions completely before installation.

Important Notes

- Install in accordance with all national and local electrical codes.
- Do not paint controls or wallplates.
- Clean with a *soft damp cloth only*. Do not use any chemical cleaners.
- Operate in ambient temperatures between 0°C (32°F) and 40°C (104°F).
- Recommended wallbox depth is 2 1/2" minimum.
- This unit is compatible with GRAFIK Eye® 3000 and 4000 Series models only.
- The GRAFIK Eye® Interface uses accessory control address 15 on the GRAFIK Eye® system link. Ensure address 15 is not in use by another GRAFIK Eye® accessory control prior to installing the GRAFIK Eye® Interface.
- Only **one** GRAFIK Eye® Interface may be installed per GRAFIK Eye® system link. Interface commands are sent to **all** GRAFIK Eye® units on the same system link. Commands cannot solely be sent to an individual GRAFIK Eye® unit on a link of many GRAFIK Eye® units.
- For applications where GRAFIK Eye® controls are operated on generator power, the GRAFIK Eye® Interface may need to be powered using a 24 VAC power supply. Call the Lutron Technical Support Center (1-800-523-9466) for further details.
- The range and performance of the RadioRA® System is highly dependent on a variety of complex factors such as:
 - Distance between system components
 - Geometry of the home
 - Construction of walls separating system components
 - Electrical equipment located near system components

GRAFIK Eye® Interface

RA-GRXI
 RB-GRXI

Class 2 Device, 12 VDC or 24 VAC, 50/60 Hz

- Do not mix RadioRA® "A" and "B" frequency products within the same system. Products with different frequencies **are not** compatible.

Installation Contents

Installation

Installing a RadioRA® GRAFIK Eye® Interface.



Page 2

Operation

Using the RadioRA® GRAFIK Eye® Interface.

Page 4



DANGER

- Do not connect line voltage power to the GRAFIK Eye® Interface.
- Connecting line voltage power or improper wiring can result in personal injury or damage to the control or to other equipment.
- All external control equipment must maintain Class 2 isolation.

LUTRON®

Wall Mount Installation



For installing a GRAFIK Eye® Interface in a newly installed wallbox.

✓ **Check off Steps as completed.**

Step 1 Find a suitable location for the **GRAFIK Eye® Interface**. The GRAFIK Eye® Interface must be located within 30 feet of an RF Signal Repeater.

Step 2 Turn power off at circuit breaker panel or remove fuse from fusebox for **ALL GRAFIK Eye® Control Units**.

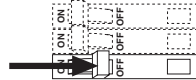

Important Wiring Information

When making wire connections, follow the recommended strip lengths and combinations for the supplied wire connectors. **Note:** Wire connectors provided are suitable for **copper wire only**. For aluminum wire, consult an electrician.

Strip insulation 3/8" for 14 AWG wire
Strip insulation 1/2" for 16, 18 or 20 AWG wire.

Use to join one 14, 16 or 18 AWG supply wire with one 16, 18 or 20 AWG control wire.

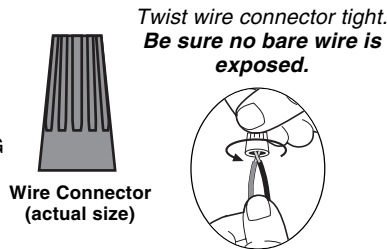

Step 3 Wire the Control.

Using the wire connectors provided:

- Connect the **white** wire to terminal 1 on the GRAFIK Eye® system link. (Common)
- Connect the **red** wire to terminal 2 on the GRAFIK Eye® system link. (+12 VDC)
- Connect the **yellow** wire to terminal 3 on the GRAFIK Eye® system link. (MUX)
- Connect the **blue** wire to terminal 4 on the GRAFIK Eye® system link. (MUX)

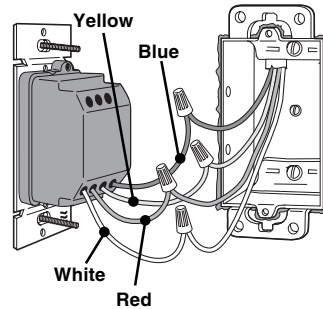

Wiring Diagram

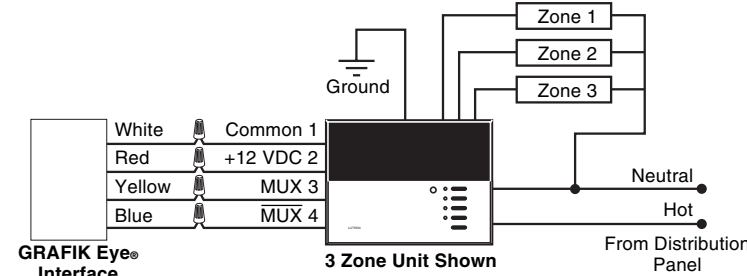

Note: A GRAFIK Eye® unit can supply power to no more than three (3) accessory controls. For more information on Class 2 wiring, see the GRAFIK Eye® 3000 Series Installer's Guide.

Step 4 Mount and align control.

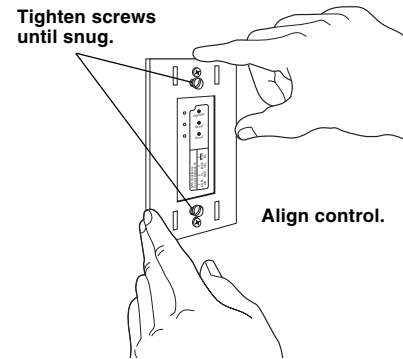

Step 5 Turn power ON.

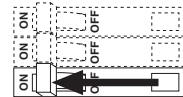

Step 6 Test wiring.

Push the ON/OFF button to ensure unit is wired correctly. All GRAFIK Eye® Units on the system link will turn ON to Scene 1. A second press will turn all the GRAFIK Eye® Units OFF. If the GRAFIK Eye® Units do not cycle ON/OFF, refer to Step 3 to verify wiring.

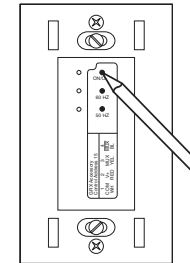

Step 7 Select frequency.

Note: If your power line frequency is 60 Hz (United States), skip this step and proceed to Step 8.

If your power line frequency is 50 Hz:

Press and hold the 50 Hz button until the 60 Hz LED turns OFF and the 50 Hz LED turns ON (approximately 3 seconds).

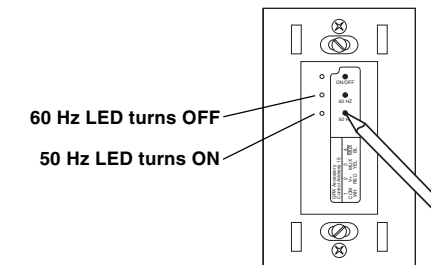

Step 8 Attach faceplate.

Snap on faceplate.

