

Troubleshooting

Symptom	Possible Cause	Solution
HHCD will not turn on.	<ul style="list-style-type: none"> • Dead, low, or no batteries. • Batteries are incorrectly installed. 	<ul style="list-style-type: none"> • Replace batteries. • Install batteries as indicated inside the HHCD.
	<ul style="list-style-type: none"> • Batteries are not making contact with the battery terminals. • Power button is not being held. 	<ul style="list-style-type: none"> • Adjust batteries so they make contact with the terminals. • Press and hold the Power button for 3 seconds.
Start LED will not begin flashing slowly.	<ul style="list-style-type: none"> • Enable or Disable is not selected. 	<ul style="list-style-type: none"> • Press and hold the Enable or Disable button, see Step 2 (page 3). • Enter Activate Controls Mode, see Step 3 (page 3).
Error LED is On and the Done LED is On.	<ul style="list-style-type: none"> • A Cordless Master Control has not been awakened yet. • A Master Control is unplugged. • A Master Control is out of system range. • A Master Control was removed from the system without being returned to factory default settings. 	<ul style="list-style-type: none"> • Wake up the Cordless Master Controls one at a time, see Step 6 (page 3). • Plug in all Master Controls and then press the Start button. • Move all Master Controls to within 30 feet (9 m) of an RF Signal Repeater and then press the Start button. • All Master Controls that were powered up during the Enable/Disable process have already saved their settings. Contact Lutron's Technical Support Center to free missing system addresses. • Replace the batteries and restart the Enable/Disable process.
Error LED is On and the Power LED is flashing.	<ul style="list-style-type: none"> • Batteries are low. 	
Error LED is On and the Start LED is flashing.	<ul style="list-style-type: none"> • The HHCD is out of system range. • The RF Signal Repeater or Chronos™ is unplugged. 	<ul style="list-style-type: none"> • Move the HHCD to within 30 feet (9m) of an RF Signal Repeater and then press the Start button on the HHCD. • Restore power to the RF Signal Repeater or Chronos and then press the Start button on the HHCD.

FCC Information

NOTE: This equipment has been tested and found to comply with the limits for a Class B digital device, pursuant to part 15 of the FCC rules. These limits are designed to provide reasonable protection against harmful interference in a residential installation. This equipment generates, uses and can radiate radio frequency energy and, if not installed and used in accordance with the instructions, may cause harmful interference to radio or television reception, which can be determined by turning the equipment off and on, the user is encouraged to try to correct the interference by one or more of the following measures:

- Reorient or relocate the receiving antenna.
 - Increase the separation between the equipment and receiver.
 - Connect the equipment into an outlet on a circuit different from that to which the receiver is connected.
 - Consult the dealer or an experienced radio/TV technician for help.
- Caution:** Changes or modifications not expressly approved by Lutron Electronics Co. could void the user's authority to operate this equipment.

Technical Assistance

If you have questions concerning the installation or operation of this product, call the **Lutron Technical Support Center**. Please provide exact model number when calling.

(800) 523-9466 (U.S.A., Canada, and the Caribbean)

Other countries call (610) 282-3900

Fax: (610) 282-3090

Visit our web site at www.lutron.com

Lutron Electronics Co., Inc.

7200 Suter Road

Coopersburg, PA 18036-1299, U.S.A.

Made and printed in the U.S.A. 10/03 P/N 044-036 Rev. A

Limited Warranty

Lutron will, at its option, repair or replace any unit that is defective in materials or manufacture within one year after purchase. For warranty service, return unit to place of purchase or mail to Lutron at 7200 Suter Rd., Coopersburg, PA 18036-1299 postage prepaid. THIS WARRANTY IS IN LIEU OF ALL OTHER EXPRESS WARRANTIES AND THE IMPLIED WARRANTY OF MERCHANTABILITY IS LIMITED TO ONE YEAR FROM PURCHASE. THIS WARRANTY DOES NOT COVER THE COST OF INSTALLATION, REMOVAL OR REINSTALLATION, OR DAMAGE RESULTING FROM MISUSE, ABUSE, OR IMPROPER OR INCORRECT REPAIR, OR DAMAGE FROM IMPROPER WIRING OR INSTALLATION. THIS WARRANTY DOES NOT COVER INCIDENTAL OR CONSEQUENTIAL DAMAGES, LUTRON'S LIABILITY ON ANY CLAIM FOR DAMAGES ARISING OUT OF OR IN CONNECTION WITH THE MANUFACTURE, SALE, INSTALLATION, DELIVERY, OR USE OF THE UNIT SHALL NEVER EXCEED THE PURCHASE PRICE OF THE UNIT.

This warranty gives you specific legal rights, and you may also have other rights which vary from state to state. Some states do not allow limitations on how long an implied warranty lasts, so the above limitation may not apply to you. Some states do not allow the exclusion or limitation of incidental or consequential damages, so the above limitation or exclusion may not apply to you.

This product may be covered under one or more of the following U.S. patents: 4,633,943; 4,934,768; 5,243,919; 5,339,940; 5,637,930; 5,736,965; 5,798,581; 5,886,226; 5,948,024; 5,905,442; 5,982,001; DES 3537,989; DES 3763,814; DES 3894,491; DES 3989,603; DES 3993,037; DES 4041,013; DES 422,969; DES 428,655; DES 456,379; DES 499,220 and corresponding foreign patents. U.S. and foreign patents pending. Lutron and RadioRA are registered Trademarks and Chronos is a trademark of Lutron Electronics Co., Inc.

© 2003 Lutron Electronics Co., Inc.

RadioRA®

Wireless Home Lighting Control

Installation and Operation Instructions for Hand-Held Configuration Device

Read all instructions completely before installation.



- NOTES:**
- The Hand-Held Configuration Device (HHCD) turns off after a short period of inactivity.
 - Press and hold the Power button to turn on the HHCD.

Important Notes

1. Use only high quality alkaline batteries, size AAA, 1.5 V. **Do not** use rechargeable batteries. Using improperly rated batteries could damage the device.
2. Clean device with a *soft damp cloth only*. Do not use any chemical cleaners.
3. Operate in ambient temperatures between 0°C (32°F) and 40°C (104°F).
4. Do not paint the device.
5. The range and performance of the RadioRA System is highly dependent on a variety of complex factors such as:
 - Distance between system components
 - Geometry of the home
 - Construction of walls separating system components
 - Electrical equipment located near system components
6. Do not mix RadioRA "A" and "B" frequency products within the same system. Products with different frequencies **are not** compatible.

Hand-Held Configuration Device

RA-HHCD-1
RB-HHCD-1

Batteries: 2 AAA Alkaline 1.5 V

Table of Contents

Battery Installation

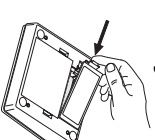

Frequency Selection

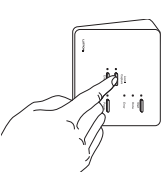

Operation

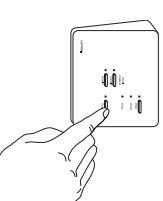

What is Level Capture?

Theory of Operation

Enabling or Disabling Level Capture

LUTRON®

Battery Installation

✓ Check off Steps as completed.

Step 1 Remove battery cover.

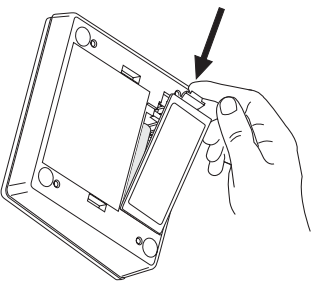

Step 2 Install batteries as shown. Use two, 1.5 V AAA alkaline batteries only.

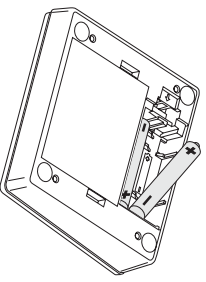

Step 3 Replace battery cover.

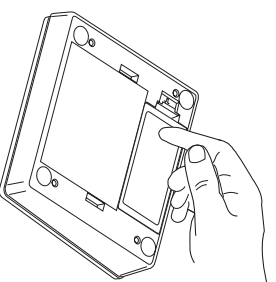

NOTES:

- The Hand-Held Configuration Device (HHCD) turns off after a short period of inactivity.
- Press and hold the Power button to turn on the HHCD.



Frequency Selection



The HHCD operates at 50 or 60 Hz. The product has been shipped in the 60 Hz mode. Continue with Steps 4 through 6 if you need to set the HHCD to 50 Hz.

Step 4 Begin frequency selection. To verify or change the device's operating frequency, enter the frequency select mode by simultaneously pressing the Start and Disable buttons for approximately 3 seconds.

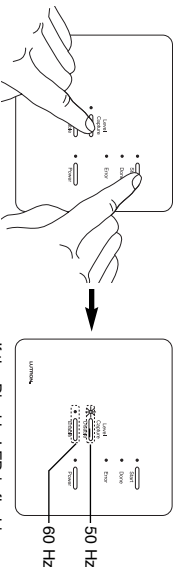

If the Disable LED is flashing, the device is set to 50 Hz. If the Enable LED is flashing, the device is set to 60 Hz.

Step 5 Change frequency. To change between modes, press and hold the button of the desired frequency.

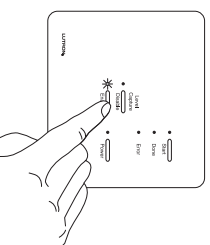

Step 6 Complete frequency selection. Exit the frequency selection mode by simultaneously pressing the Start and Disable buttons for approximately 3 seconds.

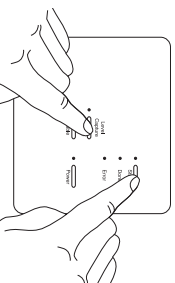

Operation

Hand-Held Configuration Device

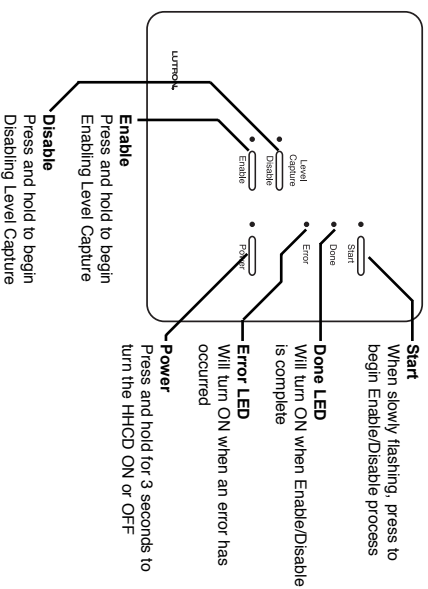

Enabling or Disabling Level Capture

Note: The Hand-Held Configuration Device (HHCD) should be located within 30 feet (9 m) of an RF Signal Repeater.

1. Press and hold the Power button for 3 seconds until the Power LED turns on.
2. To disable level capture, press and hold the Disable button until the Disable LED turns On. To enable level capture, press and hold the Enable button until the Enable LED turns On.
3. Press and hold the Activate Controls button on an RF Signal Repeater. Alternatively, with a Chronos™ as the Main Repeater, go to Main → System Setup → Activate Controls. The Start LED on the HHCD will begin flashing slowly.

4. Press the flashing Start button. The Start LED will begin flashing quickly and the system Repeaters will begin beeping.

5. Wait for the Done LED to turn ON (approximately 1 minute). All system devices will reset.

6. If the Error LED turns ON and the Done LED is ON, there are Cordless Master Controls asleep. Wake up one Cordless Master Control and wait for the Start LED to flash quickly before moving on to the next Cordless Master Control. When all Master Controls have been Enabled or Disabled, the Error LED will turn Off. For other Error LED states, refer to the Troubleshooting section of this instruction sheet.

7. Press and hold the Power button for 3 seconds to turn Off the HHCD.

Theory of Operation

By default, Level Capture is enabled on all Master Controls. There may be times when it is appropriate to not have level capture active. The Hand-Held Configuration Device (HHCD) can Enable or Disable level capture on all Master Controls in a RadioRA System. To Enable or Disable Level Capture, the Master Controls must already be programmed to a RadioRA System. After performing the Enable or Disable programming steps, all Master Controls will remember that setting. Returning a Master Control to default factory settings will Enable Level Capture.