

AuroRa® wireless lighting control

easy to use | simple to install | pre-programmed to work right out of the box

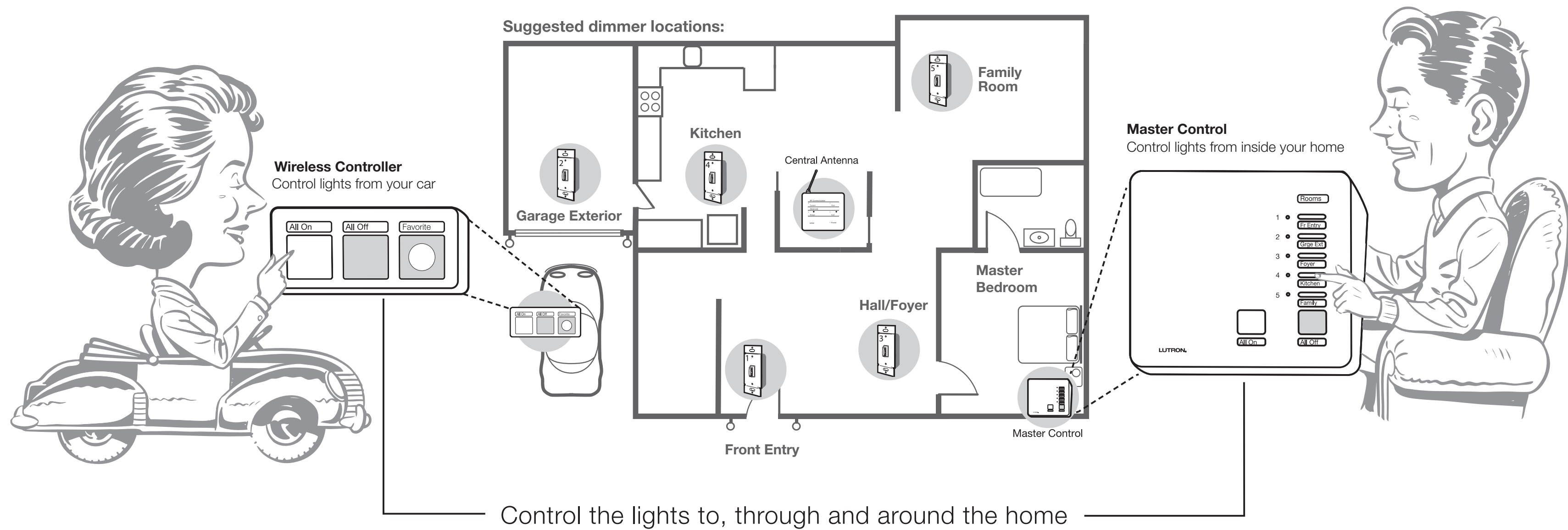

4 How to set up your system

Place location labels on Master Control.

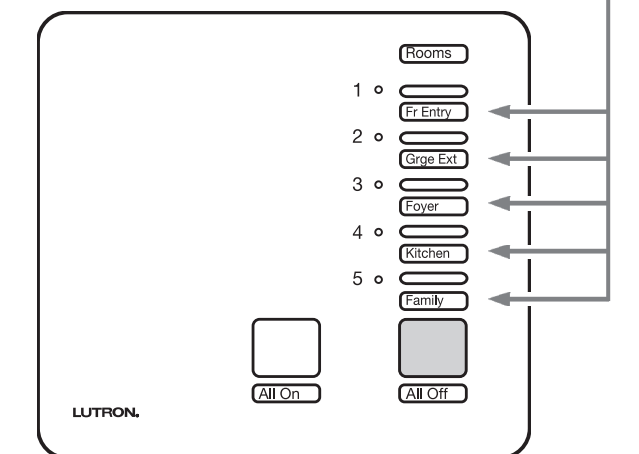

(suggested dimmer locations shown above)

Install dimmer #1 at button #1 location and dimmer #2 at button #2 location etc...

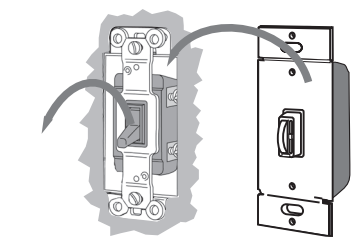

Plug in Master Control and place on tabletop in any desired room.

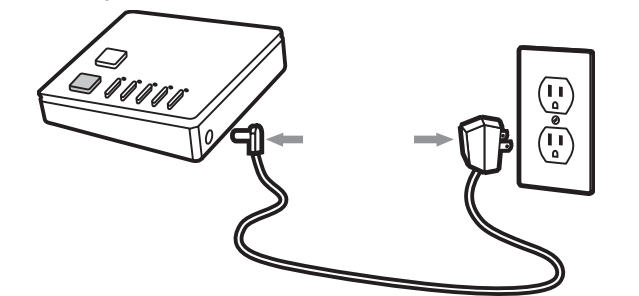

Centrally locate and plug in the central antenna.

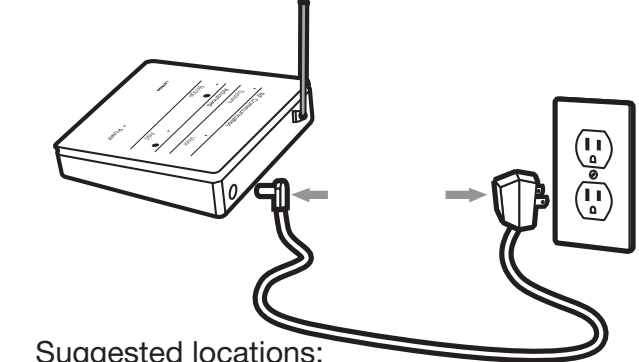

Suggested locations:

- hide under couch
- in cabinet above microwave
- under a table
- in a closet

Place wireless controller in the car, on a table or mount on a wall.



You're finished! Enjoy your AuroRa system.

1 How the Wireless Controller operates the dimmers in your home

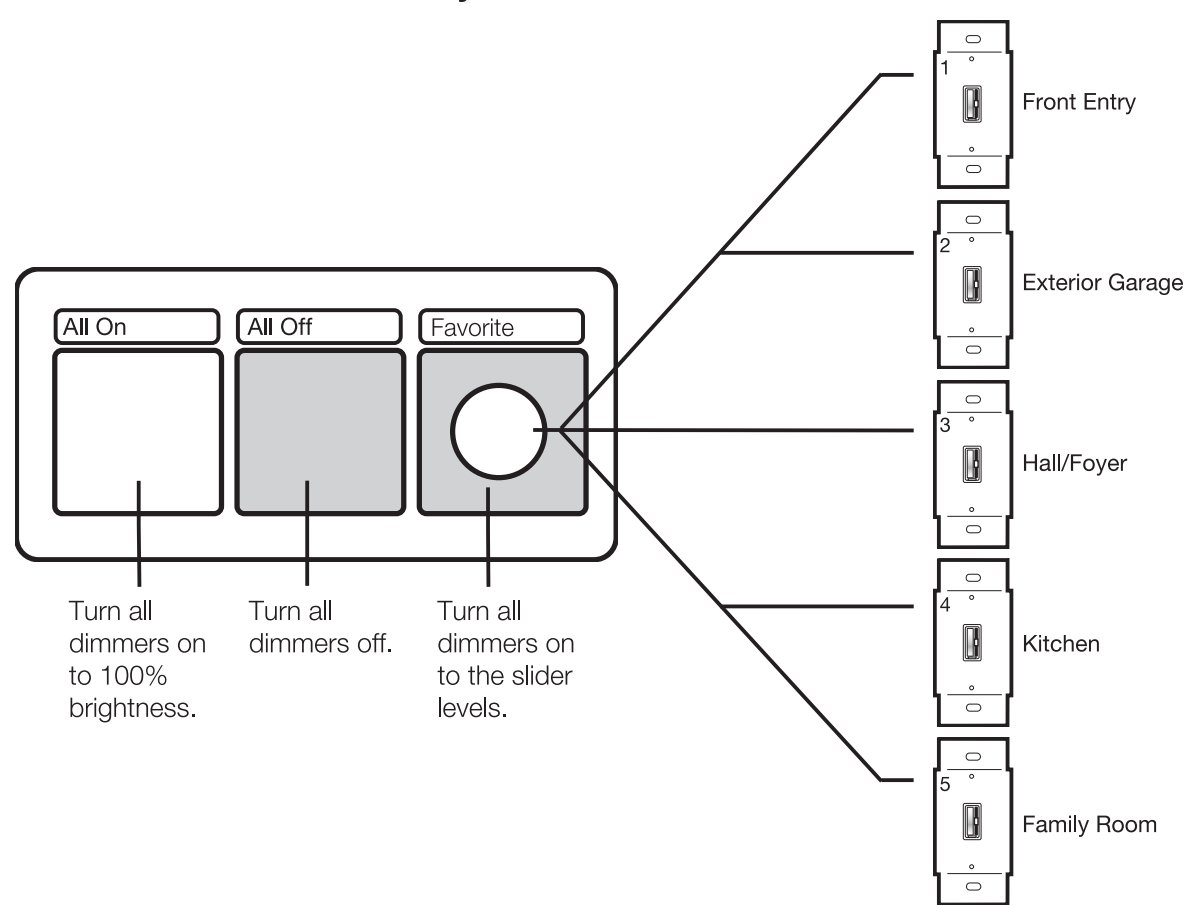

2 How to operate the Wall Dimmer

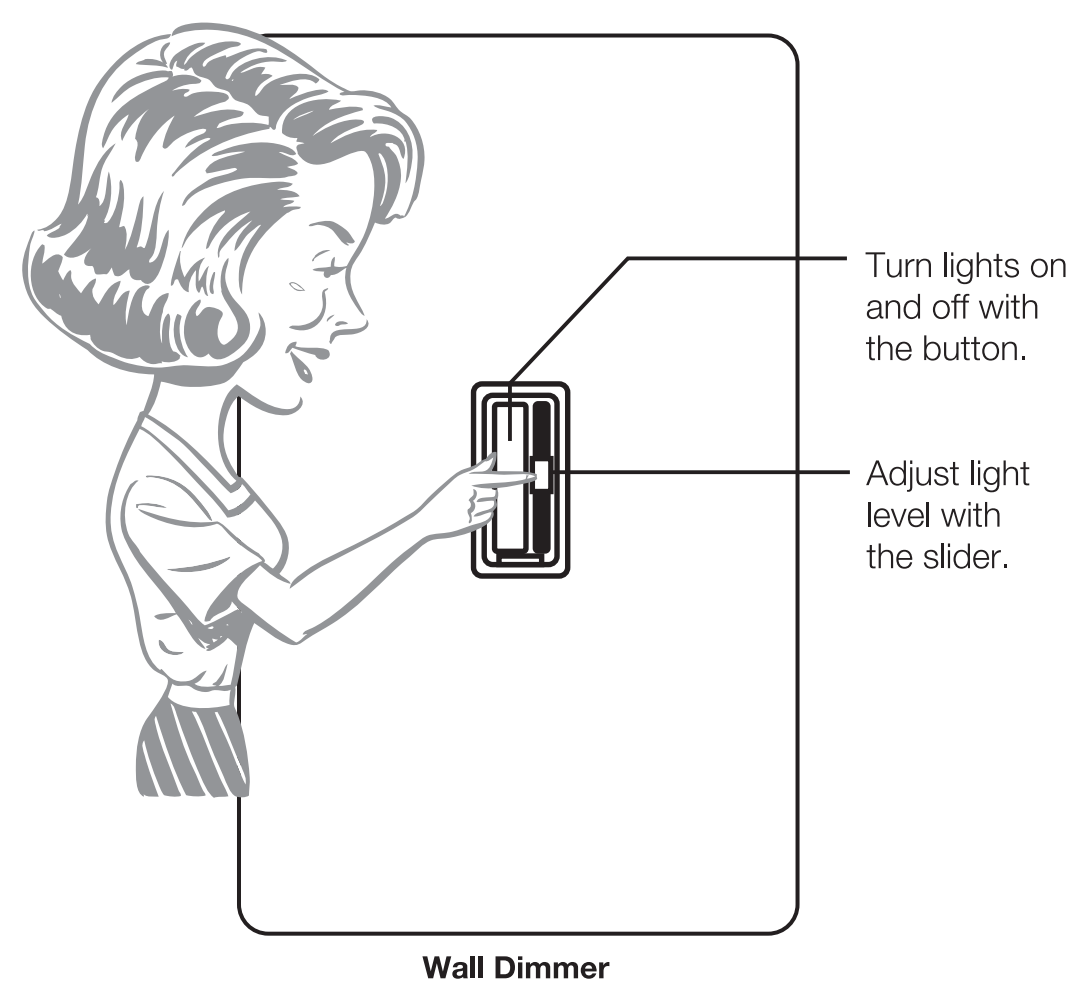

3 How the Master Control works dimmers individually or as a group

