

Operating Instructions

For detailed instructions, please refer to the *Installer's Guides* provided with each unit.

1 Set up communication between the GBO-RS232 and *GRAFIK Eye*® Control Unit.

- GBO-RS232.** Set DIP switch 1 to the **[ON]** position, leaving the other DIP switches in the **[OFF]** position. This will allow the Interface to communicate with the *GRAFIK Eye* Control Unit.

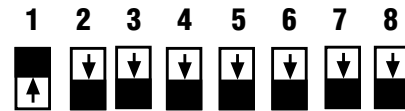

2 Assign the *GRAFIK Eye* Control Unit address [A1].

- Enter setup mode.** Press and hold Scene 1 and OFF buttons for about 3 seconds, until scene LEDs cycle.
- Select A- (the address display).** Press FADE ▲ once, A- appears in the FADE window.
- Assign address [A1].** Press MASTER ▲ once, the address [A1] will appear in the FADE window. This will be the Control Unit's address.
- Exit setup mode.** Press and hold Scene 1 and OFF buttons about 3 seconds, until the LEDs stop cycling.

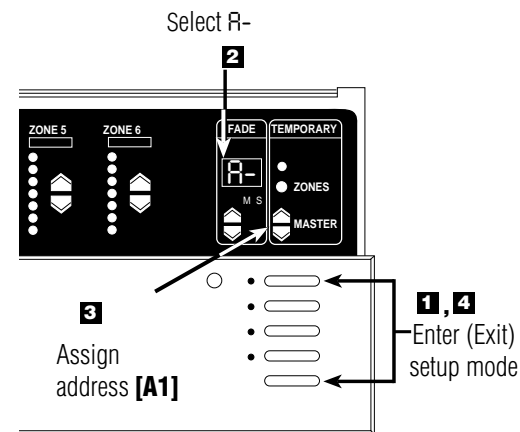

3 Set up communication between the *GRAFIK Eye* Control Unit and the NTGBO-4S-IR.

- Note:** DIP switches on the NTGBO-4S-IR must be in the default position as set at the factory (shown at right). This automatically assigns the unit address as **[1]** and programs the scenes as **[1-4]**.

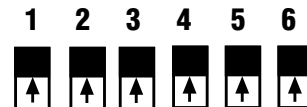

The **NTGBO-4S-IR** must be configured to **“talk”** in order to communicate with the *GRAFIK Eye* Control Unit.

1. Enter setup mode.

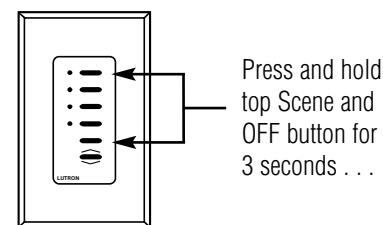

... LEDs cycle—Wallstation is “talking”

2. Make the Control Unit “listen.”

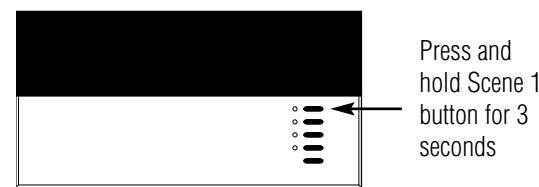

... LEDs flash in unison- Control Unit is “listening”

3. Take the Wallstation out of setup mode.

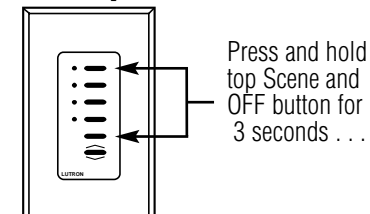

... LEDs stop cycling

4 Program the GRX-AV to “talk” to the *GRAFIK Eye* Control Unit.

- Set Dip switches 1, 2, 3, 7, & 8 to the **[ON]** position, and set DIP switches 4, 5, & 6 to the **[OFF]** position.

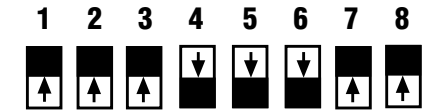

- Put the GRX-AV control in setup mode (“talk”).** Press and hold the program switch for 3-5 seconds until the first four Output Status LEDs begin to cycle.

2, 4 Enter(Exit) talk mode

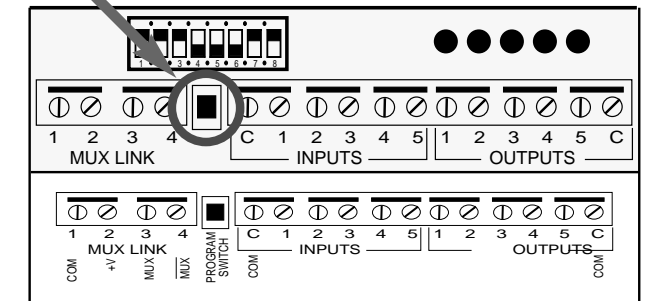

- Identify the *GRAFIK Eye* Control Unit to “listen” to this GRX-AV.** Press and hold the Control Unit's Scene 1 button for about 3 seconds until the four LEDs flash in unison, showing that this Control Unit is “listening”.

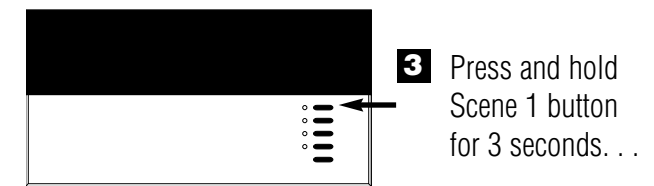

... LEDs flash in unison—Control Unit is “listening”

- Take the GRX-AV out of setup mode.** Press and hold the program switch for 3-5 seconds until the first Output Status LED stops cycling.

Internet: www.lutron.com
E-mail: product@lutron.com

WORLD HEADQUARTERS
Lutron Electronics Co., Inc.
TOLL FREE: (800) 523-9466
(U.S.A., Canada, Caribbean)
Tel: (610) 282-3800;
International 1-610-282-3800
Fax: (610) 282-1243;

GREAT BRITAIN
Lutron EA Ltd.,
Tel: (171) 702-0657;
International 44-207-702-0657
Fax: (171) 480-6899; I
International 44-207-480-6899

GERMANY
Lutron Electronics GmbH
Tel: (309) 710-4590;
International 49 309 710-4590
Fax: (309) 710-4591;
International 49 309 710-4591

ASIAN HEADQUARTERS
Lutron Asuka Corporation
Tel: (03) 5405-7333;
International 81-3-5405-7333
Fax: (03) 5405-7496;
International 81-3-5405-7496

HONG KONG SALES OFFICE
Lutron GL (Hong Kong)
Tel: 2104-7733;
International 852-2104-7733
Fax: 2104-7633;
International 852-2104-7633

SINGAPORE
Lutron GL (Singapore)
Tel: 65 220 4666; Fax: 65 220 4333
Lutron and *GRAFIK Eye* are registered trademarks of Lutron Electronics Co., Inc. *Bang & Olufsen* is a registered trademark and *Avant* is a trademark of Bang & Olufsen Holding A/S.
© 2000 Lutron Electronics Co., Inc.
P/N 030-686

LUTRON®