

Lutron Specification Submittal

RadioRA Switch Closure Interface

RA-SCI

Model No.: RA-SCI

Color: White

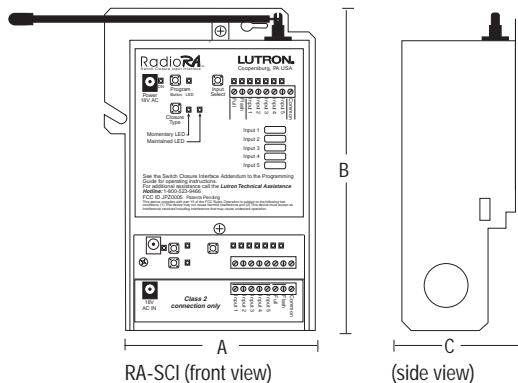

Dimensions

	in	mm
A	4.0	100
B	7.75	197
C	2.5	64

► Specifications

POWER	Input: 120/127VAC, 50/60Hz Output: AC 18V/300mA Class 2 Use only the AC adapter provided by Lutron
MOUNTING	Mounts on a 4" square utility box or flat on a wall
TEMPERATURE	32-104°F (0-40°C)
INPUTS	7 Inputs (2 security and 5 general) Switch closure: momentary or maintained, dry contact or open collector On Saturation Voltage: <1.0VDC @ 4mA On Leakage Current: <1.0µA @ 24VDC
SYSTEM MAX.	1 RA-SCI (Additional RA-SCI Interfaces may be added, but for each additional RA-SCI, the total number of Master Controls allowed in a system (12) will be reduced by one.)

► Function

- Integrates RadioRA controls and user-supplied switch closure equipment, such as audio/visual equipment, security systems, timeclocks, and motion detectors.
- Two dedicated security inputs allow a security system to turn lights on to full, or to flash.
- Five general purpose inputs allow external equipment to initiate RadioRA system functions, such as scene selection.

► Features

- Each general input can be programmed to accept a momentary or maintained switch closure.
- Momentary closures can be programmed to either activate a scene or turn on lights in one room. Maintained closures can be programmed to activate a scene when the closure occurs and turn the scene off when the closure opens.
- Local Dimmers, Switches, Master Controls, and GRAFIK Eye® Interfaces can be "locked out" whenever the security inputs are activated.

► **Switch Closure Interface Operation**

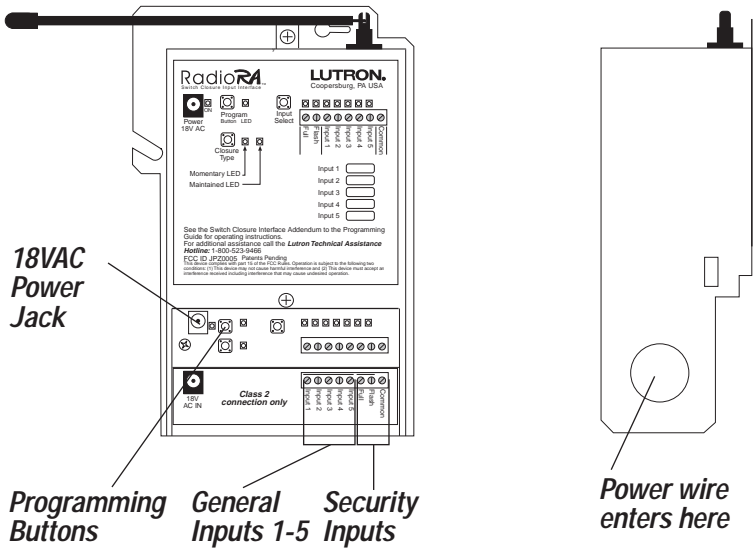

► **Installation**
Plug in using provided AC adapter

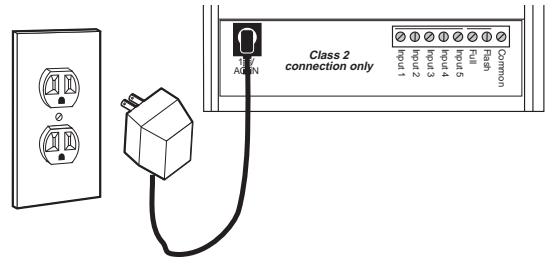

► **RadioRA System Overview**

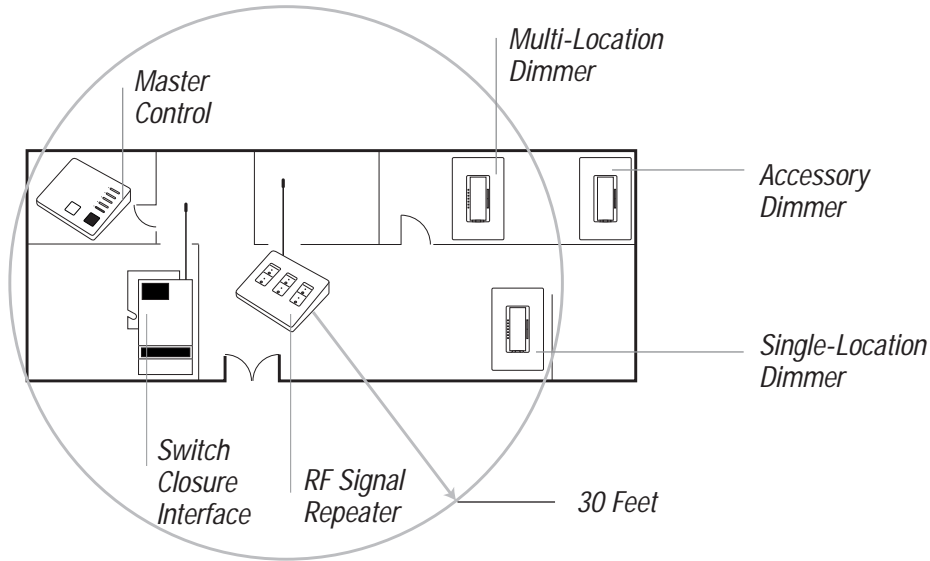

Notes:

- RadioRA Interfaces must be located within 30 feet of an RF Signal Repeater.

► **Limited Warranty**

Lutron will, at its option, repair or replace any unit that is defective in materials or manufacture within one year after purchase. For warranty service, return unit to place of purchase or mail to Lutron at 7200 Suter Rd., Coopersburg, PA 18036-1299, postage pre-paid. THIS WARRANTY IS IN LIEU OF ALL OTHER EXPRESS WARRANTIES, AND THE IMPLIED WARRANTY OF MERCHANTABILITY IS LIMITED TO ONE YEAR FROM PURCHASE. THIS WARRANTY DOES NOT COVER THE COST OF INSTALLATION, REMOVAL OR REINSTALLATION, OR DAMAGE RESULTING FROM MISUSE, ABUSE, OR IMPROPER OR INCORRECT REPAIR, OR DAMAGE FROM IMPROPER WIRING OR INSTALLATION. THIS WARRANTY DOES NOT COVER INCIDENTAL OR CONSEQUENTIAL DAMAGES. LUTRON'S LIABILITY ON ANY CLAIM FOR DAMAGES ARISING OUT OF OR IN CONNECTION WITH THE MANUFACTURE, SALE, INSTALLATION, DELIVERY, OR USE OF THE UNIT SHALL NEVER EXCEED THE PURCHASE PRICE OF THE UNIT. This warranty gives you specific legal rights, and you may also have other rights which vary from state to state. Some states do not allow limitations on how long an implied warranty lasts, so the above limitation may not apply to you. Some states do not allow the exclusion or limitation of incidental or consequential damages, so the above limitation or exclusion may not apply to you.

© 2001 Lutron Electronics Co., Inc.

Order P/N 366-416 for a complete set of RadioRA specification submittals. Printed in the U.S.A. 1/02