

LUTRON®

For Your Information ...

APPLICATION
NOTE

#48

Using the RadioRA® System to Activate Scenes 5 - 16 on a GRAFIK RA™ or GRAFIK Eye® Control Unit

Overview

Scenes 5 - 16 of a *GRAFIK RA* or *GRAFIK Eye* Control Unit may now be activated through the *RadioRA* System. After activating all system components (see the *RadioRA Setup Guide* Rev. C or later) and programming as described below, button pushes on a *RadioRA* Master Control will turn ON any Scene on a *GRAFIK RA* or *GRAFIK Eye* Control Unit (3000 or 4000 Series only), allowing greater flexibility to control all of the lights in your home.

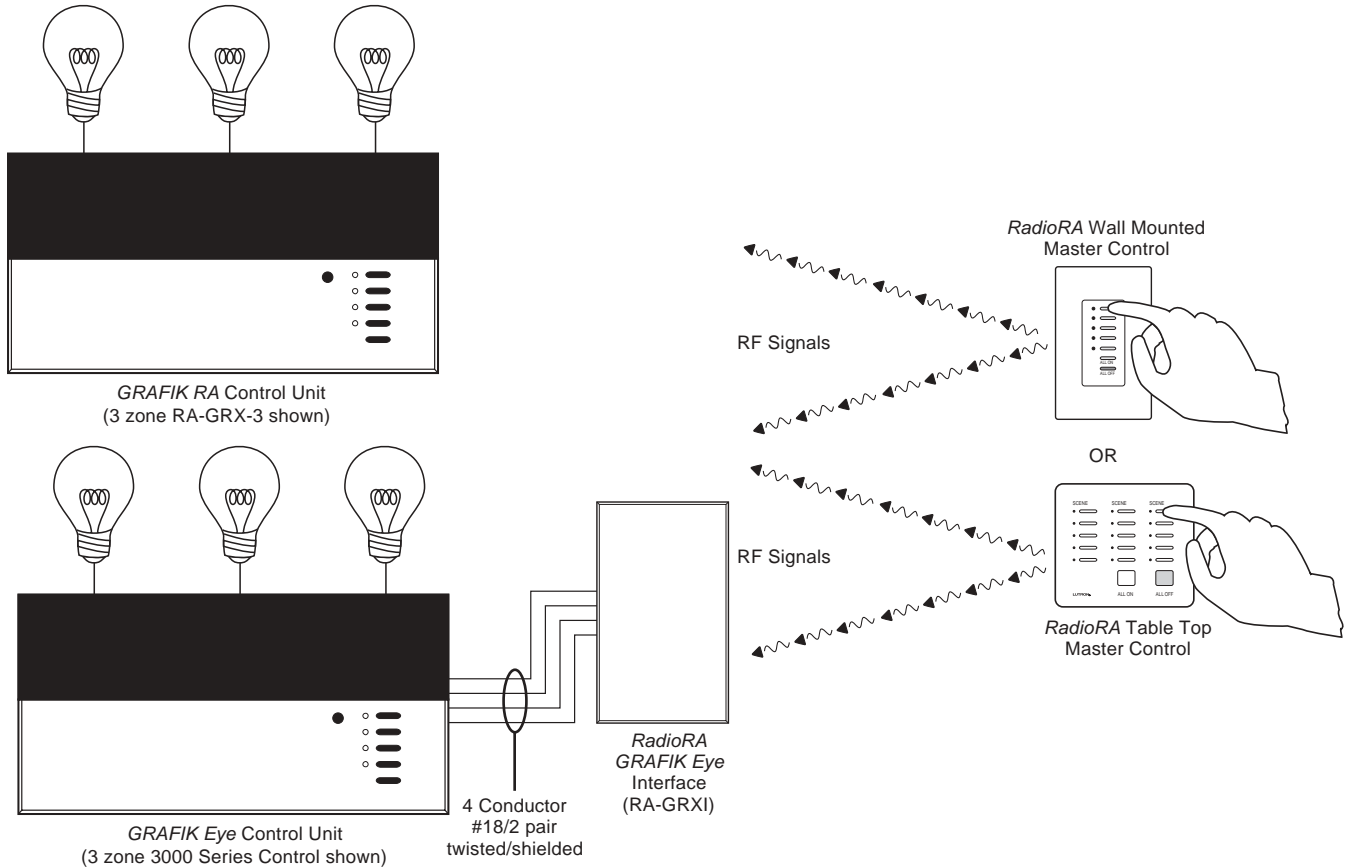

Programming

1. At the **GRAFIK RA** or **GRAFIK Eye** Control Unit, program the zone light levels for Scenes 5 - 16:

- Enter setup mode by simultaneously pressing the top and bottom buttons for approximately 3 seconds until the LEDs begin to chase downward.

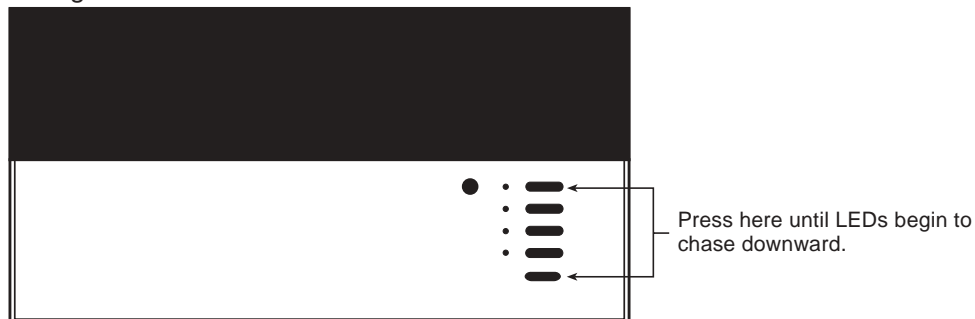

Need additional assistance? Call the Lutron Technical Support Center 1-800-523-9466
Please provide exact model number when calling.

- b. Press the FADE ▲ button once. A- will appear on the display. Press and release the MASTER ▲ button to select a unique address (A1 - A8) for this GRAFIK RA or GRAFIK Eye Control Unit. DO NOT select address A- .

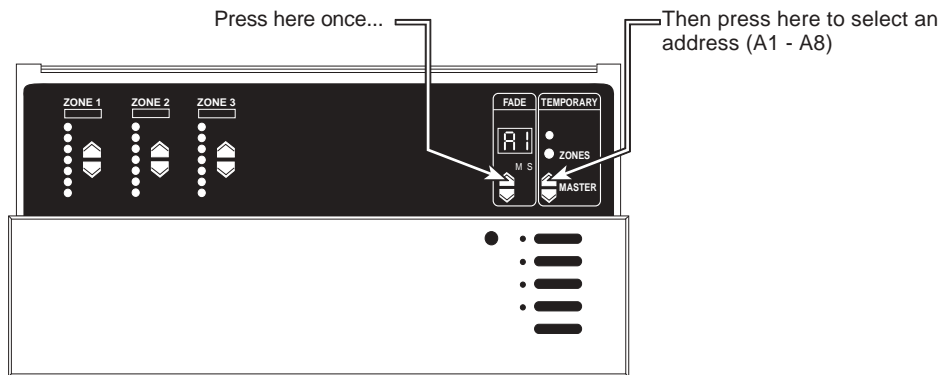

- c. Press the FADE ▲ button once again. The display will alternately flash Sc and 1. Press and release the Master ▲ or ▼ buttons to scroll through Scenes 5 - 16. The display will alternately flash Sc and the Scene Number to be programmed (ie. Sc and 5 for scene 5, Sc and 6 for scene 6, etc.).

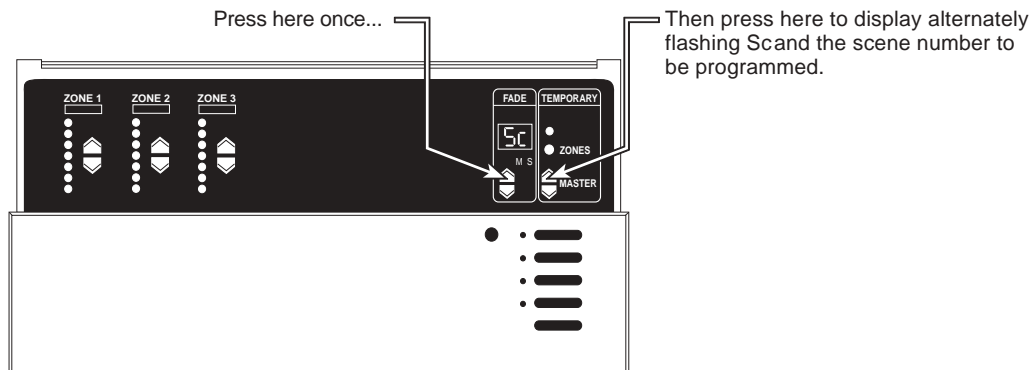

- d. Adjust the zone intensity for this scene using the ZONE ▲ or ▼ buttons for each zone.

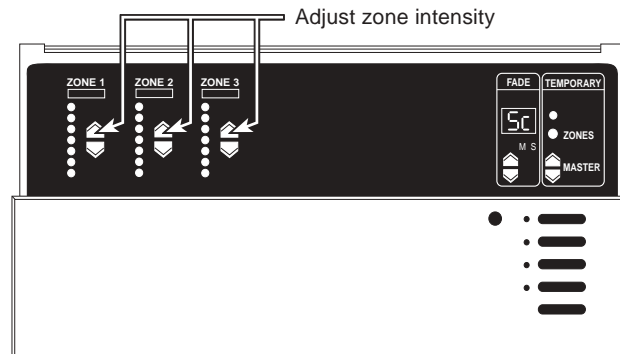

- e. Exit setup mode by simultaneously pressing the top and bottom buttons for approximately 3 seconds until the LEDs stop chasing downward.



2. At the **RadioRA Master Control**, setup the desired column of buttons to have the GRAFIK Scenes assigned as SCENE BUTTONS. See the *RadioRA Setup Guide*, Rev. C or later.
3. At the **RadioRA Master Control**, assign the *GRAFIK RA* or *GRAFIK Eye Control Unit(s)* to the desired buttons. See the *RadioRA Setup Guide*, Rev. C or later.
4. At the **RadioRA Master Control**, enter Setting Light levels mode by simultaneously pressing the 1st and 5th buttons in the right most column until the upper right LED begins to blink.



5. At the **RadioRA Master Control**, select the button which had the *GRAFIK RA* or *GRAFIK Eye Control Unit* assigned in Step 3. The button's LED will begin to blink and all *GRAFIK RA* or *GRAFIK Eye Control Units* assigned to that button will turn ON to Scene 1.

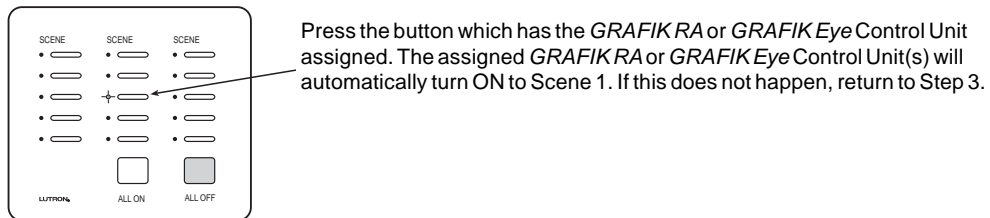

6. At the **GRAFIK RA** or **GRAFIK Eye Control Unit**, enter setup mode by simultaneously pressing the top and bottom buttons for approximately 3 seconds until the LEDs begin to chase downward.

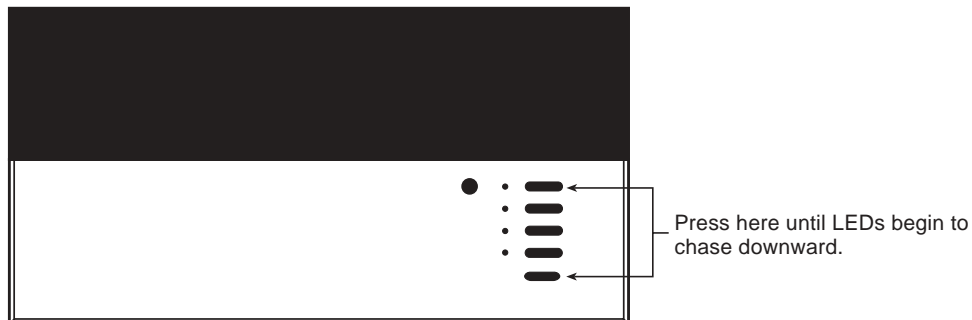

7. At the *GRAFIK RA* or *GRAFIK Eye Control* select Unit, the scene (5 - 16) to be programmed to the *RadioRA* Master Control button.

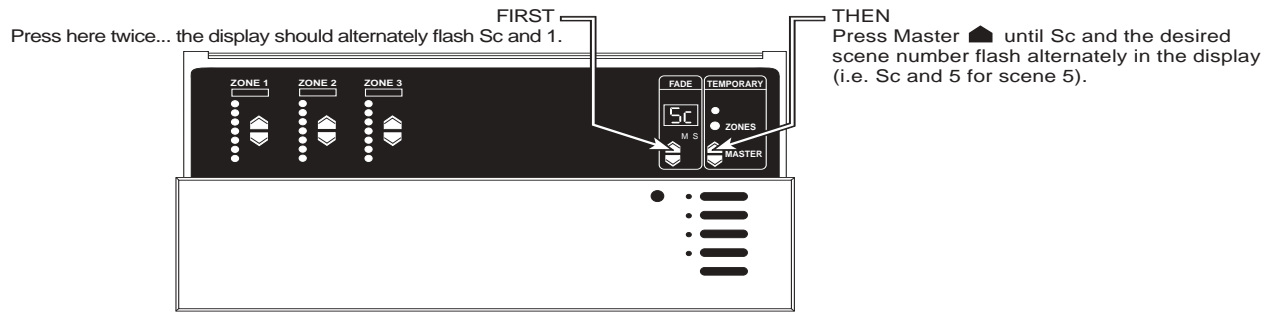

8. At the *RadioRA* Master Control, exit scene selection mode by simultaneously pressing the 1st and 5th buttons in the right most column until all LEDs begin to flutter. THIS STEP MUST BE COMPLETED BEFORE PROCEEDING TO STEP 9.

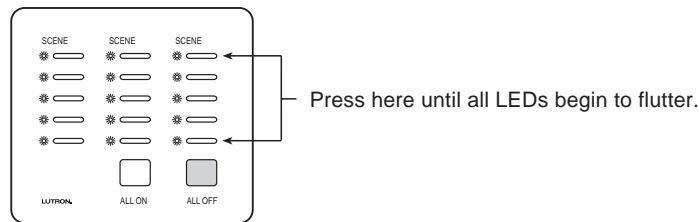

9. At the *GRAFIK RA* or *GRAFIK Eye Control* Unit, exit setup mode by simultaneously pressing the top and bottom buttons for approximately 3 seconds until the LEDs stop chasing.



You have successfully programmed your *RadioRA* Master Control to activate a Scene on your *GRAFIK RA* or *GRAFIK Eye Control* Unit. This process may be repeated for other buttons on your *RadioRA* Master Control(s).

Worldwide Technical and Sales Assistance

If you need assistance call the toll-free **Lutron Technical Support Center**. Please provide exact model number when calling.

(800) 523-9466 (U.S.A., Canada, and the Caribbean)
 Other countries call (610) 282-3800
 Visit our Website at www.lutron.com

Lutron Electronics Co., Inc.
 7200 Suter Road
 Coopersburg, PA 18036-1299 U.S.A.
 Phone: (610) 282-3800
 Fax: (610) 282-3090

Lutron, RadioRA, and GRAFIK Eye are registered trademarks and GRAFIK RA is a trademark of Lutron Electronics Co., Inc. © 1996 - 2002 Lutron Electronics Co., Inc.

**Need additional assistance? Call the Lutron Technical Support Center 1-800-523-9466
 Please provide exact model number when calling.**

Lutron Electronics Co., Inc.
 7200 Suter Road
 Coopersburg, PA 18036-1299 U.S.A.
 Made and printed in U.S.A. 6/02 P/N 366-730 Rev. C