

Button configurations

Updated Pico® Wireless Controls

Button configuration codes

Button Configuration	Code
2-button	2B
2-button with raise/lower	2BRL
3-button	3B
3-button with raise/lower	3BRL

Color Codes

Gloss Color	Code
 White	WH
 Black	BL
 Ivory	IV
 Light Almond	LA
 White/Gray	WG**

Button marking codes

2-button

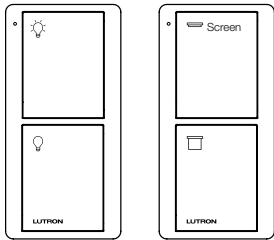

Light* (L01) Screen (S08)

2-button with raise/lower

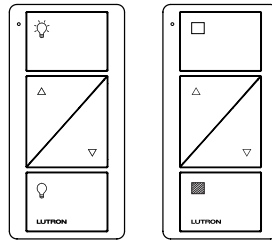

Light (L01) Shade (icons) (S01)

3-button

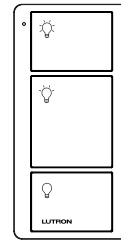

Light (L01)

3-button with raise/lower

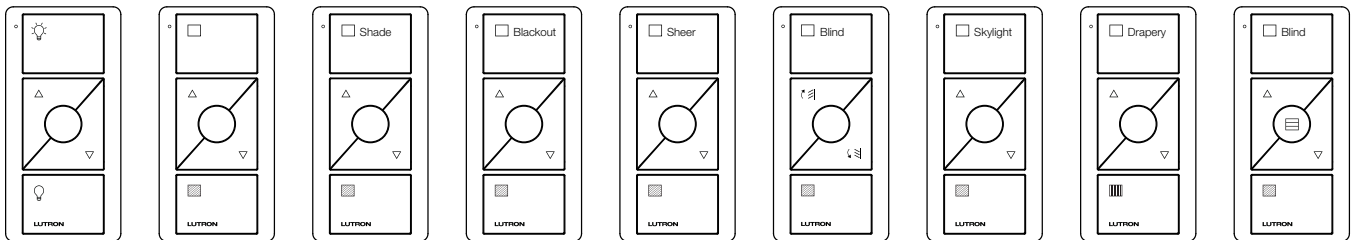

Light* (L01) Shade (icons) (S01) Shade (text) (S02) Blackout (S03) Sheer (S04) Blind (S05) Skylight (S06) Drapery (S07) Horizontal Sheer Blind (S09)

* Coming soon—Pico with nightlight will be available in 2-button (2B) or 3-button with raise/lower (3BRL) only

** On and Raise buttons are White; Preset, Lower, and Off buttons are Gray

www.lutron.com

World Headquarters 1.610.282.3800 | 24/7 Technical Support 1.800.523.9466 | Customer Service 1.888.LUTRON1 (1.888.588.7661)

© 11/2013 Lutron Electronics Co., Inc. | P/N 368-3412 REV A

