



Description

The SV-100SF-PI, see Figure 1, is a 24VAC, Class 2 plug-in transformer that is used with a *Sivoia* or *Sivoia QED* motorized window shade. The transformer provides enough power for one *Sivoia* or *Sivoia QED* Motor Drive Unit to operate a 100 square foot shade (225 square foot for a high torque Motor Drive Unit). The transformer is designed to be plugged into a standard 120VAC receptacle. The transformer contains a circuit breaker on the secondary side to protect the device in the event of a miswire.

-  **Caution** - All wiring must be in accordance with national and local electrical codes.
-  **Caution** - Do not short the output AC terminals.
-  **Caution** - Ensure that the earth ground is connected to the *Sivoia* or *Sivoia QED* Motor Drive Unit.

Installation

Note: Each transformer can power only **one** *Sivoia* or *Sivoia QED* Motor Drive Unit.

- 1. Run Motor Drive Unit power wiring to the transformer.** Run the low-voltage power and earth ground wiring from the Motor Drive Unit to the screw terminals on the secondary side of the transformer. See Figure 2.
- 2. Check that the output AC terminals are not shorted.**
- 3. Plug the transformer into a 120VAC receptacle.**
Note: If the Motor Drive Unit does not power up after plugging in the transformer, press the circuit breaker reset button located on the transformer.

Figure 1

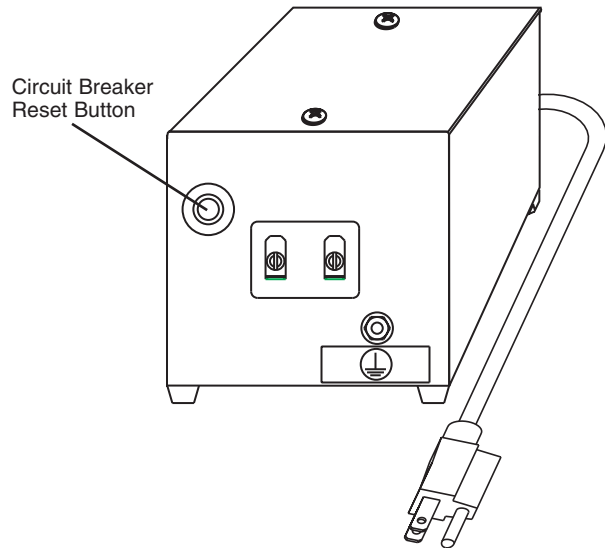

Power Wiring Types and Maximum Lengths

Type	Maximum Length
3 conductor #16 AWG	200 ft.
3 conductor #18 AWG	150 ft.
3 conductor #20 AWG	100 ft.
3 conductor #22 AWG	60 ft.

Figure 2

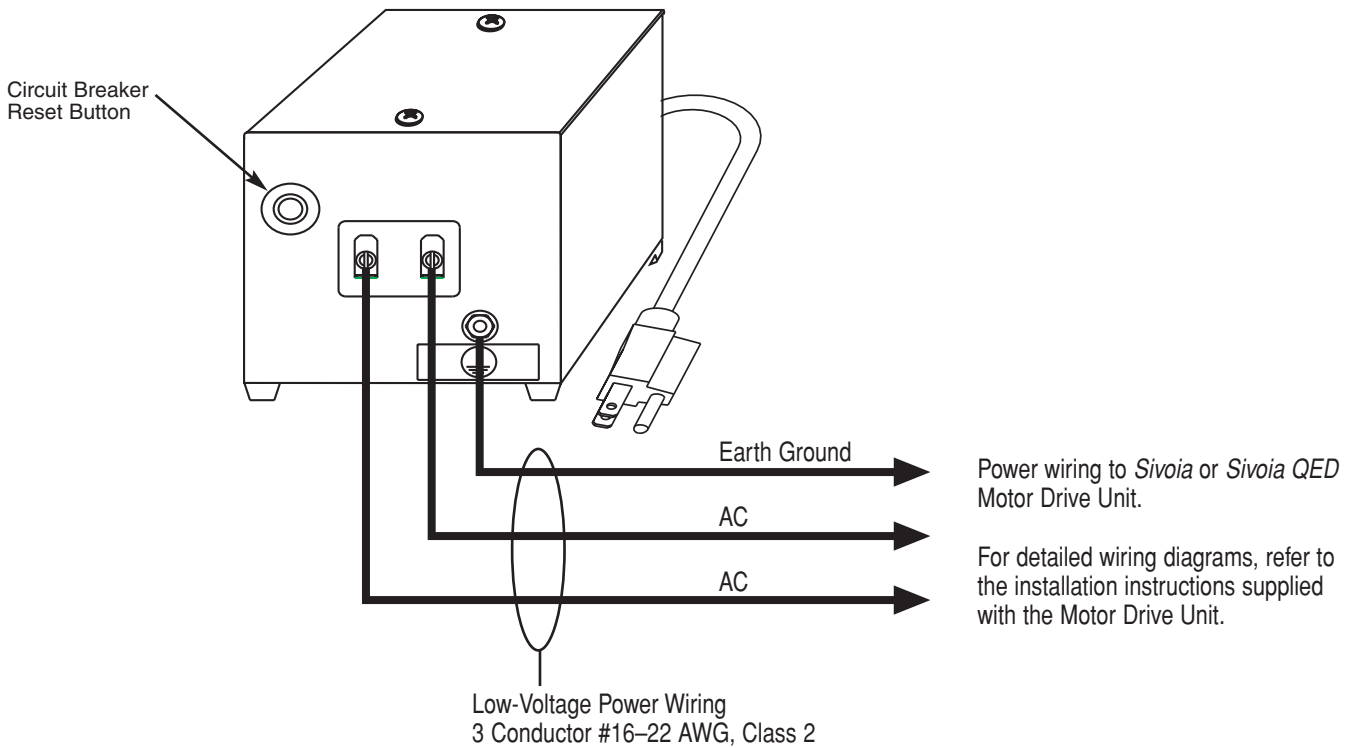

Technical Assistance

If you need assistance, call the toll-free **VIMCO Technical Support Center**. Please provide exact model number when calling.
(800) 446-1503 (U.S.A., Canada, and the Caribbean)
Other countries call (804) 752-3300
Fax (804) 752-3366
Visit our web site at www.vimco.com

Limited Warranty

VIMCO will, at its option, repair or replace any unit that is defective in materials or manufacture within one year after purchase. For warranty service, return unit to place of purchase or mail to VIMCO at 11520 Sun Shade Lane, Ashland, VA 23005, postage prepaid.

THIS WARRANTY IS IN LIEU OF ALL OTHER EXPRESS WARRANTIES, AND THE IMPLIED WARRANTY OF MERCHANTABILITY IS LIMITED TO ONE YEAR FROM PURCHASE. THIS WARRANTY DOES NOT COVER THE COST OF INSTALLATION, REMOVAL, OR REINSTALLATION, OR DAMAGE RESULTING FROM MISUSE, ABUSE, OR DAMAGE RESULTING FROM IMPROPER WIRING OR INSTALLATION. THIS WARRANTY DOES NOT COVER INCIDENTAL OR CONSEQUENTIAL DAMAGES. VIMCO'S LIABILITY ON ANY CLAIM FOR DAMAGES ARISING OUT OF OR IN CONNECTION WITH THE MANUFACTURE, SALE, INSTALLATION, DELIVERY, USE, REPAIR, OR REPLACEMENT OF THE SHADING SYSTEM SHALL NEVER EXCEED THE PRICE PAID FOR THE SYSTEM.

This warranty gives you specific legal rights, and you may also have other rights which vary from state to state. Some states do not allow the exclusion or limitation of incidental or consequential damages or limitations on how long an implied warranty may last, so the above limitations may not apply to you.

Lutron, Sivoia and the Sunburst logo are registered trademarks and Sivoia QED is a trademark of Lutron Electronics Co., Inc. VIMCO, and shading solutions by VIMCO are trademarks of Virginia Iron & Metal Company, Inc. © 2003 Virginia Iron & Metal Company, Inc.