

# WC-4M-GC/WC-2M-GC AC Motor Controller



## DESCRIPTION

- 4 channel (-4M) or 2 channel (-2M) AC Motor controller that accepts dry contact closure inputs from RadioTouch RF controllers (RTA-RX-F-SC or RTA-RX-F-347), keypads, building management systems, etc. to control AC Motorized Window Treatments or projection screens.

## Physical Design

- Wall mounted. Indoor use only.
- Weighs 6.7 pounds.

## Environment

- 32°F (0°C) to 104°F (40°C) operating temperature range
- Less than 90% relative humidity, non-condensing



## SPECIFICATIONS

### Power

- 110-127 V~, 60 Hz
- 20 A total input current

### Channel Capacity

- 5 A, 1/4 HP motor load per channel at 120 V~
- Never wire motors in parallel

### Key Design Features

- Provides Open, Close, and Stop terminals for contact closure inputs.
- Stop function may also be accomplished by applying Open and Close simultaneously.
- Control motors individually and/or all at once.
- Can accept either momentary or maintained contact closure inputs. Feature is configurable by a switch.
- Select which motor lead is up and down without re-wiring, with the flip of a switch.
- Provides local override buttons that activate motor outputs to test system wiring.
- Additional group controllers may be added to operate additional AC motorized window treatments or projection screens.
- Metal enclosure provides separate wiring compartments for line voltage and low voltage.

<p><b>JOB NAME:</b></p>	<p><b>MODEL NUMBERS:</b></p>
<p><b>JOB NUMBER:</b></p>	

**DIMENSIONS AND MOUNTING**

- Mount only where ambient temperature is between 32°F and 104°F (0-40°C)
- Allow 4.5" (114mm) between Group Controllers
- Unit's relays will click in normal use. Mount where this is acceptable.
- Mount unit in a location that is accessible to allow for system programming and setup.

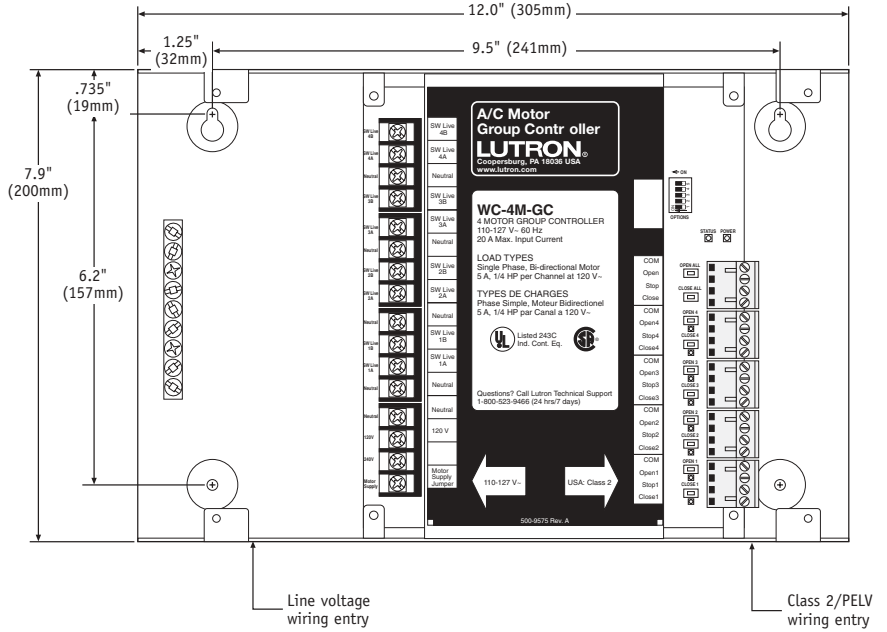

**SYSTEM DIAGRAM**

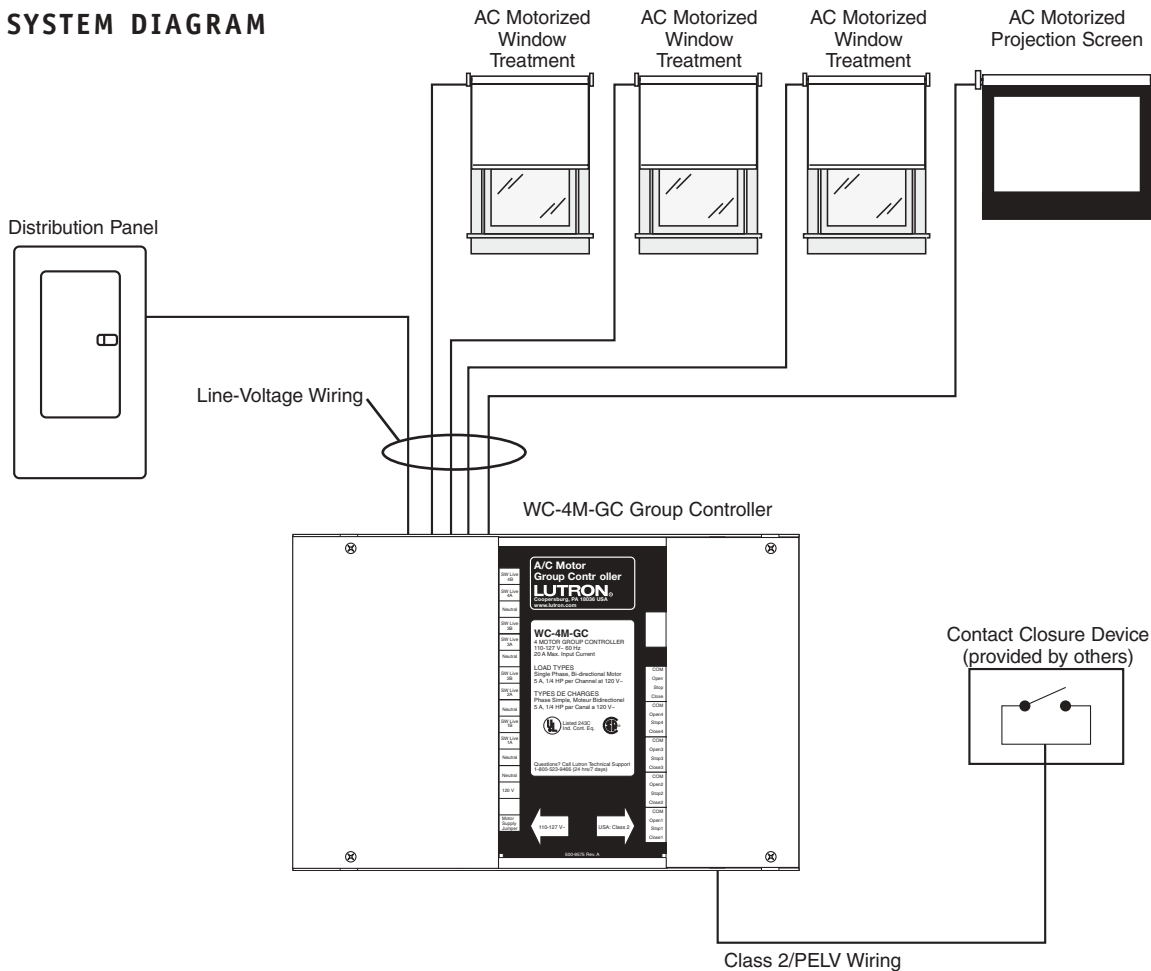

JOB NAME:	MODEL NUMBERS:
JOB NUMBER:	

**LINE VOLTAGE WIRING**

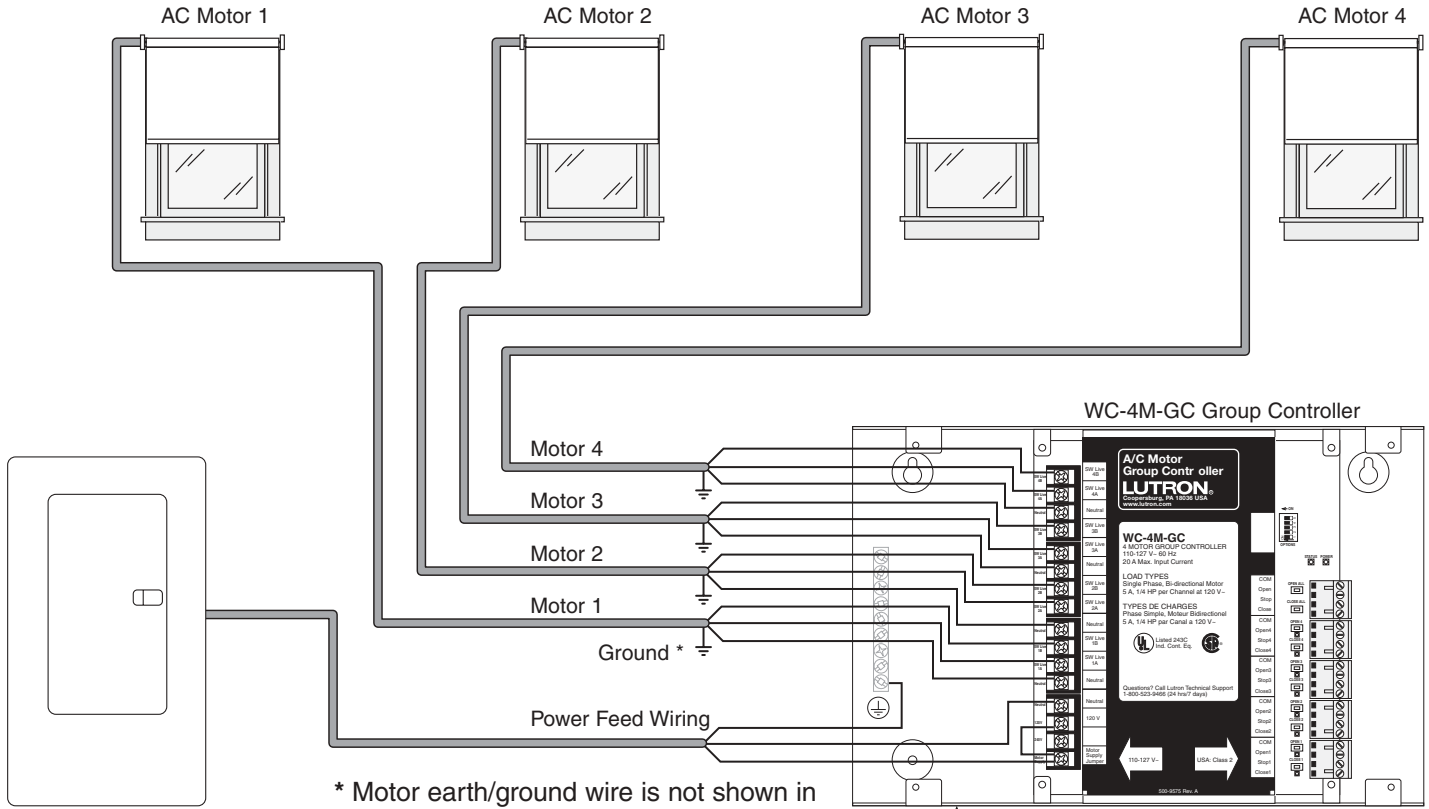

**CONTACT CLOSURE INPUT WIRING**

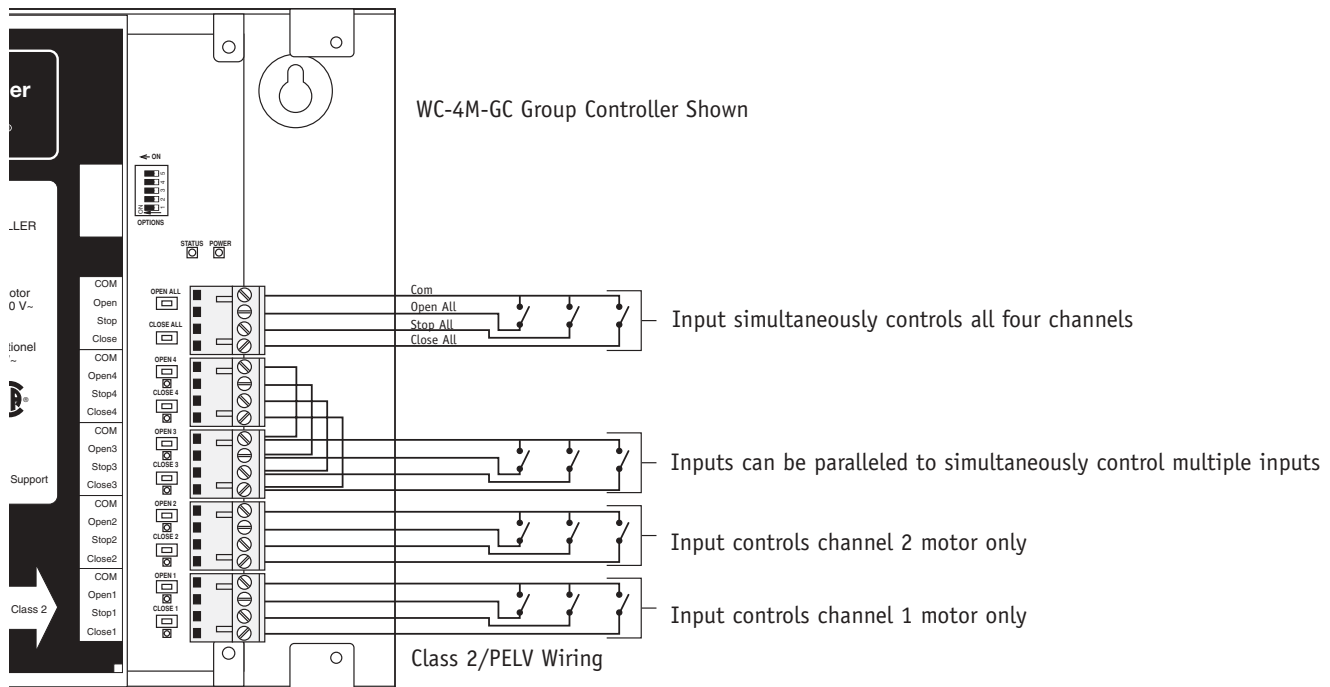

JOB NAME:	MODEL NUMBERS:
JOB NUMBER:	