

**NGRX-PB-WH  
ELVI-1000  
GRX-FDBI  
16A-120**

**HOMEWORKS<sup>®</sup> Electronic Interfaces**

**LUTRON SPECIFICATION SUBMITTAL**

Job Name	Job Number
Location	Area Controlled
Model Nos. ELVI-1000: Electronic Low Voltage Interface NGRX-PB-WH: Power Booster; GRX-FDBI-16A-120: Fluorescent Interface	

**Power  
Boosters  
and Interfaces**

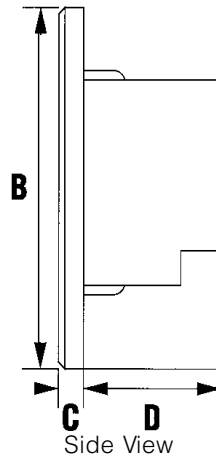
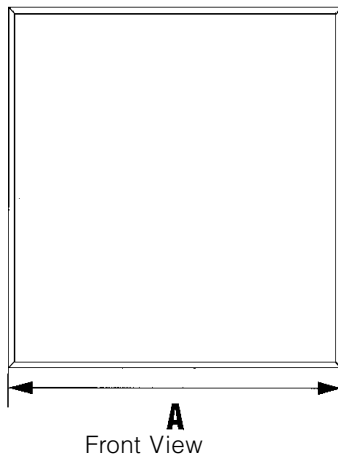

Dimensions

	in	mm
<b>A</b>	4.56	114
<b>B</b>	4.64	116
<b>C</b>	.68	17
<b>D</b>	1.92	48

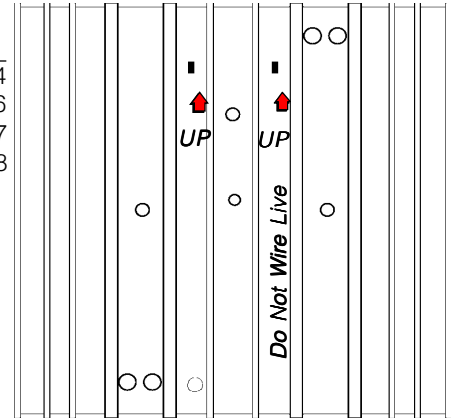

With Faceplate Removed

**► Specifications**

<b>POWER</b>	Operating Voltage: 120VAC 50/60Hz.
<b>TERMINALS</b>	Capacity: ELVI: 4 #12 (2.5 mm <sup>2</sup> ); FDBI: 5 # 12 (2.5 mm <sup>2</sup> ); PB: 4 #12 (2.5mm <sup>2</sup> ).
<b>MOUNTING</b>	(2) 2-gang US wallboxes.
<b>ENVIRONMENTAL</b>	32-104° F (0° - 40°C).
<b>LOAD TYPES/ CAPACITIES</b>	ELVI 1000: Electronic Low Voltage; up to 1000W. NGRX-PB: Incandescent, magnetic low voltage; up to 1920 W/VA GRX-FDBI: Lutron Eco-10™ and Hi-lume® fluorescent ballast; up to 1920 W/VA .
<b>DESIGN</b>	Molded plastic; white

**► Wiring/Mounting**

Turn off power to the control unit and the feed to the Interface. Mount 2-gang wallbox. Strip 1/2 inch (12 mm) insulation from the wallbox wires. Mount as shown in Figure 1. Connect as shown in Figures 2-5.

**► Function**

These interfaces enable HomeWorks local dimmers, switches and Remote Power Modules to operate loads:

- that exceed single zone capacity and use incandescent, magnetic low voltage, neon/cold cathode as light sources (NGRX-PB-WH).

- that use electronic transformer-supplied low voltage lighting (ELVI-1000).

- that use electronic ballasts to either switch the fluorescent lamps on and off or to provide full-range fluorescent dimming when used with Lutron Hi-Lume® ballasts (GRX-FDBI-16A-120).

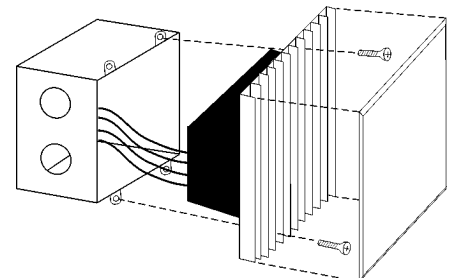

Figure 1. Mounting Diagram

**LUTRON**  
Lutron Electronics Co., Inc.  
7200 Suter Road  
Coopersburg, PA18036, USA  
4/96 P/N 362-813

For additional submittal sheets, call our Hot Line and Fax-on-Demand Service at 1-800-523-9466 or visit Lutron's Website at <http://www.lutron.com/resi>